

ROUTE	SECTION	COUNTY	TOWNSHIP	TOTAL SHEETS	SHEET NUMBER
FAS 1919	06-00144-00-WR	JACKSON	MAKANDA	91	22
			JOB NO. C-99-579-06		PROJECT NO. SR-1919(106)
			BOSKYDELL ROAD		CONTRACT NO. 99338

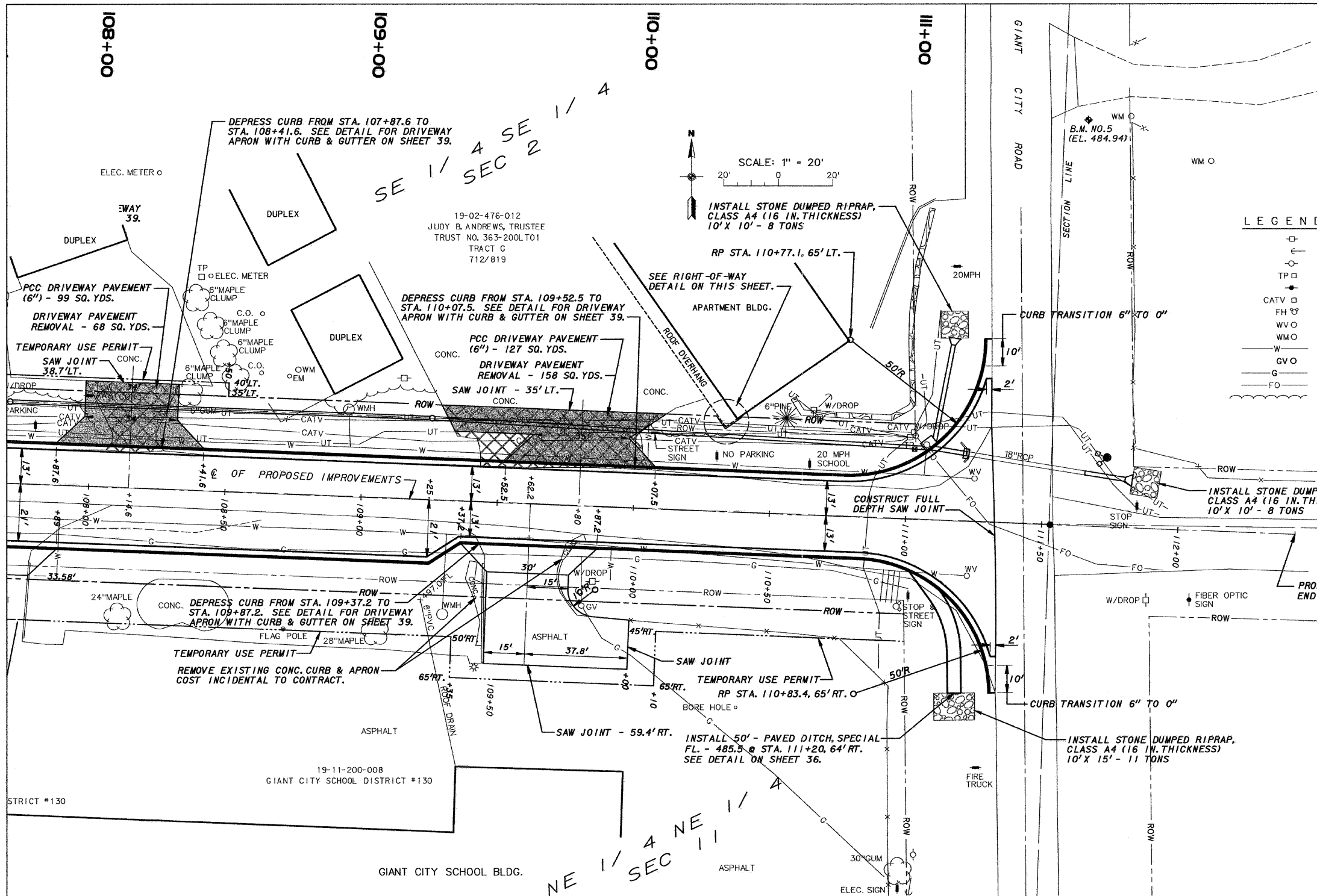

LEGEND

□	POWER POLE	—x—x—	FENCE LINE
○	POLE ANCHOR	—PL—	PROPERTY LINE
○	TELEPHONE POLE	—ROW—	EXISTING RIGHT-OF-WAY LINE
TP □	TELEPHONE PEDESTAL	—PROPOSED ROW—	PROPOSED RIGHT-OF-WAY LINE
●	TELEPHONE WARNING SIGN	—PT—	PROPOSED TEMPORARY USE PERMIT
CATV □	CABLE TELEVISION PEDESTAL	●	SURVEY MONUMENTS (FOUND)
FH □	FIRE HYDRANT	○	EXISTING RIGHT-OF-WAY MARKER
WVO	WATER VALVE	—	SIGN
WMO	WATER METER	MB ●	MALBOX
W	WATER LINE	RCP	REINFORCED CONCRETE PIPE CULVERT
GV	GAS VALVE	CMP	CORRUGATED METAL PIPE CULVERT
G	GAS LINE	TC	TOP OF CASTING / TOP OF CURB
FO	FIBER OPTIC LINE	INV.	INVERT
—	TREE/BRUSH LINE	FL	FLOWLINE

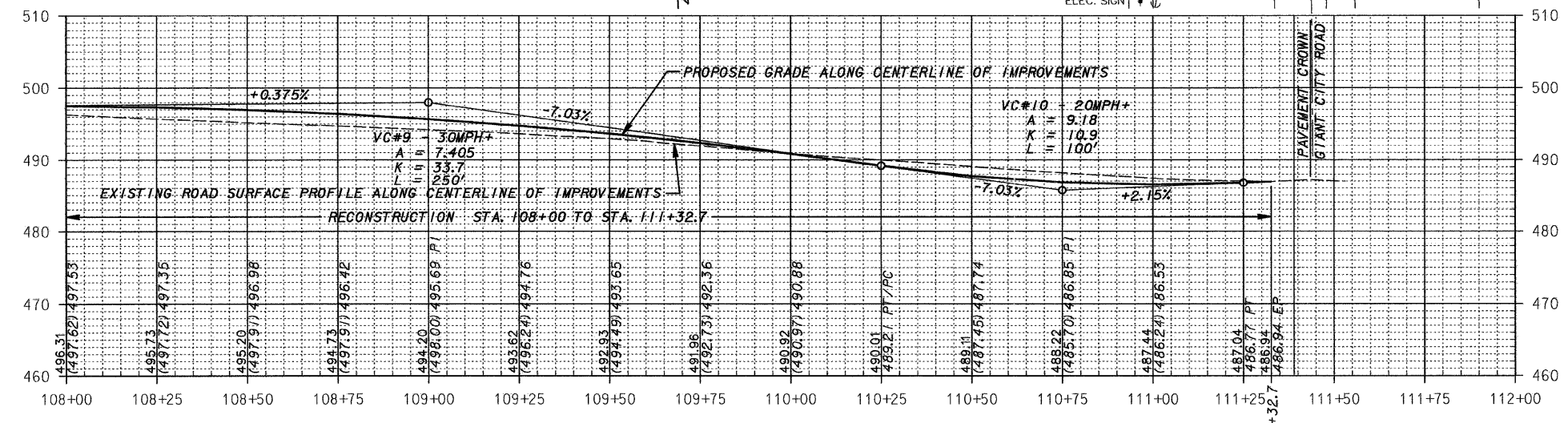
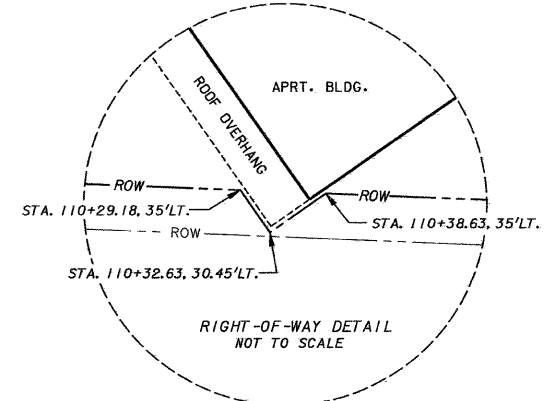

- NOTES**
1. THE EXISTENCE, POSITION, SIZE AND TYPE OF ALL UNDERGROUND UTILITIES ARE APPROXIMATE AS SHOWN, BEING LOCATED BY ELECTRONIC DETECTION EQUIPMENT, BY VISUAL OBSERVATION, FROM UTILITY COMPANY MAPS AND BY VERBAL TESTIMONY OF EMPLOYEES FROM APPROPRIATE UTILITY COMPANY. VERIFICATION OF THE EXISTENCE, POSITION, SIZE AND TYPE SHOULD BE REQUESTED THROUGH "JULIE", 1-800-892-0126 PRIOR TO ANY CONSTRUCTION.
 2. ALL PHYSICAL FEATURES DEPICTED BY THIS SURVEY WERE CONDITIONS AS OF OCTOBER, 2006.