

ROUTE	SECTION	COUNTY	TOWNSHIP	TOTAL SHEETS	SHEET NUMBER
FAS 1919	06-00144-00-WR	JACKSON	MAKANDA	91	40
JOB NO. C-99-579-06			PROJECT NO. SR-1919(106)		
BOSKYDELL ROAD			CONTRACT NO. 98338		

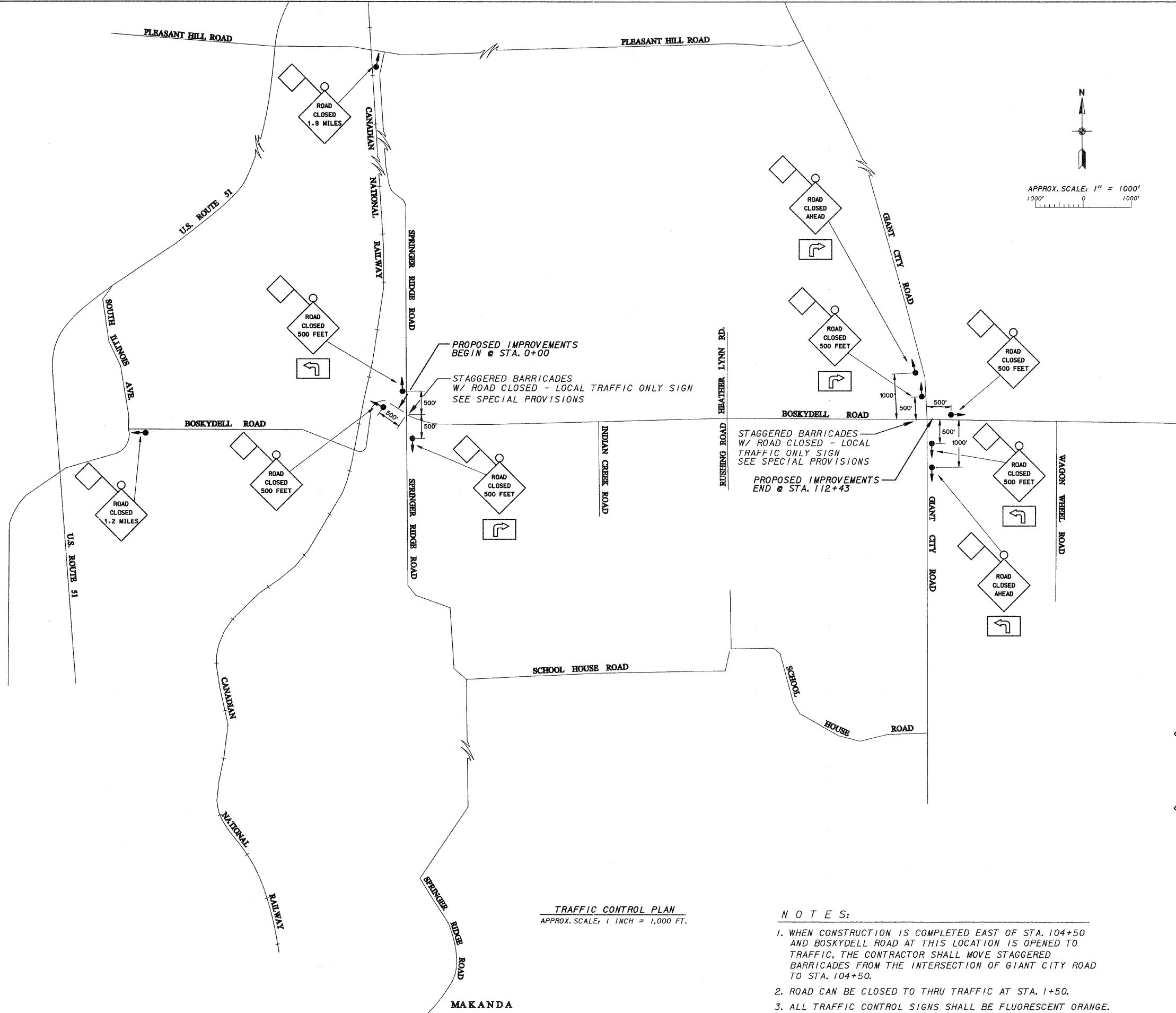

**TRAFFIC CONTROL PLAN**  
APPROX. SCALE: 1 INCH = 1,000 FT.

**NOTES:**

1. WHEN CONSTRUCTION IS COMPLETED EAST OF STA. 104+50 AND BOSKYDELL ROAD AT THIS LOCATION IS OPENED TO TRAFFIC, THE CONTRACTOR SHALL MOVE STAGGERED BARRICADES FROM THE INTERSECTION OF GIANT CITY ROAD TO STA. 104+50.
2. ROAD CAN BE CLOSED TO THRU TRAFFIC AT STA. 1+50.
3. ALL TRAFFIC CONTROL SIGNS SHALL BE FLUORESCENT ORANGE.
4. ALL TRAFFIC CONTROL SIGNS, BARRICADES, BARRELS, ETC. SHALL BE EQUIPPED WITH FLASHING WARNING LIGHTS.

**LEGEND - TRAFFIC CONTROL SIGNAGE**

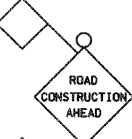
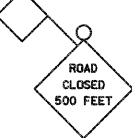
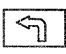
-  - W20-1 (TYP.) 48"X48"
-  - W20-1 (TYP.) 48"X48"
-  - W16-6P (TYP.) 30"X18"