

EXISTING TYPICAL CROSS SECTION
STA. 54+00 TO 71+77

- LEGEND:**
- ① EXISTING P.C.C. PAVEMENT ±8"
 - ② EXISTING HOT-MIX ASPHALT SURFACE, ±4"
 - ③ EXISTING LANDSCAPE MEDIAN
 - ④ EXISTING COMBINATION CONCRETE CURB & GUTTER, TYPE B-6.12
 - ⑤ EXISTING COMBINATION CONCRETE CURB & GUTTER, TYPE B-6.24
 - ⑥ EXISTING P.C.C. SIDEWALK
 - ⑦ EXISTING STABILIZED SUB-BASE
 - ⑧ PROPOSED HOT-MIX ASPHALT SURFACE REMOVAL, 2 1/2"
 - ⑨ PROPOSED POLYMERIZED LEVELING BINDER (MACHINE METHOD), IL-4.75, N50, 3"
 - ⑩ PROPOSED POLYMERIZED HOT-MIX ASPHALT SURFACE COURSE, MIX "E", N70, 1 1/2"
- R CURB AND GUTTER REMOVAL AND REPLACEMENT
(AS DIRECTED BY THE ENGINEER)

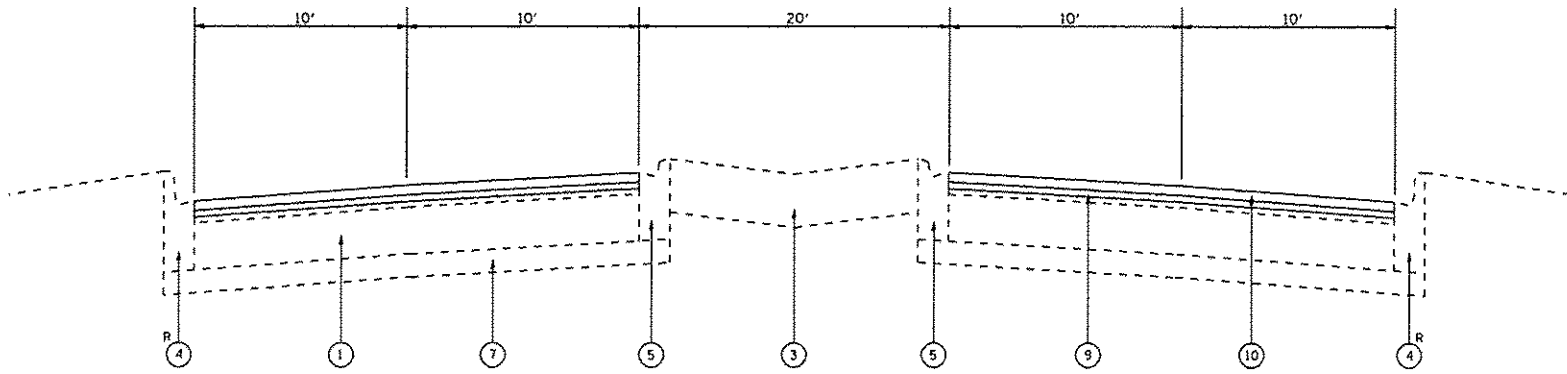

PROPOSED TYPICAL CROSS SECTION
STA. 54+00 TO 71+77

MIXTURE REQUIREMENTS

MIXTURE TYPE	AIR VOIDS @ Ndes	OMP
PATCHING		
CLASS "D" PATCHES (HMA BINDER COURSE, IL-19MM)	4% @ 70 GYR.	OC / OA
PAVEMENT RESURFACING		
POLYMERIZED HOT-MIX ASPHALT SURFACE COURSE, MIX "E", N70 (IL 9.5MM)	4% @ 70 GYR.	OCP
POLYMERIZED LEVELING BINDER (MACHINE METHOD, IL-4.75, N50)	3.5% @ 50 GYR.	OC / OA
DRIVEWAYS (PRIVATE ENTRANCE)		
HOT-MIX ASPHALT BASE COURSE, 6" (HMA BINDER IL-19MM)	4% @ 50 GYR.	OCP
HOT-MIX ASPHALT SURFACE COURSE, MIX "D", N50, 2" (IL-9.5MM)	4% @ 50 GYR.	OCP
OMP DESIGNATION: QUALITY CONTROL FOR PERFORMANCE (OCP); QUALITY CONTROL / QUALITY ASSURANCE (OC / OA); PAY FOR PERFORMANCE (PFP)		

- NOTES:**
- THE UNIT WEIGHT USED TO CALCULATE ALL HOT-MIX ASPHALT QUANTITIES IS 112 LBS./SO. YD./ IN.
 - THE "AC TYPE" FOR POLYMERIZED HMA MIXES SHALL BE "SBS/SBR PG 76 -22" AND FOR NON-POLYMERIZED HMA THE "AC TYPE" SHALL BE "PG 64 -22" UNLESS MODIFIED BY DISTRICT ONE SPECIAL PROVISIONS.
 - THE PATCHING SHALL BE DONE PRIOR TO THE MILLING
 - QUALITY MANAGEMENT PROGRAM (OMP) IDENTIFIES THE PARTICULAR QUALITY CONTROL SPECIFICATION THAT APPLIES TO THE HMA MIXTURE
 - FOR USE OF RECYCLED MATERIALS SEE SPECIAL PROVISIONS

Rev 1-04-17

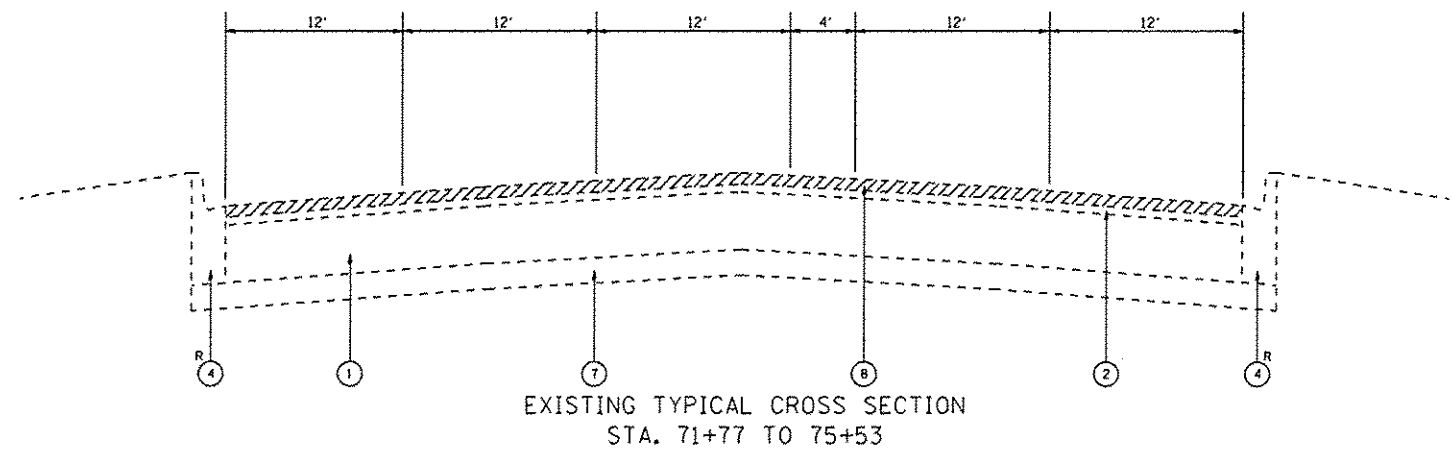

EXISTING TYPICAL CROSS SECTION
STA. 71+77 TO 75+53

- LEGEND:**
- ① EXISTING P.C.C. PAVEMENT ±8"
 - ② EXISTING HOT-MIX ASPHALT SURFACE, ±4"
 - ③ EXISTING LANDSCAPE MEDIAN
 - ④ EXISTING COMBINATION CONCRETE CURB & GUTTER, TYPE B-6.12
 - ⑤ EXISTING COMBINATION CONCRETE CURB & GUTTER, TYPE B-6.24
 - ⑥ EXISTING P.C.C. SIDEWALK
 - ⑦ EXISTING STABILIZED SUB-BASE
 - ⑧ PROPOSED HOT-MIX ASPHALT SURFACE REMOVAL, 2½"
 - ⑨ PROPOSED POLYMERIZED LEVELING BINDER (MACHINE METHOD), 1L-4.75, N50, ¾"
 - ⑩ PROPOSED POLYMERIZED HOT-MIX ASPHALT SURFACE COURSE, MIX "E", N70, 1¾"
- R CURB AND GUTTER REMOVAL AND REPLACEMENT
(AS DIRECTED BY THE ENGINEER)

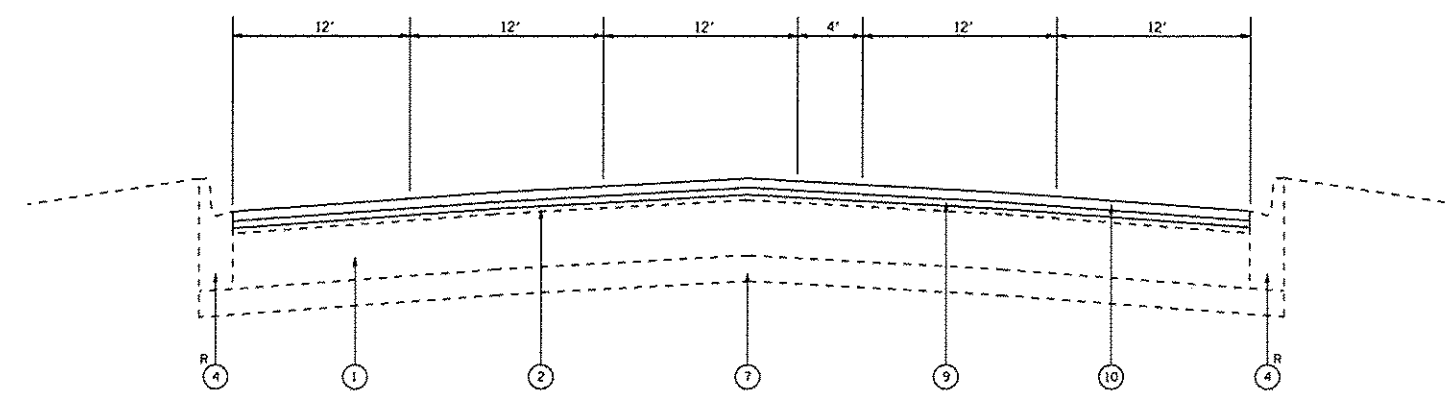

PROPOSED TYPICAL CROSS SECTION
STA. 71+77 TO 75+53

△ Rev 1-04-17

FILE NAME :	USER NAME : STEEDPA	DESIGNED -	REVISED -	STATE OF ILLINOIS DEPARTMENT OF TRANSPORTATION	EXISTING AND PROPOSED TYPICAL SECTIONS FAU 2692 (WOLF RD.)—US 12 (RAND RD.) TO IL 58 (GOLF RD.)			F.A.U. RTE.	SECTION	COUNTY	TOTAL SHEETS	SHEET NO.
Default	Default	Default	Default					2692	3539 RS-1	COOK	28	7
	PLOT SCALE = 100.0000' / 1"	CHECKED -	REVISED -		SCALE:	SHEET	OF	SHEETS	STA.	TO STA.	ILLINOIS FED. AID PROJECT CONTRACT NO. 62A73	
	PLOT DATE = 12/23/2016	DATE -	REVISED -									

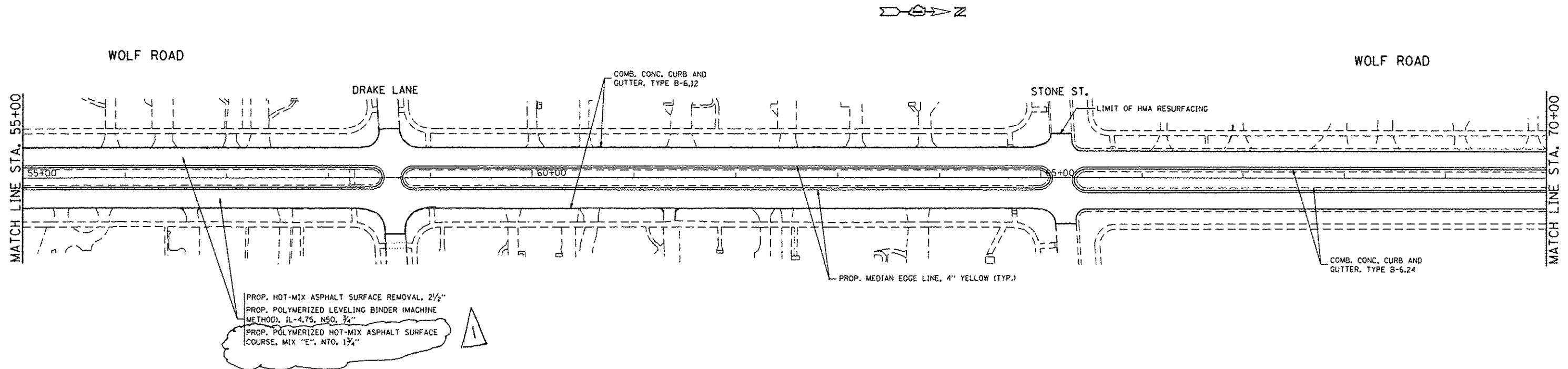

PROP. HOT-MIX ASPHALT SURFACE REMOVAL, 2 1/2"
 PROP. POLYMERIZED LEVELING BINDER (MACHINE METHOD), IL-4.75, NSO, 3/4"
 PROP. POLYMERIZED HOT-MIX ASPHALT SURFACE COURSE, MIX "E", NTO, 1 3/4"

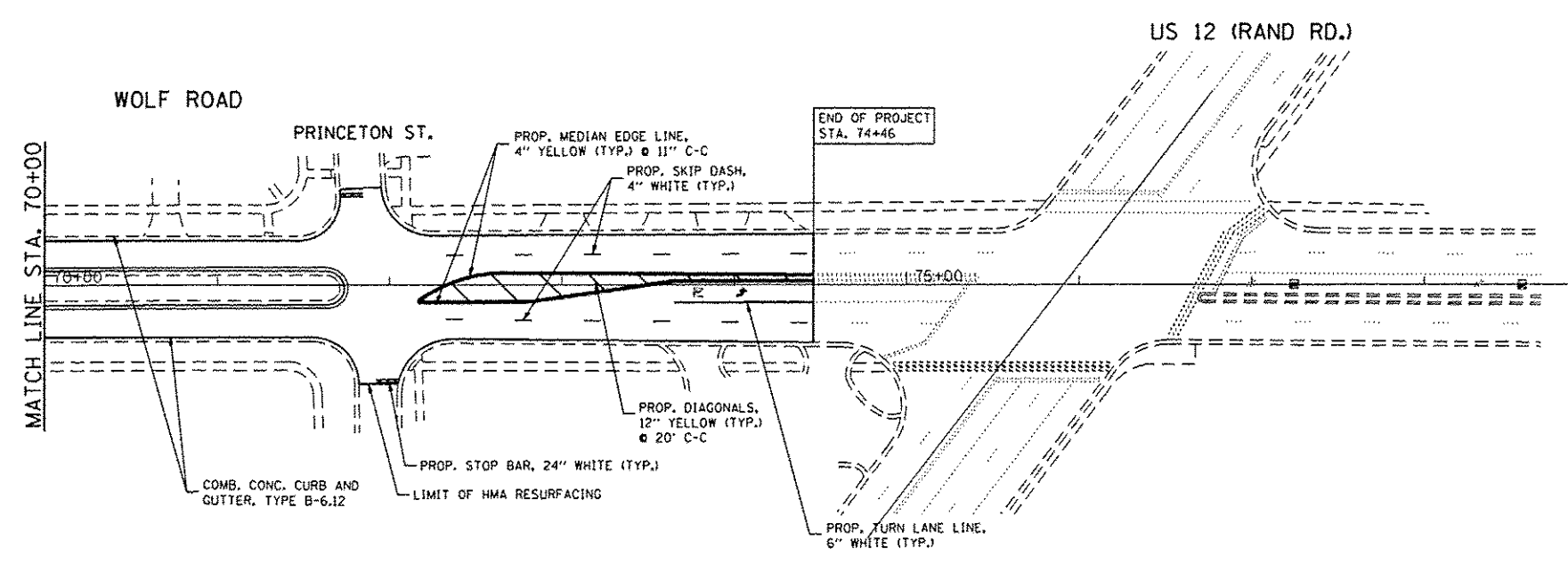

△ Rev 1-04-17

FILE NAME : p:\11\B4EBID\INTEG\Illinois.gov\PWIDOT\Documents\IDOT Offices\District 1\Projects\0130\DRAWING\Design\120315\ht-plan.dgn	USER NAME = STEEDPA	DESIGNED -	REVISED -	STATE OF ILLINOIS DEPARTMENT OF TRANSPORTATION	ROADWAY AND PAVEMENT MARKING PLAN FAU 2692 (WOLF RD.)—US 12 (RAND RD.) TO IL 58 (GOLF RD.)	F.A.U. RTE. 2692	SECTION 3539 RS-1	COUNTY COOK	TOTAL SHEETS 28	SHEET NO. 9
	PLOT SCALE = 100,0000' / in.	CHECKED -	REVISED -			SCALE:	SHEET OF SHEETS	STA. TO STA.	ILLINOIS FED. AID PROJECT CONTRACT NO. 62A73	
Default	PLOT DATE = 12/23/2016	DATE -	REVISED -							