

BY: _____ DATE: _____
 SURVEYED _____
 PLOTTED _____
 TEMPLATE _____
 NOTE BOOK _____
 AREAS CHECKED _____

BY: _____ DATE: _____
 SURVEYED _____
 PLOTTED _____
 TEMPLATE _____
 NOTE BOOK _____
 AREAS CHECKED _____

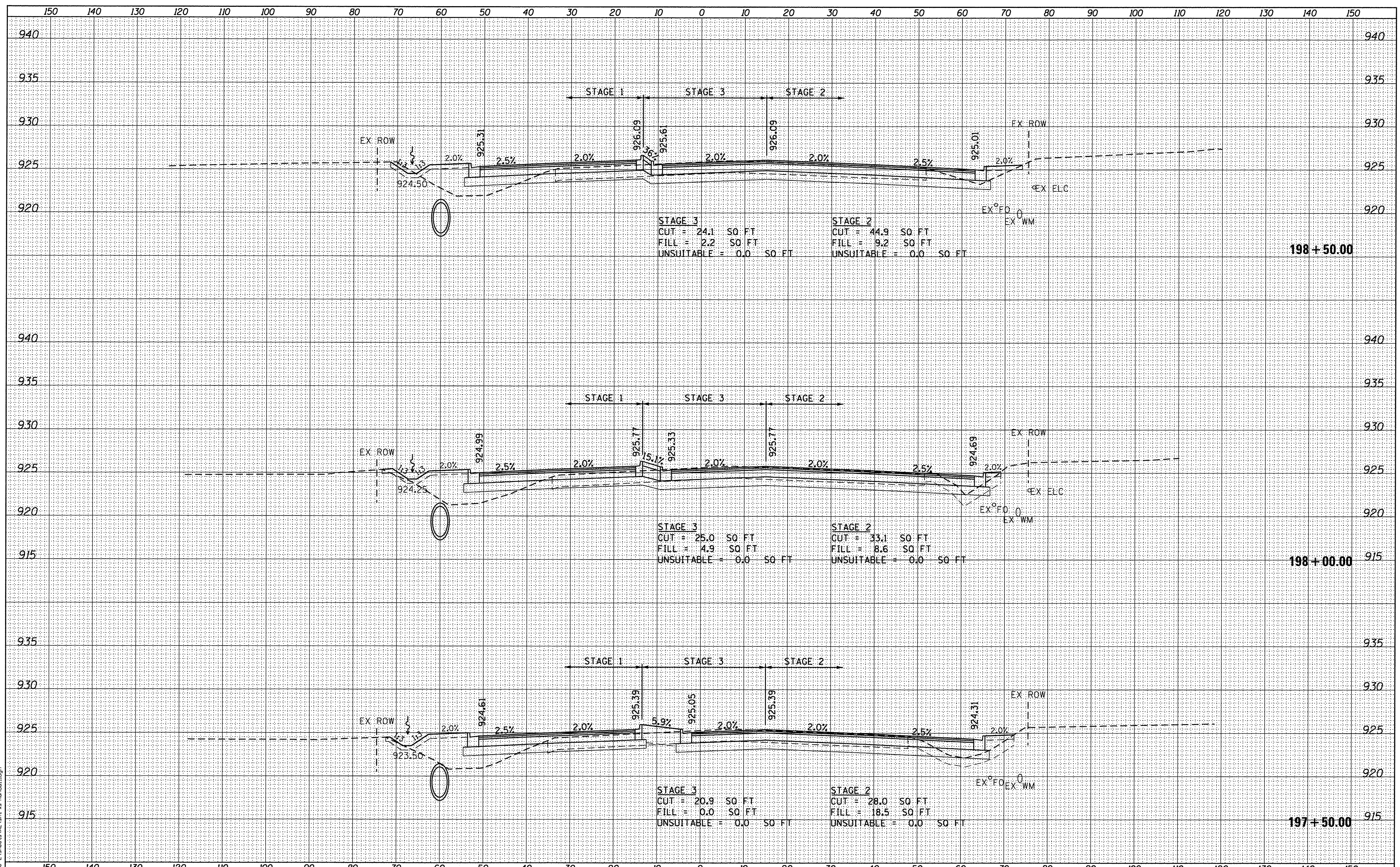

USER NAME = HLR Power-GEOPAK	DESIGNED - RO	REVISED -
PLOT SCALE = 10.0000 "/td> <td>DRAWN - JBH</td> <td>REVISED -</td>	DRAWN - JBH	REVISED -
PLOT DATE = 10/26/2016	CHECKED - BLP	REVISED -
	DATE - 10/25/2016	REVISED -

**STATE OF ILLINOIS
DEPARTMENT OF TRANSPORTATION**

**CROSS SECTIONS
RANDALL ROAD**

SCALE: _____ SHEET _____ OF _____ SHEETS STA. 197+50.00 TO STA. 198+50.00

F.A.U. RTE.	SECTION	COUNTY	TOTAL SHEETS	SHEET NO.
2298	13-00215-10-PV	KANE	477	458
CONTRACT NO. 61C41				
ILLINOIS FED. AID PROJECT				

BY	DATE
SURVEYED	
PLOTTED	
TEMPLATE	
AREAS	
CHECKED	
FINAL SURVEY	
NOTE BOOK	
NO.	

BY	DATE
SURVEYED	
PLOTTED	
TEMPLATE	
AREAS	
CHECKED	
ORIGINAL SURVEY	
NOTE BOOK	
NO.	

M:\05. CAD\Drawings\2\Drawings\A2\Print\ss-Randall.dwg

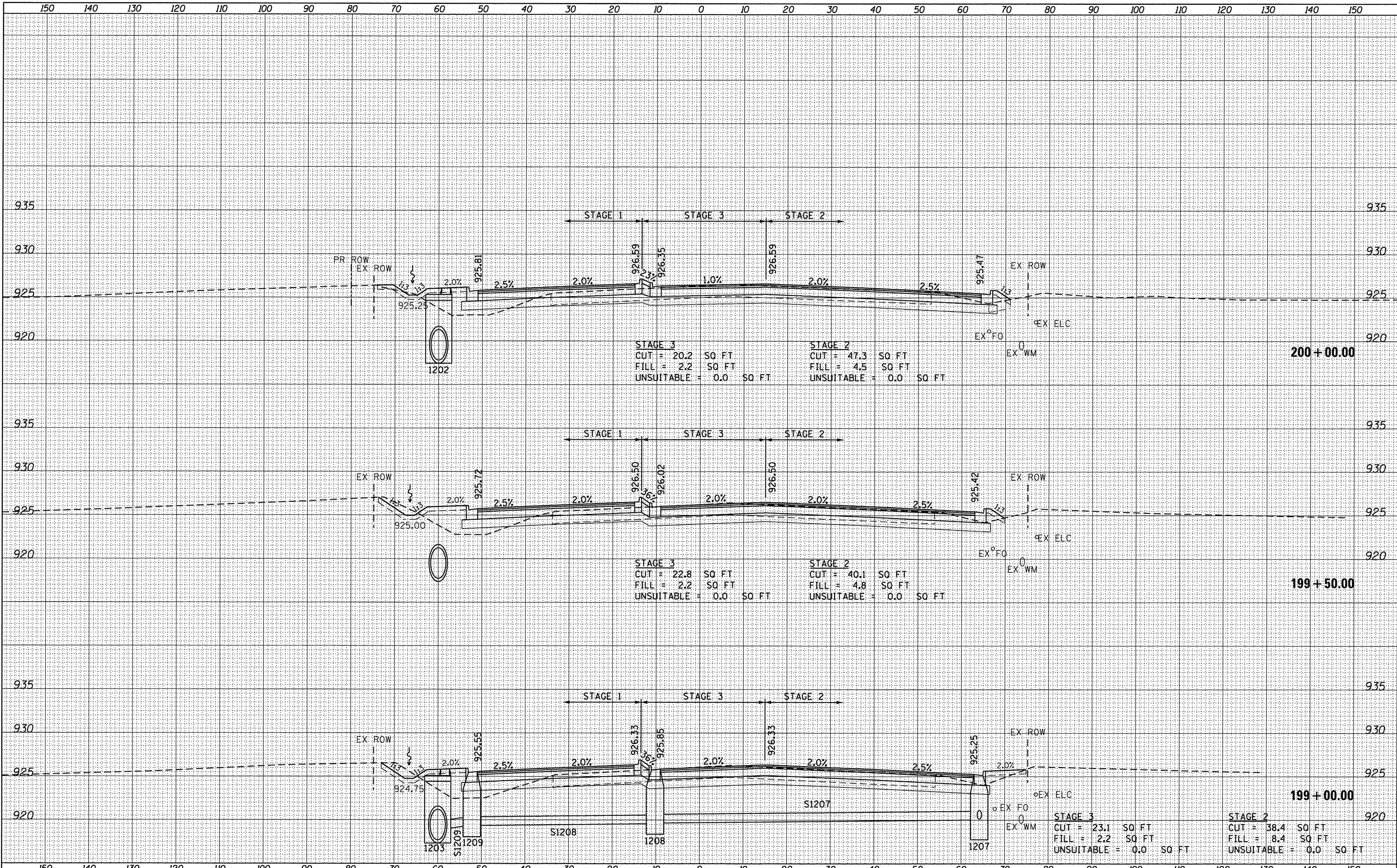

USER NAME = HLR PowerGEOPAK
 PLOT SCALE = 10,0000' / in.
 PLOT DATE = 10/26/2016

DESIGNED - RO
 DRAWN - JBH
 CHECKED - BLP
 DATE - 10/25/2016

REVISED -
 REVISED -
 REVISED -
 REVISED -

**STATE OF ILLINOIS
 DEPARTMENT OF TRANSPORTATION**

**CROSS SECTIONS
 RANDALL ROAD**

SCALE: SHEET OF SHEETS STA. 199+00.00 TO STA. 200+00.00

F.A.U. RTE.	SECTION	COUNTY	TOTAL SHEETS	SHEET NO.
2298	13-00215-10-PV	KANE	477	459
CONTRACT NO. 61C41			ILLINOIS FED. AID PROJECT	

DATE	
BY	
FINAL SURVEY	
SURVEYED	
PLOTTED	
TEMPLATE	
AREAS	
CHECKED	
NO.	

DATE	
BY	
ORIGINAL SURVEY	
SURVEYED	
PLOTTED	
TEMPLATE	
AREAS	
CHECKED	
NO.	

W:\05_CADD\chase_2\sheets\A2\vt\ss-Randall.dgn

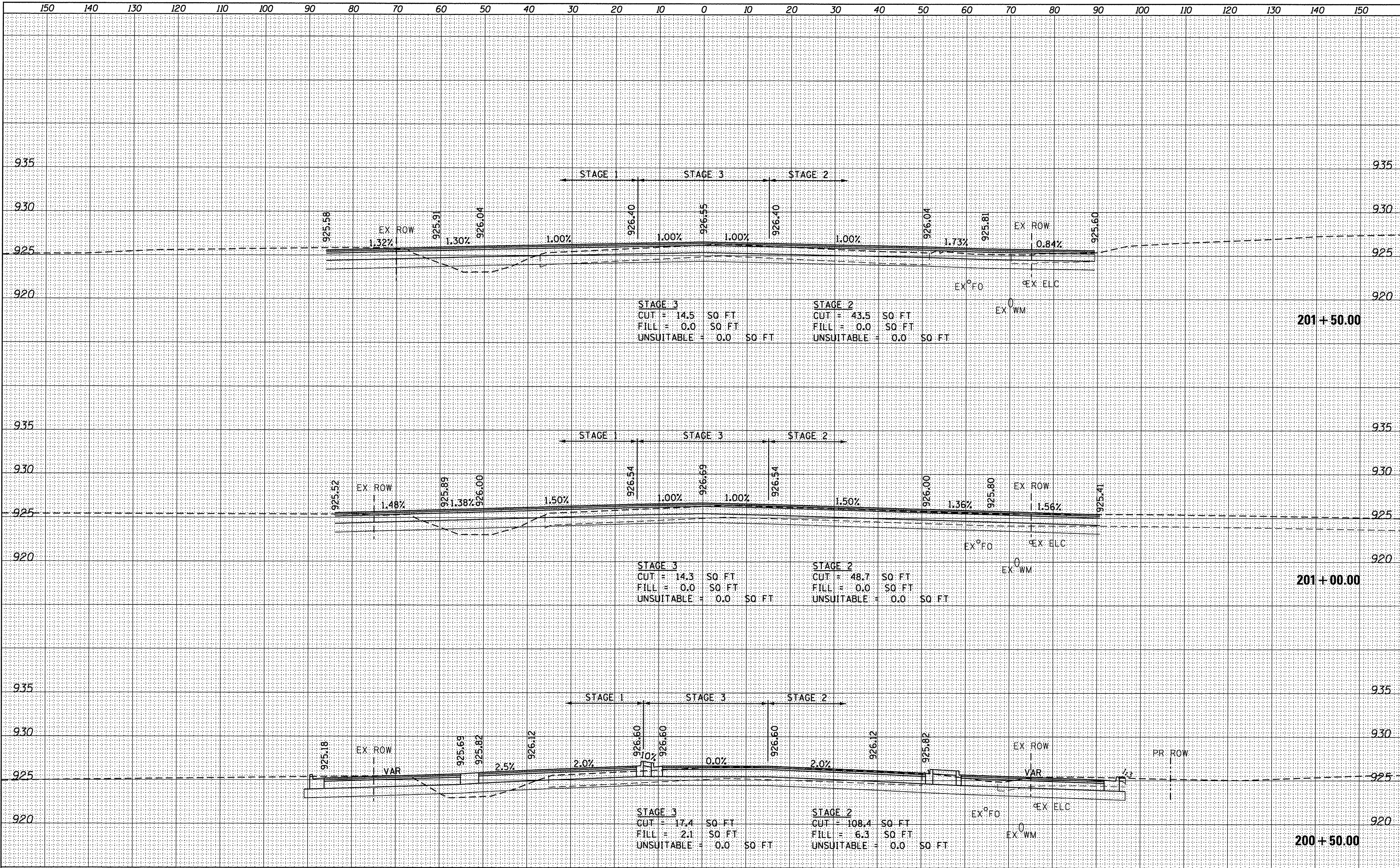

USER NAME = HLR PowerGEOPAK
 PLOT SCALE = 10,0000' / in.
 PLOT DATE = 10/26/2016

DESIGNED - RO	REVISED -
DRAWN - JBH	REVISED -
CHECKED - BLP	REVISED -
DATE - 10/25/2016	REVISED -

STATE OF ILLINOIS
 DEPARTMENT OF TRANSPORTATION

CROSS SECTIONS
 RANDALL ROAD

SCALE: SHEET OF SHEETS STA. 200+50.00 TO STA. 201+50.00

F.A.U. RTE.	SECTION	COUNTY	TOTAL SHEETS	SHEET NO.
2298	13-00215-10-PV	KANE	477	460
			CONTRACT NO. 61C41	
ILLINOIS FED. AID PROJECT				

DATE	
BY	
SURVEYED	
PLOTTED	
TEMPLATE	
AREAS CHECKED	
FINAL SURVEY	
NOTE BOOK	
NO.	

DATE	
BY	
SURVEYED	
PLOTTED	
TEMPLATE	
AREAS CHECKED	
ORIGINAL SURVEY	
NOTE BOOK	
NO.	

M:\05_CADD\phase 2\sheets\A2\ht-vs-Randall.dgn

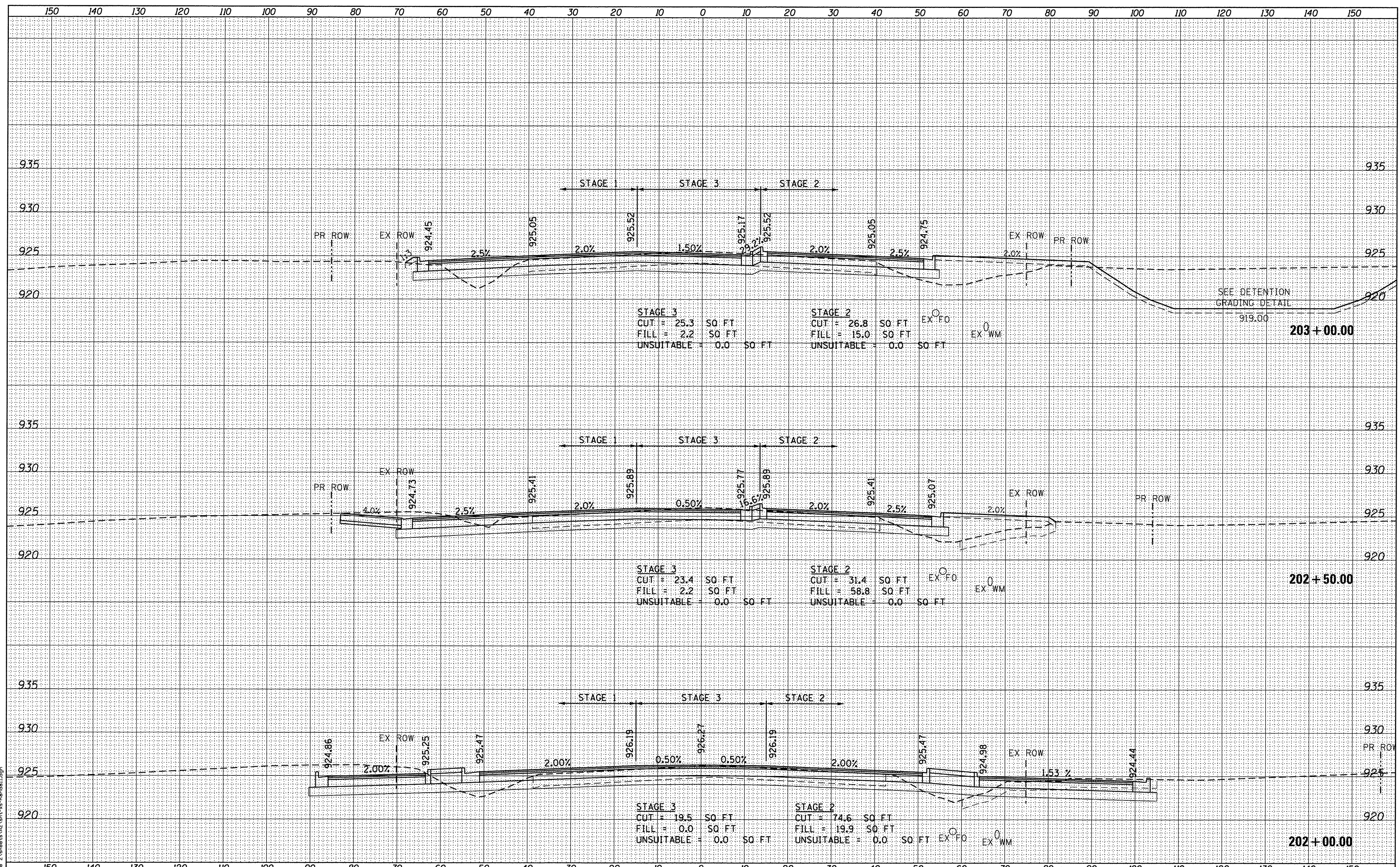

STATE OF ILLINOIS
DEPARTMENT OF TRANSPORTATION

CROSS SECTIONS
RANDALL ROAD

USER NAME = HLR PowerGEOPAK
PLOT SCALE = 10.0000" / in.
PLOT DATE = 10/26/2016

DESIGNED - RO
DRAWN - JBH
CHECKED - BLP
DATE - 10/25/2016

REVISED -
REVISED -
REVISED -
REVISED -

SCALE: SHEET OF SHEETS STA. 202+00.00 TO STA. 203+00.00

F.A.U. RTE.	SECTION	COUNTY	TOTAL SHEETS	SHEET NO.
2298	13-00215-10-PV	KANE	477	461
			CONTRACT NO. 61C41	
ILLINOIS FED. AID PROJECT				



DATE	
BY	
FINAL SURVEY	
SURVEYED	
PLOTTED	
TEMPLATE	
NOTE BOOK	
AREAS CHECKED	
NO.	

DATE	
BY	
ORIGINAL SURVEY	
SURVEYED	
PLOTTED	
TEMPLATE	
NOTE BOOK	
AREAS CHECKED	
NO.	

W:\MS_CADD\phase 2\sheets\A2\st-ss-Randall.dgn



USER NAME = HLR Power-GEDPAK	DESIGNED - RO	REVISED -
PLOT SCALE = 10,0000' / 1"	DRAWN - JBH	REVISED -
PLOT DATE = 10/26/2016	CHECKED - BLP	REVISED -
	DATE - 10/25/2016	REVISED -

**STATE OF ILLINOIS
DEPARTMENT OF TRANSPORTATION**

**CROSS SECTIONS
RANDALL ROAD**

SCALE: SHEET OF SHEETS STA. 203+50.00 TO STA. 204+50.00

F.A.U. RTE.	SECTION	COUNTY	TOTAL SHEETS	SHEET NO.
2298	13-00215-10-PV	KANE	477	462
			CONTRACT NO. 61C41	
ILLINOIS FED. AID PROJECT				

DATE	
BY	
FINAL SURVEY	
SURVEYED	
PLOTTED	
TEMPLATE	
NOTE BOOK	
AREAS CHECKED	
NO.	

DATE	
BY	
ORIGINAL SURVEY	
SURVEYED	
PLOTTED	
TEMPLATE	
NOTE BOOK	
AREAS CHECKED	
NO.	

W:\05_CADD\phase 2\sheet\A2\int-as-Randall.dwg

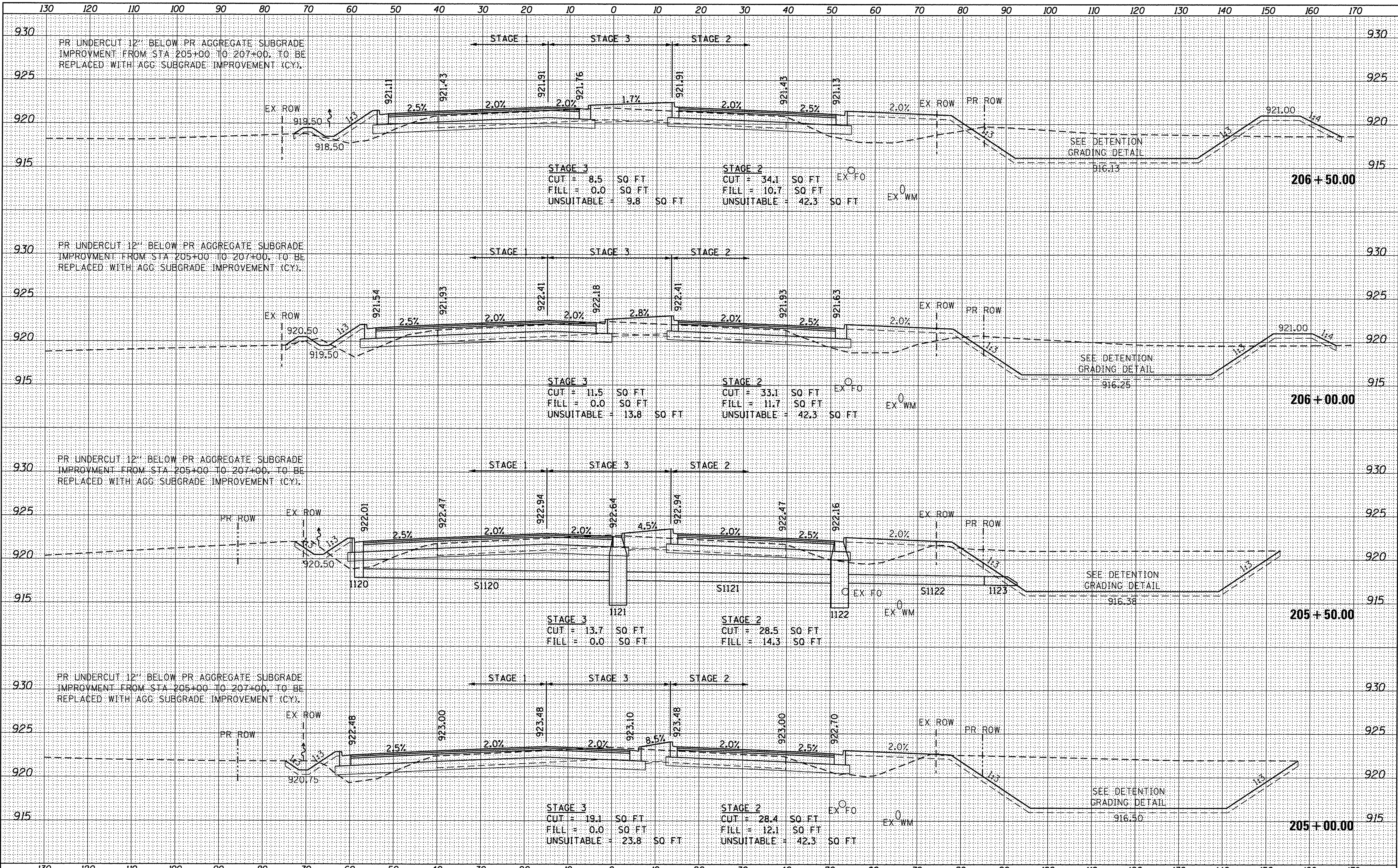

STATE OF ILLINOIS
DEPARTMENT OF TRANSPORTATION

CROSS SECTIONS
RANDALL ROAD

USER NAME = HLR Power-GEOPAK
DESIGNED - RO
DRAWN - JBH
CHECKED - BLP
DATE - 10/25/2016

REVISOR -
REVISOR -
REVISOR -
REVISOR -

SCALE: SHEET OF SHEETS STA. 205+00.00 TO STA. 206+50.00

F.A.U. RTE.	SECTION	COUNTY	TOTAL SHEETS	SHEET NO.
2298	13-00215-10-PV	KANE	477	463
			CONTRACT NO. 61C41	
ILLINOIS FED. AID PROJECT				

DATE	
BY	
SURVEYED	
PLOTTED	
TEMPLATE	
AREAS CHECKED	
FINAL SURVEY	
NOTE BOOK	
NO.	

DATE	
BY	
SURVEYED	
PLOTTED	
TEMPLATE	
AREAS CHECKED	
ORIGINAL SURVEY	
NOTE BOOK	
NO.	

\\s05.cad\p\phase 2\sheets\A2\pht-ss-Randall.dgn

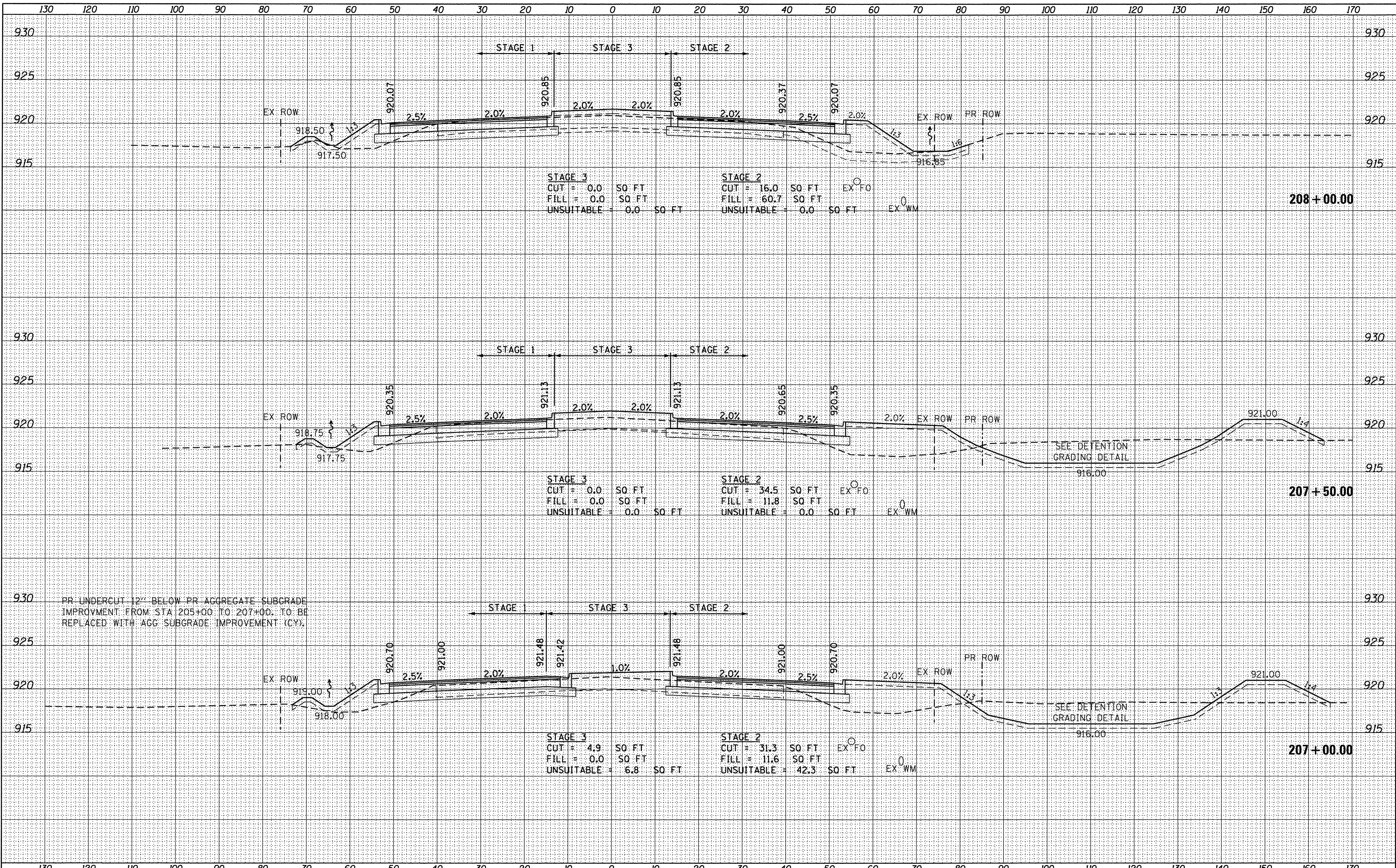

PR UNDERCUT 12" BELOW PR AGGREGATE SUBGRADE IMPROVEMENT FROM STA 205+00 TO 207+00. TO BE REPLACED WITH AGG SUBGRADE IMPROVEMENT (CY).

SEE DETENTION GRADING DETAIL

SEE DETENTION GRADING DETAIL



USER NAME = HLR PowerGEOPAK
 DESIGNED - RO
 DRAWN - JBH
 CHECKED - BLP
 DATE - 10/25/2016

REVISER -
 REVISED -
 REVISED -
 REVISED -

STATE OF ILLINOIS
 DEPARTMENT OF TRANSPORTATION

CROSS SECTIONS
 RANDALL ROAD

SCALE: SHEET OF SHEETS STA. 207+00.00 TO STA. 208+00.00

F.A.U. RTE.	SECTION	COUNTY	TOTAL SHEETS	SHEET NO.
2298	13-00215-10-PV	KANE	477	464
				CONTRACT NO. 61C41
ILLINOIS FED. AID PROJECT				

DATE	
BY	
SURVEYED	
PLOTTED	
TEMPLATE	
AREAS	
CHECKED	
FINAL SURVEY	
NOTE BOOK	
NO.	

DATE	
BY	
SURVEYED	
PLOTTED	
TEMPLATE	
AREAS	
CHECKED	
ORIGINAL SURVEY	
NOTE BOOK	
NO.	

W:\05_CADD\phase 2\Sheets\A2_pvt-ss-Randall.dgn

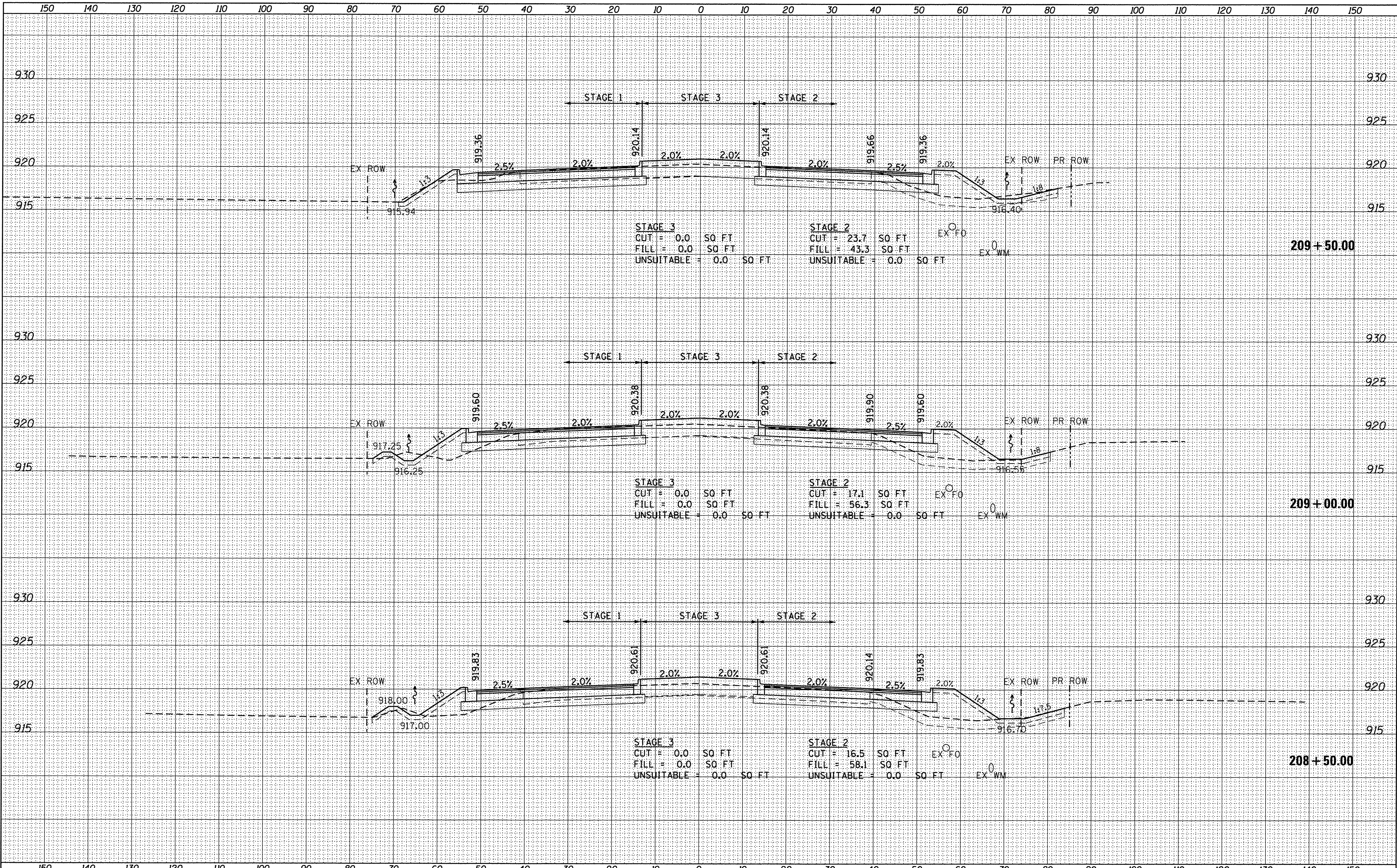

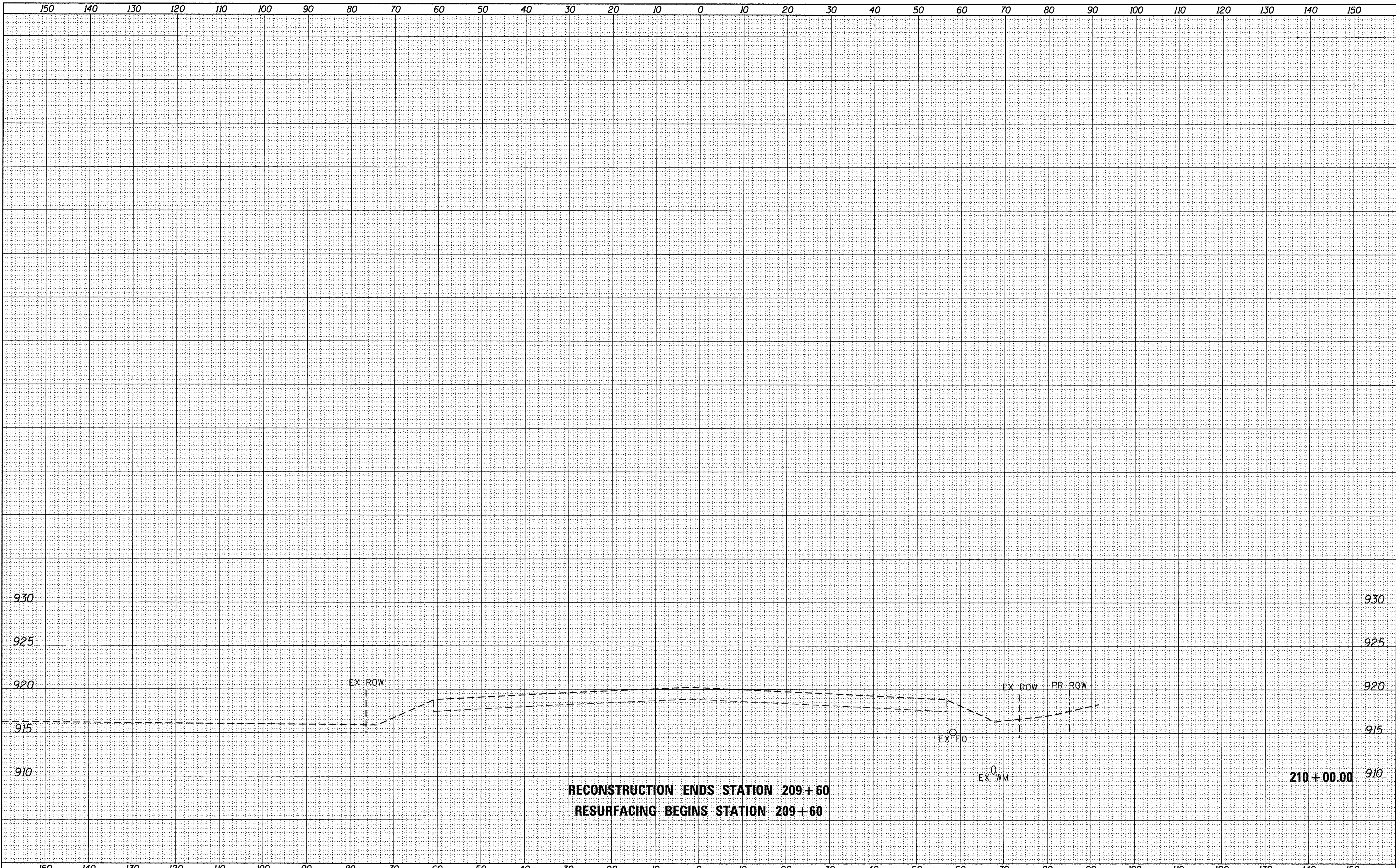

RECONSTRUCTION ENDS STATION 209+60
RESURFACING BEGINS STATION 209+60

210+00.00

FINAL SURVEY	SURVEYED	BY	DATE
NOTE BOOK	PLOTTED		
NO.	TEMPLATE		
	AREAS CHECKED		
	AREAS CHECKED		

ORIGINAL SURVEY	SURVEYED	BY	DATE
NOTE BOOK	PLOTTED		
NO.	TEMPLATE		
	AREAS CHECKED		
	AREAS CHECKED		



USER NAME = HLR PowerGEOPAK	DESIGNED - RO	REVISED -
PLOT SCALE = 10.0000' / in.	DRAWN - JBH	REVISED -
PLOT DATE = 10/26/2016	CHECKED - BLP	REVISED -
	DATE - 10/25/2016	REVISED -

STATE OF ILLINOIS
DEPARTMENT OF TRANSPORTATION

CROSS SECTIONS	
RANDALL ROAD	
SCALE:	SHEET OF SHEETS
STA. 210+00.00 TO STA. 211+00.00	

F.A.U. RTE.	SECTION	COUNTY	TOTAL SHEETS	SHEET NO.
2298	13-00215-10-PV	KANE	477	466
ILLINOIS FED. AID PROJECT			CONTRACT NO. 61C41	

FINAL SURVEY	SURVEYED	DATE
NOTE BOOK	PLOTTED	
NO.	TEMPLATE	
	AREAS	
	CHECKED	

ORIGINAL SURVEY	SURVEYED	DATE
NOTE BOOK	PLOTTED	
NO.	TEMPLATE	
	AREAS	
	CHECKED	

FILE NAME = G:\CH13\01095\Road\Sheets\20131894-SHT-XS-SLEEPY.dgn

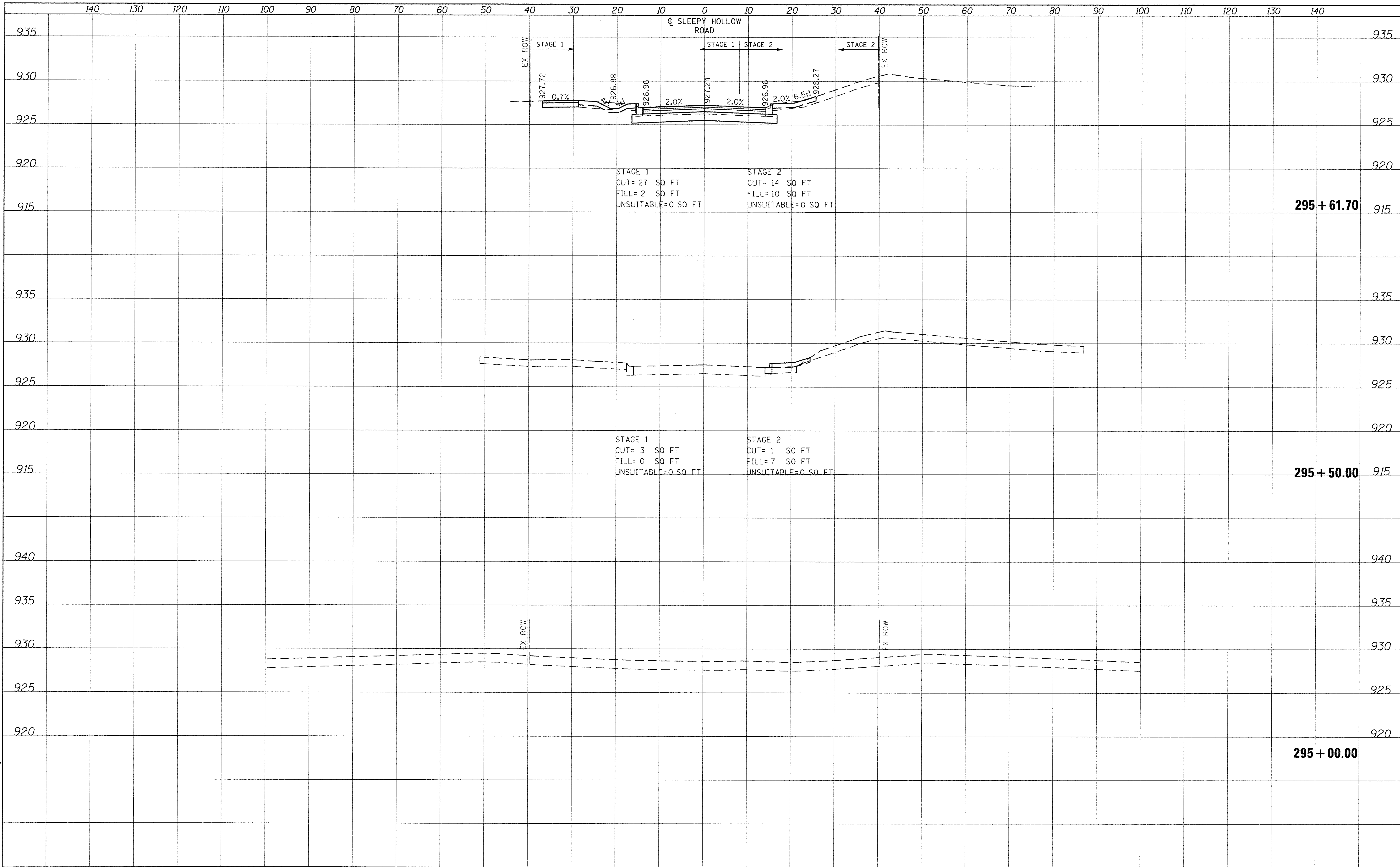

USER NAME = bshaeftiger	DESIGNED - BSH	REVISED -
PLOT SCALE = 10,000' / 1"	DRAWN - MLB	REVISED -
PLOT DATE = 10/26/2016	CHECKED - MFD	REVISED -
	DATE - 10/28/2016	REVISED -

**STATE OF ILLINOIS
DEPARTMENT OF TRANSPORTATION**

**CROSS SECTIONS
SLEEPY HOLLOW ROAD**

SCALE: 10H : 5V SHEET 467 OF 477 SHEETS STA. 295+00.00 TO STA. 295+61.70

F.A.P. RTE.	SECTION	COUNTY	TOTAL SHEETS	SHEET NO.
0361	13-00215-10-PV	KANE	477	467
FED. ROAD DIST. NO. 1 ILLINOIS FED. AID PROJECT			CONTRACT NO. 61C41	

DATE	
BY	
SURVEYED	
PLOTTED	
TEMPLATE	
AREAS	
CHECKED	
FINAL SURVEY	
NOTE BOOK	
NO.	

DATE	
BY	
SURVEYED	
PLOTTED	
TEMPLATE	
AREAS	
CHECKED	
ORIGINAL SURVEY	
NOTE BOOK	
NO.	

FILE NAME = G:\CH13\0109\Road\Sheets\2013\1894-SHT-15-SLEEPY.dgn

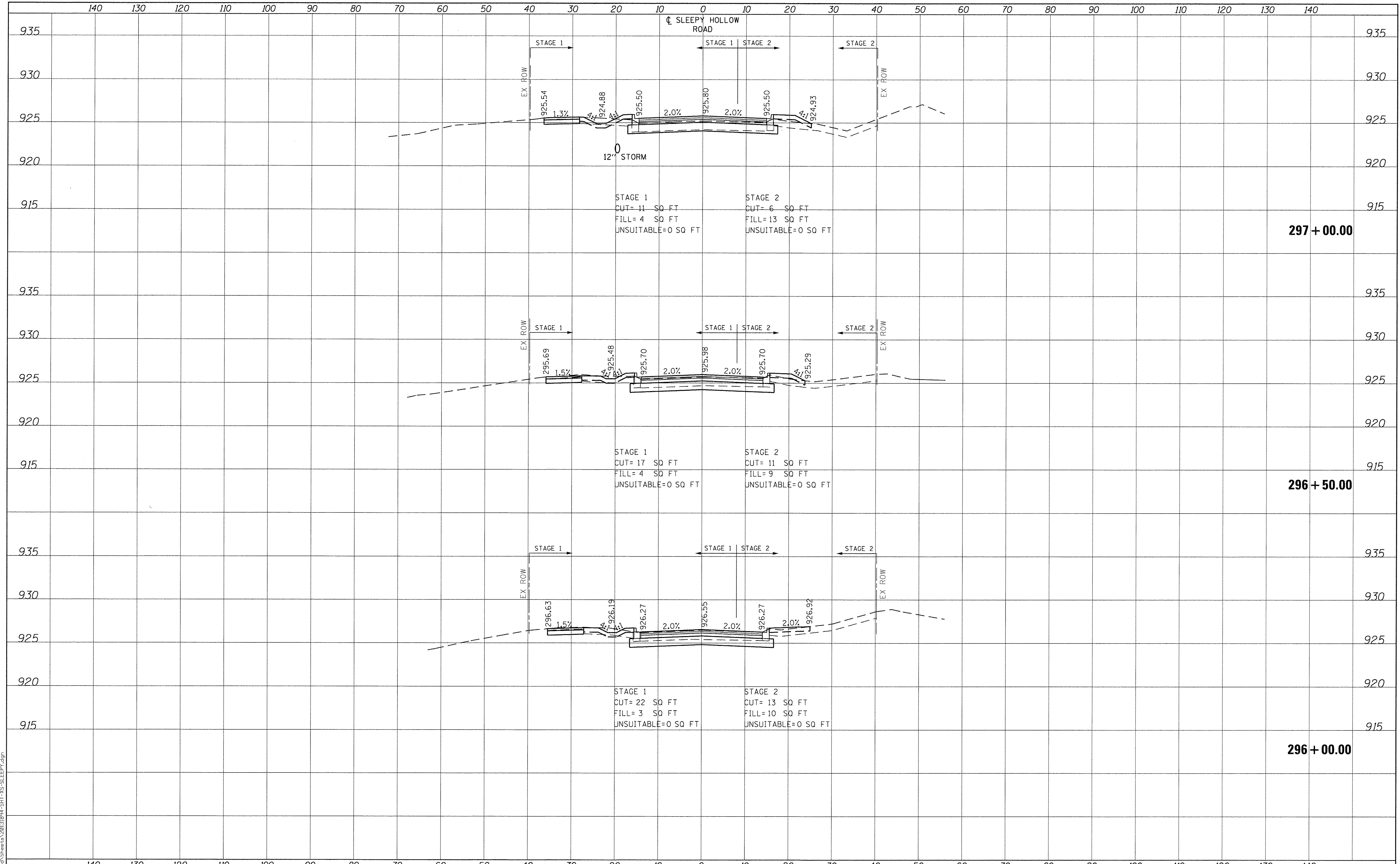

**STATE OF ILLINOIS
DEPARTMENT OF TRANSPORTATION**

**CROSS SECTIONS
SLEEPY HOLLOW ROAD**

USER NAME = bshae7iger	DESIGNED - BSH	REVISED -
	DRAWN - MLB	REVISED -
PLOT SCALE = 10.000' / in.	CHECKED - MFD	REVISED -
PLOT DATE = 10/26/2016	DATE - 10/28/2016	REVISED -

SCALE: 10H : 5V SHEET 468 OF 477 SHEETS STA. 296+00.00 TO STA. 297+00.00

F.A.P. RTE.	SECTION	COUNTY	TOTAL SHEETS	SHEET NO.
0361	13-00215-10-PV	KANE	477	468
			CONTRACT NO. 61C41	
FED. ROAD DIST. NO. 1 ILLINOIS FED. AID PROJECT				



DATE	
BY	
SURVEYED	
PLOTTED	
TEMPLATE	
AREAS	
CHECKED	
FINAL SURVEY	
NOTE BOOK	
NO.	

DATE	
BY	
SURVEYED	
PLOTTED	
TEMPLATE	
AREAS	
CHECKED	
ORIGINAL SURVEY	
NOTE BOOK	
NO.	

FILE NAME = G:\CH13\0109\Road\Sheet\13-00215-10-PV-SHT-13-SLEEPY.dgn

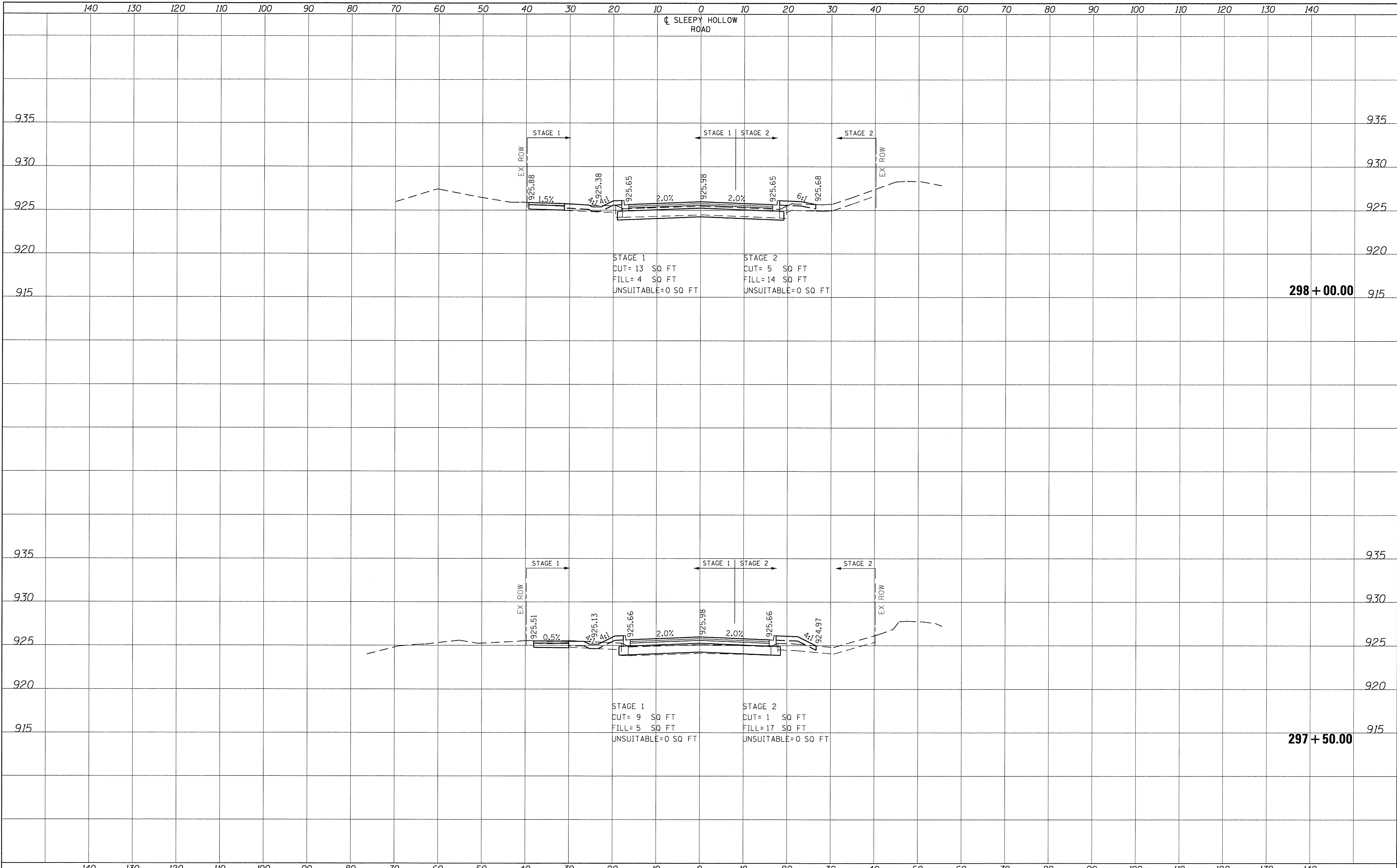

USER NAME = bsheef1ger	DESIGNED - BSH	REVISED -
PLOT SCALE = 10,000' / 1" =	DRAWN - MLB	REVISED -
PLOT DATE = 10/26/2016	CHECKED - MFD	REVISED -
	DATE - 10/28/2016	REVISED -

**STATE OF ILLINOIS
DEPARTMENT OF TRANSPORTATION**

**CROSS SECTIONS
SLEEPY HOLLOW ROAD**

SCALE: 10H : 5V SHEET 469 OF 477 SHEETS STA. 297+50.00 TO STA. 298+00.00

F.A.P. RTE.	SECTION	COUNTY	TOTAL SHEETS	SHEET NO.
0361	13-00215-10-PV	KANE	477	469
CONTRACT NO. 61C41				
FED. ROAD DIST. NO. 1 ILLINOIS FED. AID PROJECT				

DATE	
BY	
FINAL SURVEY	
NOTE BOOK	
NO.	
SURVEYED	
PLOTTED	
TEMPLATE	
AREAS CHECKED	

DATE	
BY	
ORIGINAL SURVEY	
NOTE BOOK	
NO.	
SURVEYED	
PLOTTED	
TEMPLATE	
AREAS CHECKED	

FILE NAME = G:\CH13\01093\Road\Sheets\2013\894-SHT-XS-SLEEPY.dgn

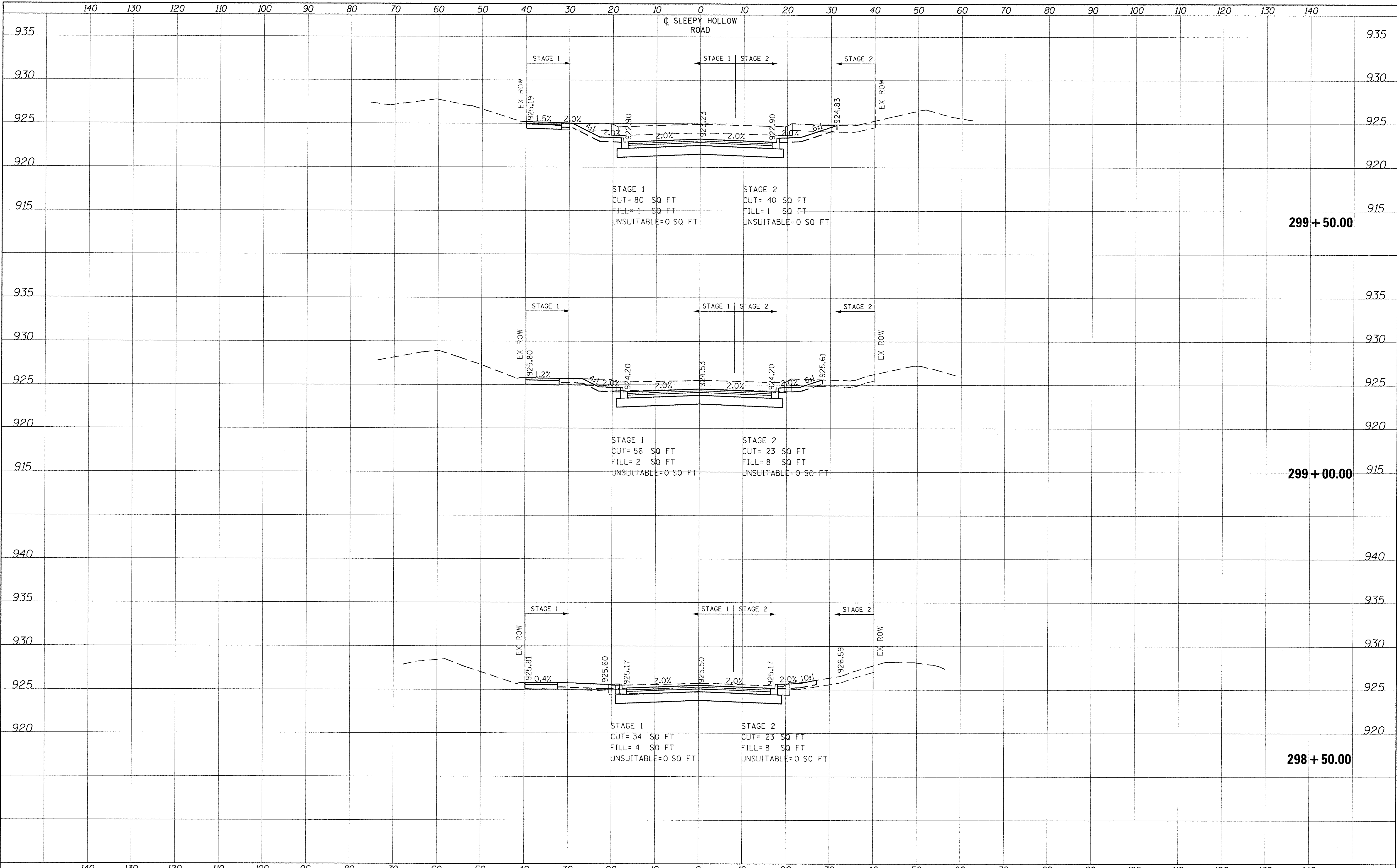

STAGE 1
CUT= 80 SQ FT
FILL= 1 SQ FT
UNSUITABLE= 0 SQ FT

STAGE 2
CUT= 40 SQ FT
FILL= 1 SQ FT
UNSUITABLE= 0 SQ FT

STAGE 1
CUT= 56 SQ FT
FILL= 2 SQ FT
UNSUITABLE= 0 SQ FT

STAGE 2
CUT= 23 SQ FT
FILL= 8 SQ FT
UNSUITABLE= 0 SQ FT

STAGE 1
CUT= 34 SQ FT
FILL= 4 SQ FT
UNSUITABLE= 0 SQ FT

STAGE 2
CUT= 23 SQ FT
FILL= 8 SQ FT
UNSUITABLE= 0 SQ FT

299 + 50.00

299 + 00.00

298 + 50.00



USER NAME = bshaeffinger	DESIGNED - BSH	REVISED -
PLOT SCALE = 10,000' / 1"	DRAWN - MLB	REVISED -
PLOT DATE = 10/26/2016	CHECKED - MFD	REVISED -
	DATE - 10/28/2016	REVISED -

**STATE OF ILLINOIS
DEPARTMENT OF TRANSPORTATION**

CROSS SECTIONS SLEEPY HOLLOW ROAD	
SCALE: 10H : 5V	SHEET 470 OF 477 SHEETS
STA. 298+50.00 TO STA. 299+50.00	

F.A.P. RTE.	SECTION	COUNTY	TOTAL SHEETS	SHEET NO.
0361	13-00215-10-PV	KANE	477	470
CONTRACT NO. 61C41				
FED. ROAD DIST. NO. 1 ILLINOIS FED. AID PROJECT				

DATE	
BY	
FINAL SURVEY	
SURVEYED	
PLOTTED	
NOTE BOOK	
TEMPLATE	
AREAS CHECKED	
NO.	

DATE	
BY	
ORIGINAL SURVEY	
SURVEYED	
PLOTTED	
NOTE BOOK	
TEMPLATE	
AREAS CHECKED	
NO.	

FILE NAME = G:\CH13\0109\Road\Sheets\2010094-SHT-YS-SLEEPY.dgn

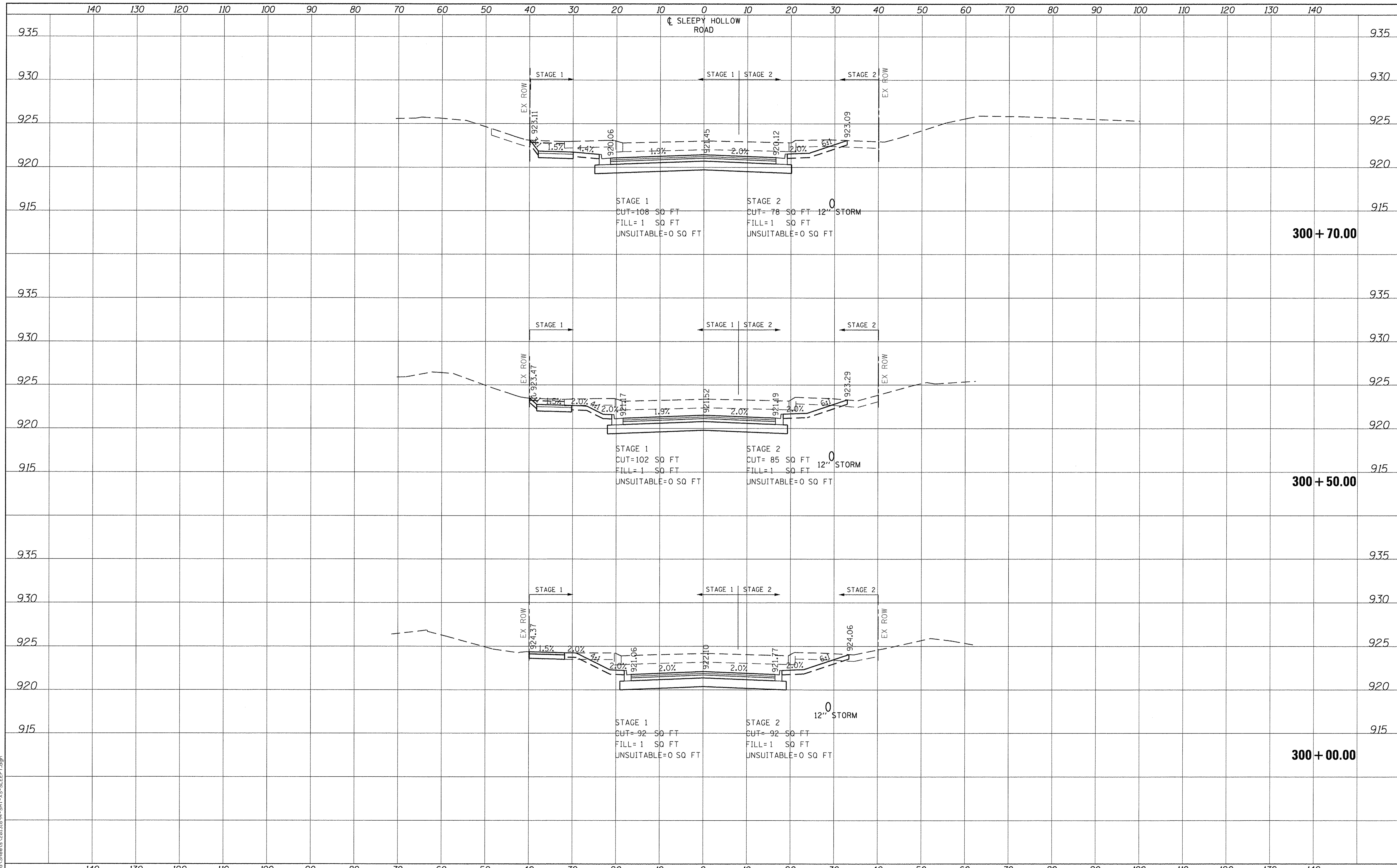

USER NAME = bshae71ger	DESIGNED - BSH	REVISED -
	DRAWN - MLB	REVISED -
PLOT SCALE = 10.000' / in.	CHECKED - MFD	REVISED -
PLOT DATE = 10/26/2016	DATE - 10/28/2016	REVISED -

**STATE OF ILLINOIS
DEPARTMENT OF TRANSPORTATION**

CROSS SECTIONS SLEEPY HOLLOW ROAD		
SCALE: 10H : 5V	SHEET 471 OF 477 SHEETS	STA. 300+00.00 TO STA. 300+70.00

F.A.P. RTE. 0361	SECTION 13-00215-10-PV	COUNTY KANE	TOTAL SHEETS 477	SHEET NO. 471
CONTRACT NO. 61C41				
FED. ROAD DIST. NO. 1 ILLINOIS FED. AID PROJECT				

DATE	
BY	
FINAL SURVEY	
SURVEYED	
PLOTTED	
TEMPLATE	
NOTE BOOK	
AREAS CHECKED	
NO.	

DATE	
BY	
ORIGINAL SURVEY	
SURVEYED	
PLOTTED	
TEMPLATE	
NOTE BOOK	
AREAS CHECKED	
NO.	

FILE NAME = G:\CH13\099\Road\Sheets\2013\094-SHT-YS-SLEEPY.dgn

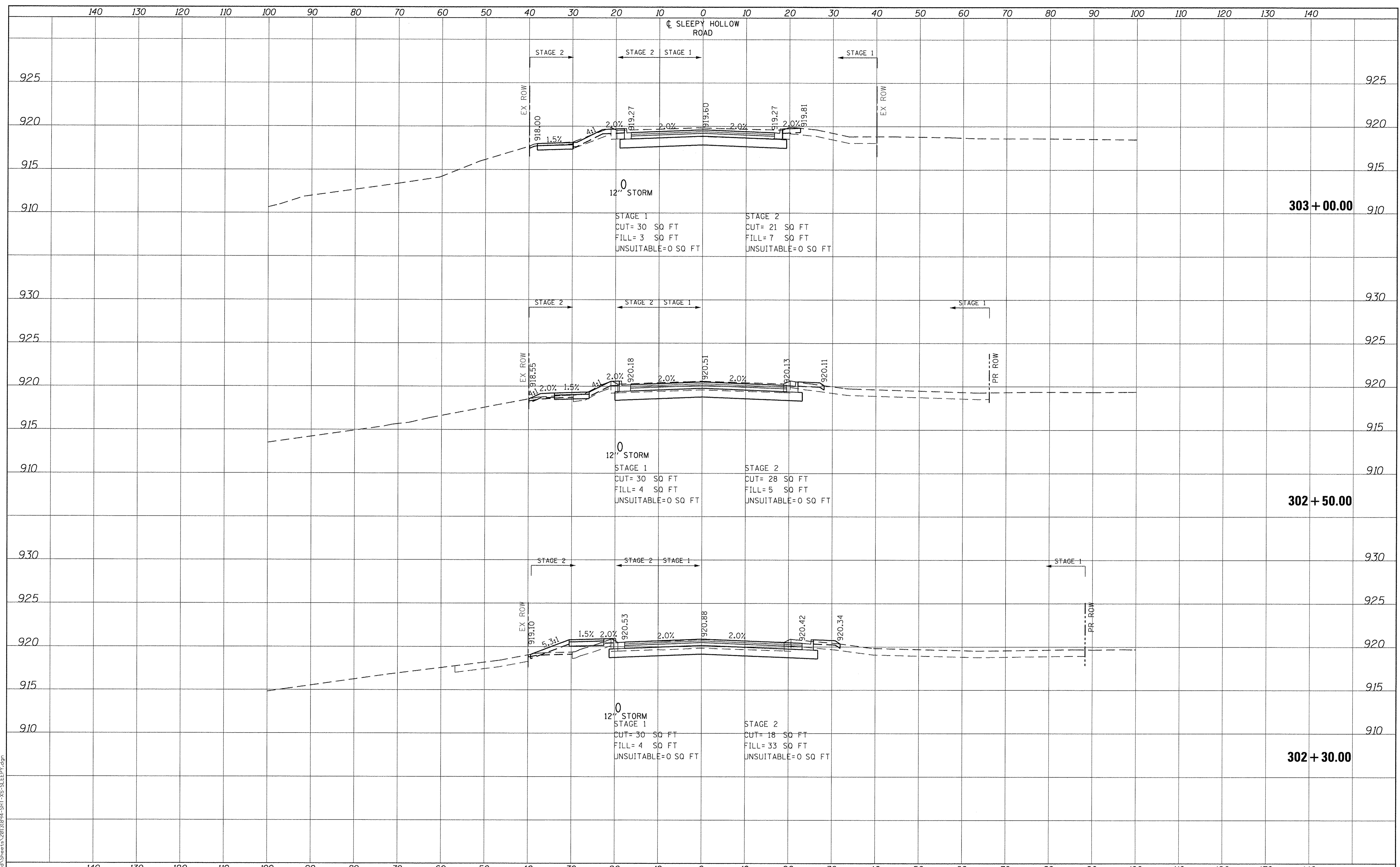

USER NAME = bsheefliger	DESIGNED - BSH	REVISED -	STATE OF ILLINOIS DEPARTMENT OF TRANSPORTATION	CROSS SECTIONS SLEEPY HOLLOW ROAD		F.A.P. RTE. 0361	SECTION 13-00215-10-PV	COUNTY KANE	TOTAL SHEETS 477	SHEET NO. 472
PLOT SCALE = 10.000' / 1"	DRAWN - MLB	REVISED -		SCALE: 10H : 5V	SHEET 472 OF 477 SHEETS	STA. 302+30.00 TO STA. 303+00.00	FED. ROAD DIST. NO. 1 ILLINOIS FED. AID PROJECT		CONTRACT NO. 61C41	
PLOT DATE = 10/26/2016	CHECKED - MFD	REVISED -								
	DATE - 10/28/2016	REVISED -								



FINAL SURVEY	SURVEYED	DATE
NOTE BOOK	PLOTTED	BY
NO.	TEMPLATE	
	AREAS CHECKED	

ORIGINAL SURVEY	SURVEYED	DATE
NOTE BOOK	PLOTTED	BY
NO.	TEMPLATE	
	AREAS CHECKED	

FILE NAME = G:\CH13\0195\Road\Sheets\20131894-SHT-XS-SLEEPY.dgn

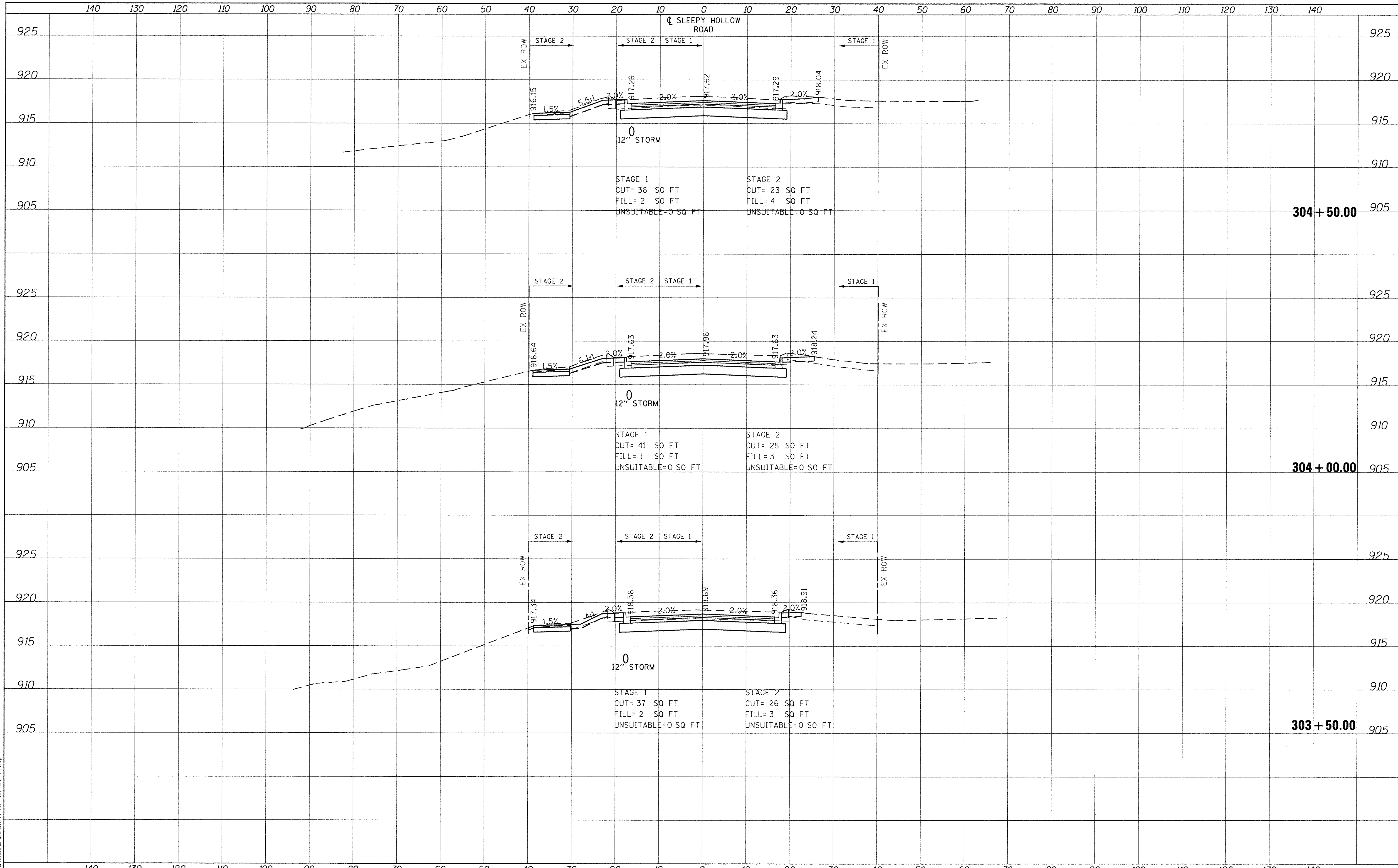

USER NAME = bshaeffiger	DESIGNED - BSH	REVISED -
	DRAWN - MLB	REVISED -
PLOT SCALE = 10,000' / 1" =	CHECKED - MFD	REVISED -
PLOT DATE = 10/26/2016	DATE - 10/28/2016	REVISED -

**STATE OF ILLINOIS
DEPARTMENT OF TRANSPORTATION**

CROSS SECTIONS SLEEPY HOLLOW ROAD	
SCALE: 10H : 5V	SHEET 473 OF 477 SHEETS
STA. 303+50.00 TO STA. 304+50.00	

F.A.P. RTE.	SECTION	COUNTY	TOTAL SHEETS	SHEET NO.
0361	13-00215-10-PV	KANE	477	473
				CONTRACT NO. 61C41
FED. ROAD DIST. NO. 1 ILLINOIS FED. AID PROJECT				

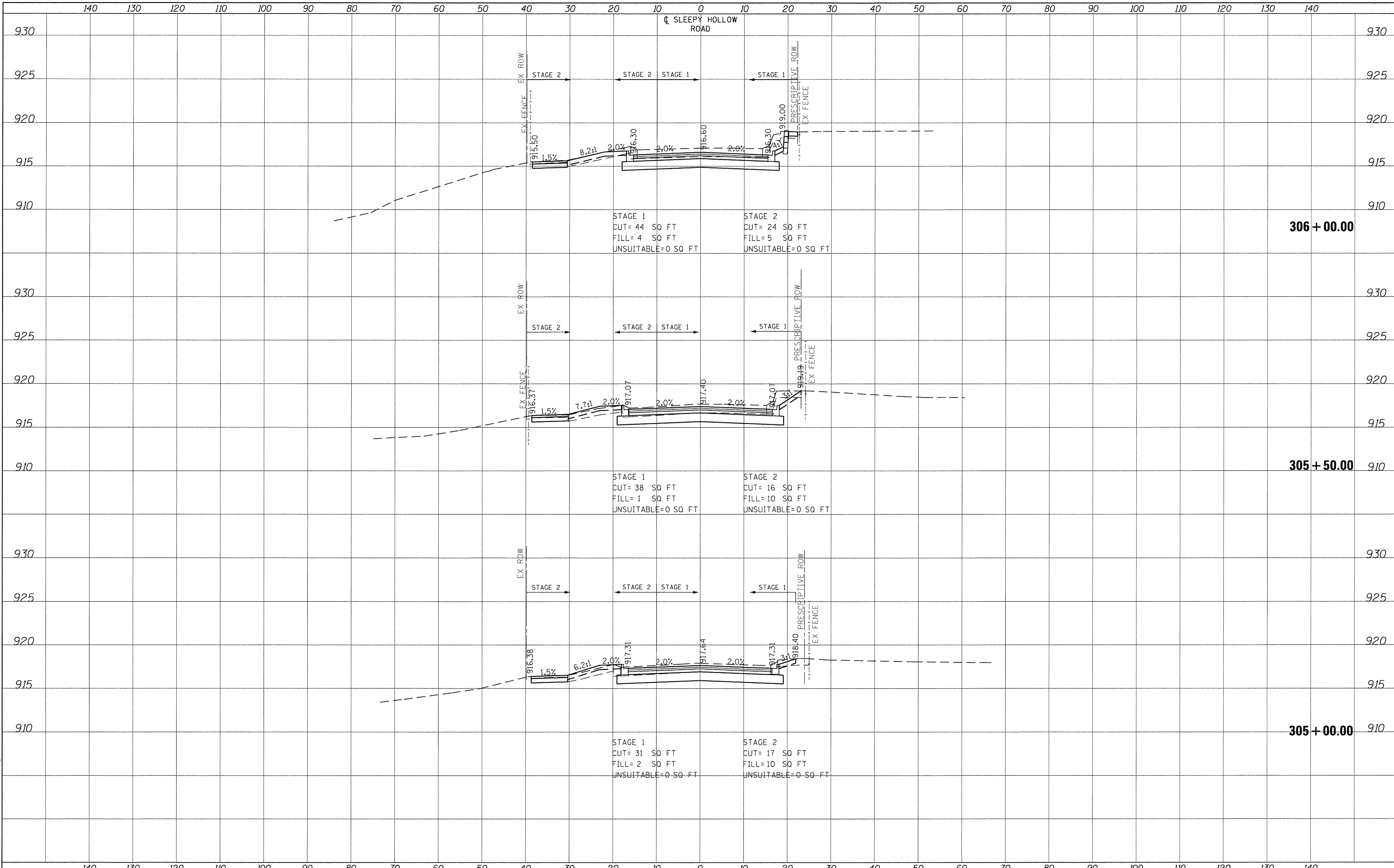

DATE	
BY	
SURVEYED	
PLOTTED	
TEMPLATE	
AREAS	
CHECKED	
FINAL SURVEY NOTE BOOK NO.	

DATE	
BY	
SURVEYED	
PLOTTED	
TEMPLATE	
AREAS	
CHECKED	
ORIGINAL SURVEY NOTE BOOK NO.	

FILE NAME = G:\CH13\0195\Road\Sheet\20131894-SHT-XS-SLEEPY.dgn



USER NAME = bshaeFliger	DESIGNED - BSH	REVISED -
PLOT SCALE = 10,000' / in.	DRAWN - MLB	REVISED -
PLOT DATE = 10/26/2016	CHECKED - MFD	REVISED -
	DATE - 10/28/2016	REVISED -

**STATE OF ILLINOIS
DEPARTMENT OF TRANSPORTATION**

CROSS SECTIONS SLEEPY HOLLOW ROAD	
SCALE: 10H : 5V	SHEET 474 OF 477 SHEETS
STA. 305+00.00 TO STA. 306+00.00	

F.A.P. RTE. 0361	SECTION 13-00215-10-PV	COUNTY KANE	TOTAL SHEETS 477	SHEET NO. 474
CONTRACT NO. 61C41				
FED. ROAD DIST. NO. 1 ILLINOIS FED. AID PROJECT				

DATE	
BY	
SURVEYED	
PLOTTED	
TEMPLATE	
AREAS	
CHECKED	
FINAL SURVEY	
NOTE BOOK	
NO.	

DATE	
BY	
SURVEYED	
PLOTTED	
TEMPLATE	
AREAS	
CHECKED	
ORIGINAL SURVEY	
NOTE BOOK	
NO.	

FILE NAME = G:\CH13\0109\Road\Sheet\1301094-SHT-13-SLEEPY.dgn

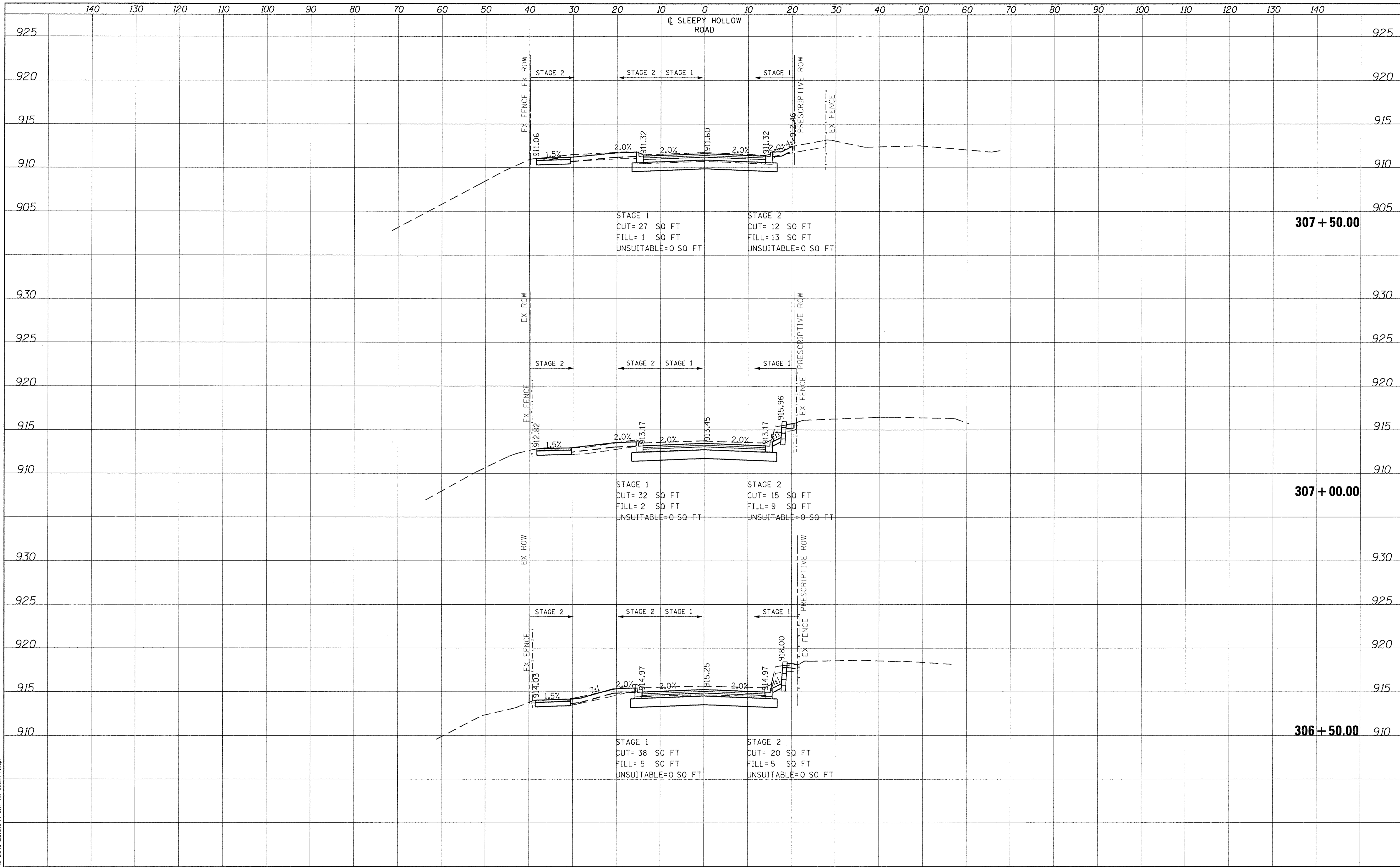

STAGE 1
CUT= 27 SQ FT
FILL= 1 SQ FT
UNSUITABLE= 0 SQ FT

STAGE 2
CUT= 12 SQ FT
FILL= 13 SQ FT
UNSUITABLE= 0 SQ FT

STAGE 1
CUT= 32 SQ FT
FILL= 2 SQ FT
UNSUITABLE= 0 SQ FT

STAGE 2
CUT= 15 SQ FT
FILL= 9 SQ FT
UNSUITABLE= 0 SQ FT

STAGE 1
CUT= 38 SQ FT
FILL= 5 SQ FT
UNSUITABLE= 0 SQ FT

STAGE 2
CUT= 20 SQ FT
FILL= 5 SQ FT
UNSUITABLE= 0 SQ FT

307 + 50.00

307 + 00.00

306 + 50.00



USER NAME = bshoefliger	DESIGNED - BSH	REVISED -
	DRAWN - MLB	REVISED -
PLOT SCALE = 10,000' / 1" =	CHECKED - MFD	REVISED -
PLOT DATE = 10/26/2016	DATE - 10/28/2016	REVISED -

**STATE OF ILLINOIS
DEPARTMENT OF TRANSPORTATION**

**CROSS SECTIONS
SLEEPY HOLLOW ROAD**

SCALE: 10H : 5V SHEET 475 OF 477 SHEETS STA. 306+50.00 TO STA. 307+50.00

F.A.P. RTE.	SECTION	COUNTY	TOTAL SHEETS	SHEET NO.
0361	13-00215-10-PV	KANE	477	475
CONTRACT NO. 61C41				
FED. ROAD DIST. NO. 1 ILLINOIS FED. AID PROJECT				

DATE	
BY	
SURVEYED	
PLOTTED	
TEMPLATE	
AREAS	
CHECKED	
FINAL SURVEY NOTE BOOK NO.	

DATE	
BY	
SURVEYED	
PLOTTED	
TEMPLATE	
AREAS	
CHECKED	
ORIGINAL SURVEY NOTE BOOK NO.	

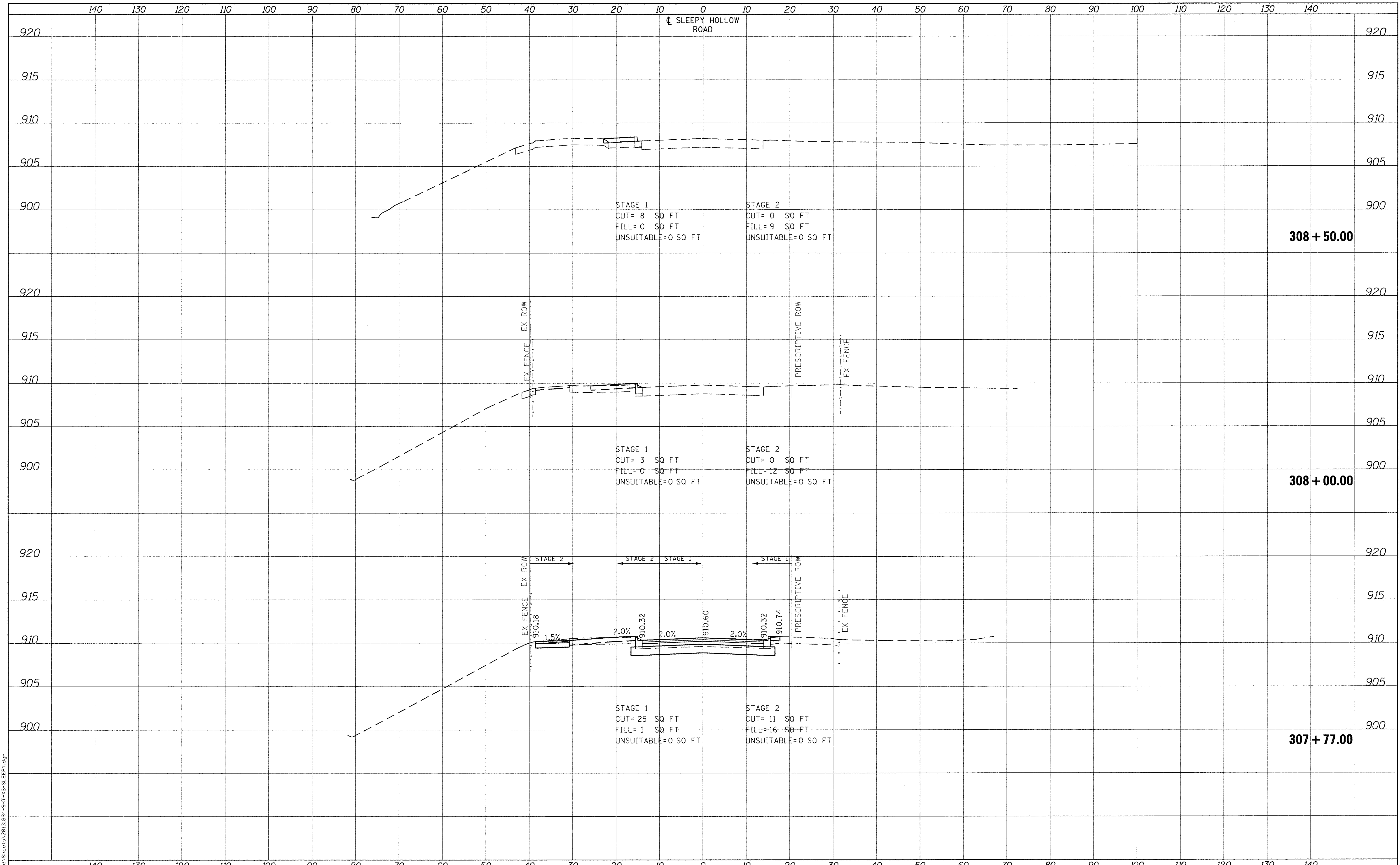

FILE NAME = G:\CH13\0194\Road\Sheets\201316\4-SHT-XS-SLEEPY.dgn

USER NAME = bshae1igor
DESIGNED - BSH
DRAWN - MLB
PLLOT SCALE = 10.000 "/>

CHECKED - MFD
DATE - 10/28/2016

REVISED -
REVISED -
REVISED -
REVISED -

**STATE OF ILLINOIS
DEPARTMENT OF TRANSPORTATION**

SCALE: 10H : 5V
SHEET 476 OF 477 SHEETS
STA. 307+77.00 TO STA. 308+50.00

**CROSS SECTIONS
SLEEPY HOLLOW ROAD**

F.A.P. RTE. 0361	SECTION 13-00215-10-PV	COUNTY KANE	TOTAL SHEETS 477	SHEET NO. 476
CONTRACT NO. 61C41				
FED. ROAD DIST. NO. 1 ILLINOIS FED. AID PROJECT				



140 130 120 110 100 90 80 70 60 50 40 30 20 10 0 10 20 30 40 50 60 70 80 90 100 110 120 130 140

☐ SLEEPY HOLLOW ROAD

915

915

910

910

905

905

900

900

895

895

309 + 50.00

915

915

910

910

905

905

900

900

895

895

309 + 00.00

140 130 120 110 100 90 80 70 60 50 40 30 20 10 0 10 20 30 40 50 60 70 80 90 100 110 120 130 140

DATE	
BY	
FINAL SURVEY	
NOTE BOOK	
NO.	
SURVEY	
PLATE	
TEMPLATE	
AREAS CHECKED	

DATE	
BY	
ORIGINAL SURVEY	
NOTE BOOK	
NO.	
SURVEY	
PLATE	
TEMPLATE	
AREAS CHECKED	

FILE NAME = G:\CH13\0191\Road\Sheets\20131894-SHT-XS-SLEEPY.dgn

USER NAME = bshaeffiger	DESIGNED - BSH	REVISED -
PLLOT SCALE = 10.000' / 1"	DRAWN - MLB	REVISED -
PLLOT DATE = 10/26/2016	CHECKED - MFD	REVISED -
	DATE - 10/28/2016	REVISED -

STATE OF ILLINOIS
DEPARTMENT OF TRANSPORTATION

CROSS SECTIONS
SLEEPY HOLLOW ROAD

SCALE: 10H : 5V SHEET 477 OF 477 SHEETS STA. 309+00.00 TO STA. 309+50.00

F.A.P. RTE.	SECTION	COUNTY	TOTAL SHEETS	SHEET NO.
0361	13-00215-10-PV	KANE	477	477
CONTRACT NO. 61C41				
FED. ROAD DIST. NO. 1 ILLINOIS FED. AID PROJECT				

