

FED. AID DIST. NO. 1	SECTION	COUNTY	TOTAL SHEETS	SHEET NO.
ILLINOIS	58RS-3	COOK	23	8
STA.		TO STA.		
FED. ROAD DIST. NO. 1		FED. AID PROJECT		

60468

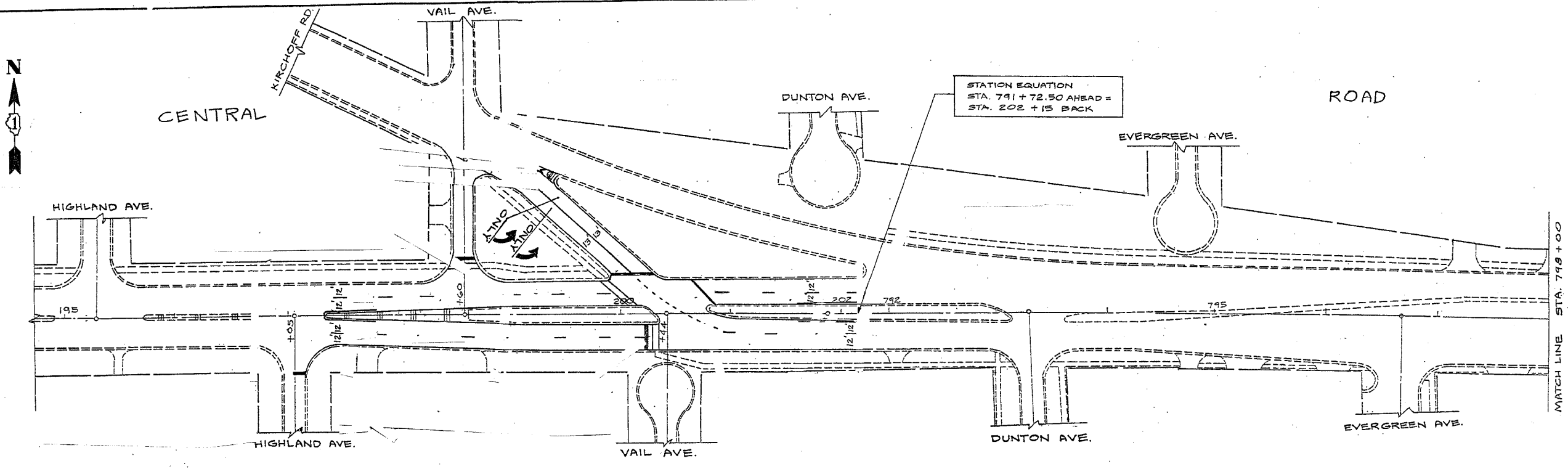

NOTE:
FOR RAISED REFLECTIVE PAVEMENT MARKERS,
REFER TO TYPICAL APPLICATIONS RAISED
REFLECTIVE PAVEMENT MARKERS
(SNOW-PLOW RESISTANT) AND DISTRICT ONE
TYPICAL PAVEMENT MARKINGS.

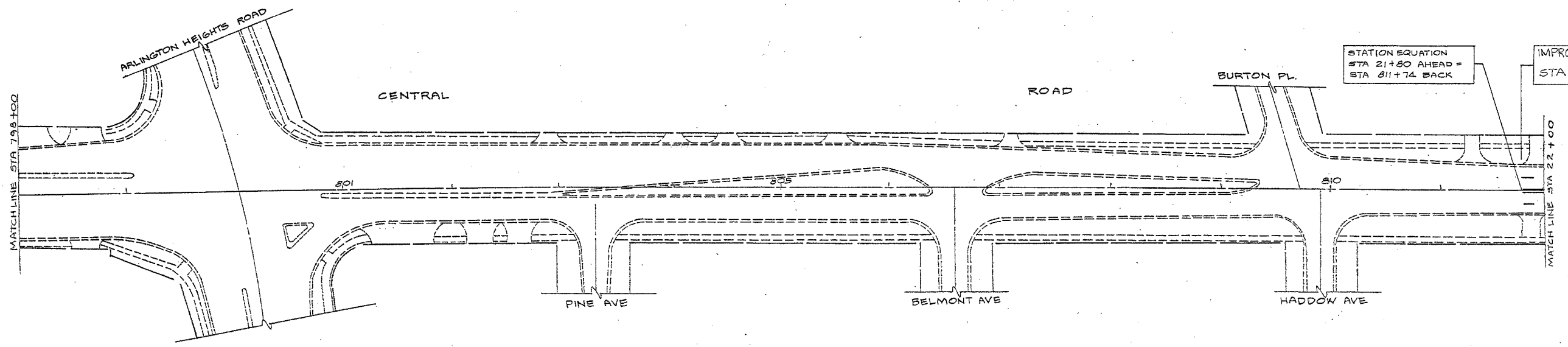

REVISIONS	
NAME	DATE

ILLINOIS DEPARTMENT OF TRANSPORTATION
CENTRAL ROAD
KIRCHHOFF RD TO BUSSE RD
PAVEMENT MARKING AND
DETECTOR LOOP REPLACEMENT
SCALE: VERT. _____ DRAWN BY _____
HORIZ. _____ CHECKED BY _____
DATE _____