

F.A.I. RTE.	SECTION	COUNTY	TOTAL SHEETS	SHEET NO.
94/90	2003-0311	COOK	976	117
STA. 1608+00		TO STA. 1620+00		
FED. ROAD DIST. NO.	ILLINOIS FED. AID PROJECT			
62583				

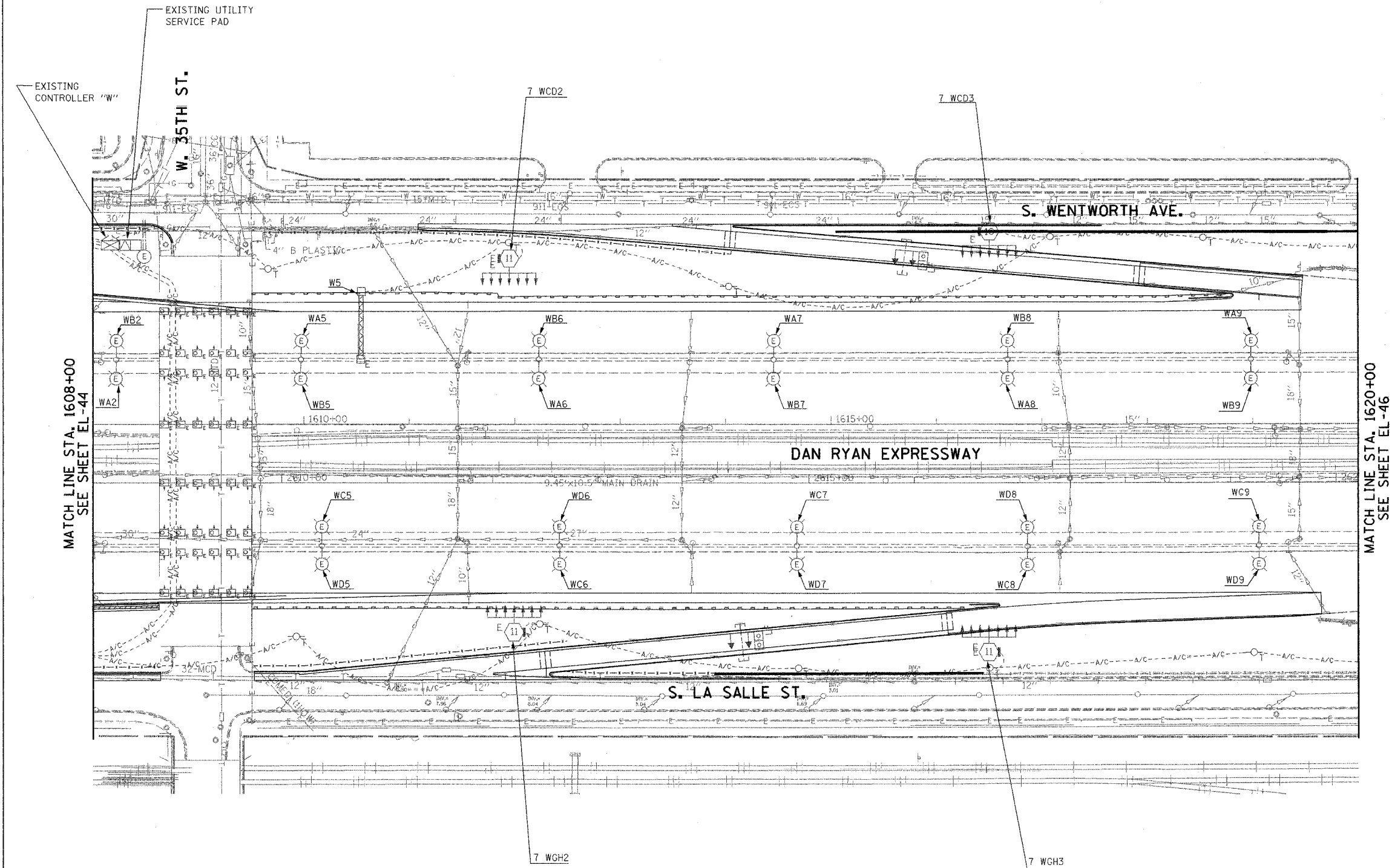

NOTES:
1. SEE DRAWINGS ME-01 AND ME-02 FOR ELECTRICAL SYMBOLS, AND ABBREVIATIONS.



MATCH LINE STA. 1608+00
SEE SHEET EL-44

MATCH LINE STA. 1620+00
SEE SHEET EL-46

EL-45

K&E KAM ENGINEERING, INC.
CONSULTING ENGINEERS
707A Davis Road, Suite 205
Elgin, Illinois 60123-1369

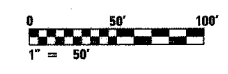

REVISIONS	
NAME	DATE

ILLINOIS DEPARTMENT OF TRANSPORTATION
F.A.I. 94/90 (DAN RYAN EXPRESSWAY)
31st STREET TO I-57

ROADWAY LIGHTING PLANS
EXISTING CONDITIONS AND DEMOLITION

SCALE: 1"=50'
DATE: OCTOBER 29, 2004

DRAWN BY: BL
CHECKED BY: SM

09/29/2004 09:56:55 AM