

F.A.I. RTE.	SECTION	COUNTY	TOTAL SHEETS	SHEET NO.
94/90	2003-0311	COOK	976	152
STA. 1536+00		TO STA. 1548+00		
FED. ROAD DIST. NO.	ILLINOIS	FED. AID PROJECT		

62583

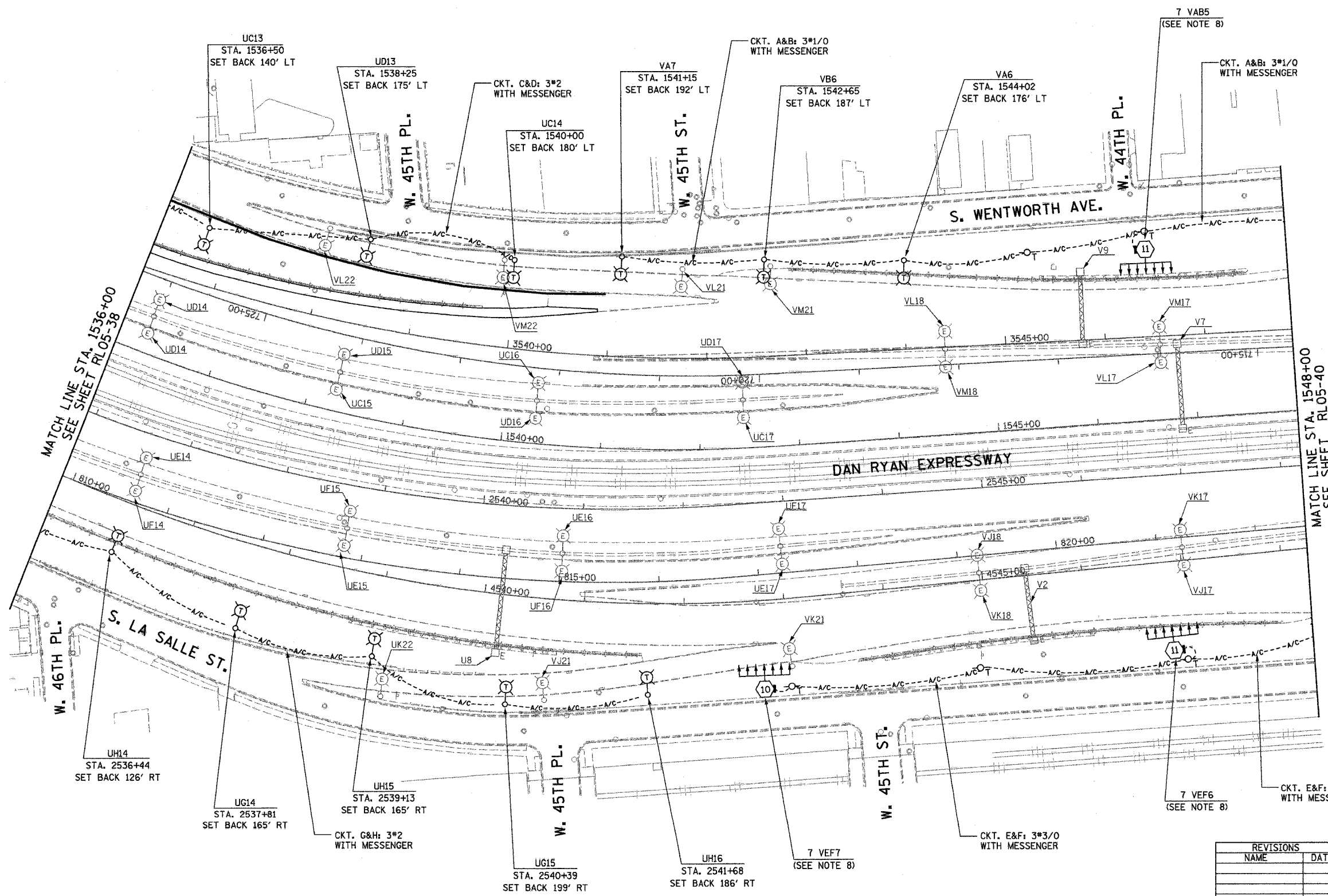

- NOTES:**
- SEE DRAWINGS ME-01 AND ME-02 FOR ELECTRICAL SYMBOLS AND ABBREVIATIONS.
  - UNLESS NOTED OTHERWISE, ALL ITEMS AND WORK SHOWN IN HEAVY LINE WEIGHT ON THIS DRAWING ARE PROPOSED NEW ITEMS AND WORK.
  - SEE DRAWING ES-07 FOR HIGH MAST LIGHT TOWER SCHEDULE.
  - PROPOSED HIGH MAST TOWERS SHALL BE INSTALLED AS INDICATED. THE TOWERS SHALL BE CONNECTED TO THE PROPOSED LIGHTING CONTROLLERS.
  - AERIAL CABLE AND TEMPORARY WOOD POLES SHALL BE INSTALLED TO PROVIDE TEMPORARY CONNECTIONS FOR THE PROPOSED HIGH MAST TOWERS.
  - EXISTING LIGHTING SHALL REMAIN OPERATIONAL UNTIL THE PROPOSED HIGH MAST TOWERS OR TEMPORARY LIGHTING ARE INSTALLED AND OPERATIONAL.
  - TEMPORARY LIGHTING SHALL BE INSTALLED AS SHOWN, BUT NOT OPERATIONAL.
  - THE HIGH MAST TOWER SHALL BE AFFIXED WITH AN EASILY REMOVABLE TEMPORARY IDENTIFICATION DECAL. PERMANENT IDENTIFICATION DECALS TO BE ADDED AT A LATER DATE.

MATCH LINE STA. 1536+00  
SEE SHEET RL05-38

MATCH LINE STA. 1548+00  
SEE SHEET RL05-40

RL05-39

**K&E** KAM ENGINEERING, INC.  
CONSULTING ENGINEERS  
707A Davis Road, Suite 205  
Elgin, Illinois 60123-1369

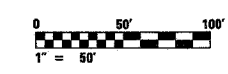

REVISIONS	
NAME	DATE

ILLINOIS DEPARTMENT OF TRANSPORTATION  
F.A.I. 94/90 (DAN RYAN EXPRESSWAY)  
31st STREET TO I-57

**ROADWAY LIGHTING PLANS  
PROPOSED IMPROVEMENTS 2005**

SCALE: 1"=50'      DRAWN BY: BL  
DATE: OCTOBER 29, 2004      CHECKED BY: SM

10/15/2004 10:02:17 AM G:\proj\94\90\2003-0311\9402039A.DWG