

F.A.I. RTE.	SECTION	COUNTY	TOTAL SHEETS	SHEET NO.
90/94	2003-0311	COOK	976	173
STA. 1230+00		TO STA. 1243+00		
FED. ROAD DIST. NO.	ILLINOIS FED. AID PROJECT			

62583

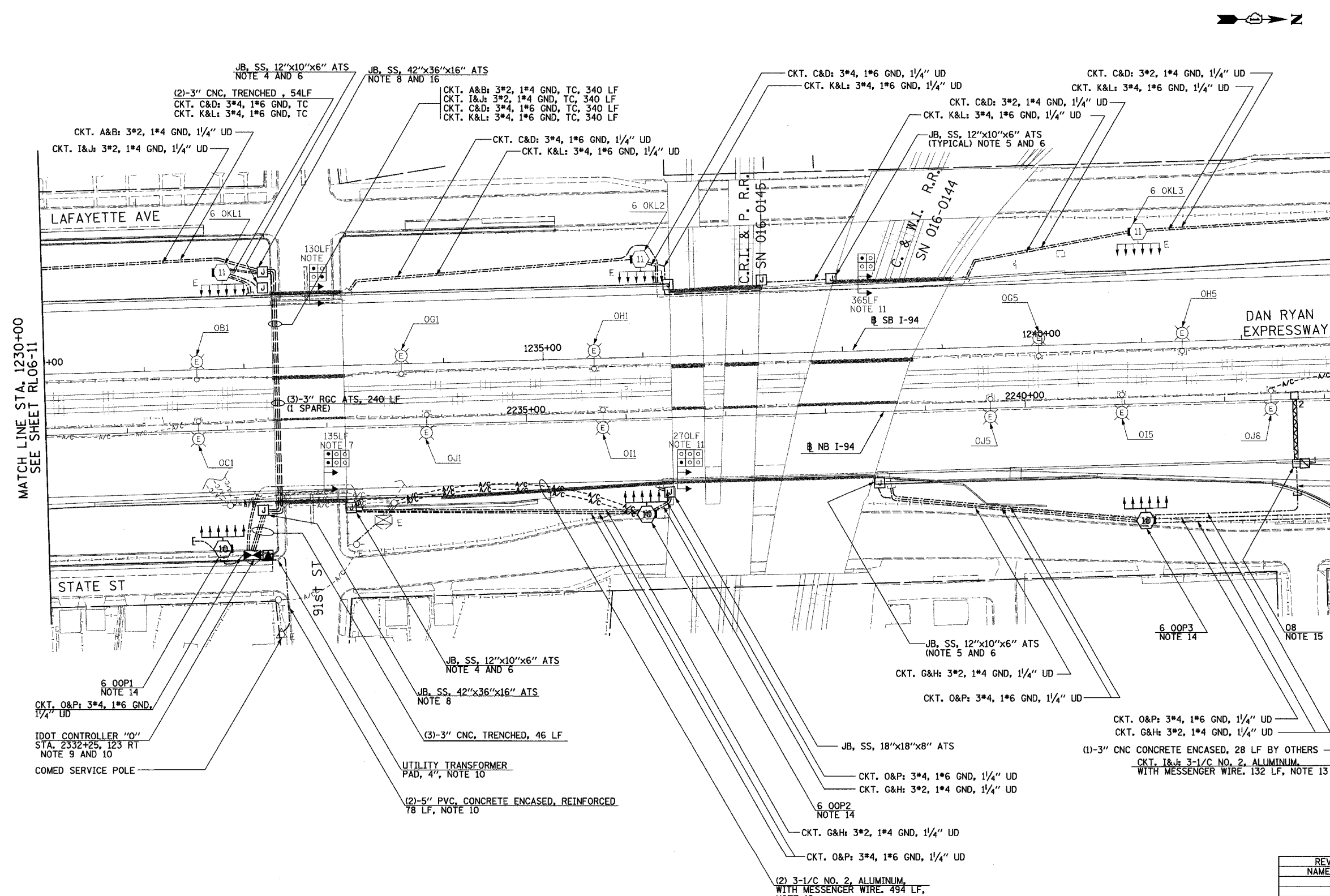

NOTES:

- SEE DRAWINGS ME-01 AND ME-02 FOR ELECTRICAL SYMBOLS AND ABBREVIATIONS.
- UNLESS NOTED OTHERWISE, ALL ITEMS AND WORK SHOWN IN HEAVY LINE WEIGHT ON THIS DRAWING ARE PROPOSED NEW ITEMS OF WORK.
- THE EXISTING ROADWAY LIGHTING SYSTEM SHALL REMAIN IN OPERATION UNTIL THE PROPOSED ROADWAY LIGHTING SYSTEM HAS BEEN INSTALLED, ENERGIZED, TESTED, AND ACCEPTED BY THE ENGINEER, UNLESS OTHERWISE DIRECTED BY THE ENGINEER.
- SEE DRAWING UL-12 FOR 91st STREET UNDERPASS LIGHTING PLANS.
- SEE DRAWINGS UL-13 AND UL-14 FOR C.R.I. & P. RAILROAD & W.I. RAILROAD UNDERPASS LIGHTING PLANS.
- ALL JUNCTION BOXES MOUNTED ON OVERPASS STRUCTURES SHALL BE INSTALLED AS SHOWN ON DRAWING ME-06, UNLESS OTHERWISE NOTED.
- CONCRETE ENCASED DUCTBANK SHALL BE PROVIDED UNDER SEPARATE CONTRACT. UNIT DUCT SHALL BE PULLED THROUGH DUCTBANK TO HIGH MAST TOWERS IN CONTINUOUS LENGTHS WITHOUT SPLICES. REFER TO SHEET ME-11 FOR DUCTBANK DEPTH UNDER ROAD.
- JUNCTION BOXES MOUNTED TO BRIDGE STRUCTURE SHALL BE INSTALLED AS SHOWN ON SHEET ME-05.
- LIGHTING CONTROLLER AND ELECTRICAL SERVICE MUST BE INSTALLED AS SHOWN ON ME-10, ME-18, ME-19, ME-20, AND BE-205 SHT 4 OF 4. EXISTING LIGHTING CONTROLLER TO REMAIN IN SERVICE. REFER SHEET SLO5-03 FOR SINGLE LINE DIAGRAM.
- REFER SHEET ME-15A FOR COMED TRANSFORMER PAD DETAILS.
- CONCRETE ENCASED DUCTBANK TO BE INSTALLED AS PART OF RAMP CONSTRUCTION CONTRACT 62694 AND 62695 FOR RAILROAD CROSSING ONLY. THIS IS TO ALLOW RAMP NORTH OF RAILROAD BRIDGES TO BE OPEN BEFORE MAINLINE CONSTRUCTION BEGINS.
- AERIAL CABLE AND TEMPORARY WOOD POLES SHALL BE INSTALLED TO ALLOW RAMP NORTH OF RAILROAD BRIDGES TO REMAIN OPEN DURING MAINLINE CONSTRUCTION. AERIAL CABLE AND WOOD POLES SHALL BE REMOVED AFTER PROPOSED LIGHTING IS INSTALLED, ENERGIZED AND ACCEPTED BY ENGINEER.
- PROVIDE AERIAL CABLE BETWEEN EXISTING LIGHT POLES TO PERMIT REMOVAL OF SIGN UNDER SEPARATE CONTRACT. REFER TO SHEET ME-16.
- FOUNDATIONS SHALL BE PROVIDED UNDER SEPARATE CONTRACT. CONTRACTOR TO COORDINATE TOWER INSTALLATION WITH CIVIL CONTRACTS 62694 AND 62695 AND AS DIRECTED BY THE ENGINEER.
- SIGN LUMINAIRES, DISCONNECT SWITCH AND WIRING SHALL BE PROVIDED UNDER THIS CONTRACT. SIGN STRUCTURE SHALL BE INSTALLED UNDER SEPARATE CONTRACT. NOTE: PROPOSED SIGN 06 SHALL BE INSTALLED AND OPERATIONAL BEFORE EXISTING SIGN 03 IS REMOVED.
- SPLICE CKT. A&B AND CKT. I & J TRAY CABLE TO UNIT DUCT IN JUNCTION BOX.

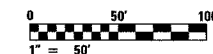

RL06-12

REVISIONS	
NAME	DATE

ILLINOIS DEPARTMENT OF TRANSPORTATION  
 F.A.I. 90/94 (DAN RYAN EXPRESSWAY)  
 31st STREET TO I-57  
 ROADWAY LIGHTING PLANS  
 PROPOSED IMPROVEMENTS 2006

SCALE: 1"=50'  
 DATE: OCTOBER 29, 2004

DRAWN BY: VG  
 CHECKED BY: TM

**SINGH**  
 SINGH & ASSOCIATES, INC.  
 CONSULTING ENGINEERS

300 W. ADAMS ST.  
 CHICAGO, IL 60606  
 TEL: (312) 629-0240  
 FAX: (312) 629-8449

11/23/2004 3:48:12 PM