

F.A.I. RTE.	SECTION	COUNTY	TOTAL SHEETS	SHEET NO.
90/94	2003-0311	COOK	976	178
STA. 1295+00		TO STA. 1308+00		
FED. ROAD DIST. NO.		ILLINOIS FED. AID PROJECT		

62583

NOTES:

- SEE DRAWINGS ME-01 AND ME-02 FOR ELECTRICAL SYMBOLS AND ABBREVIATIONS.

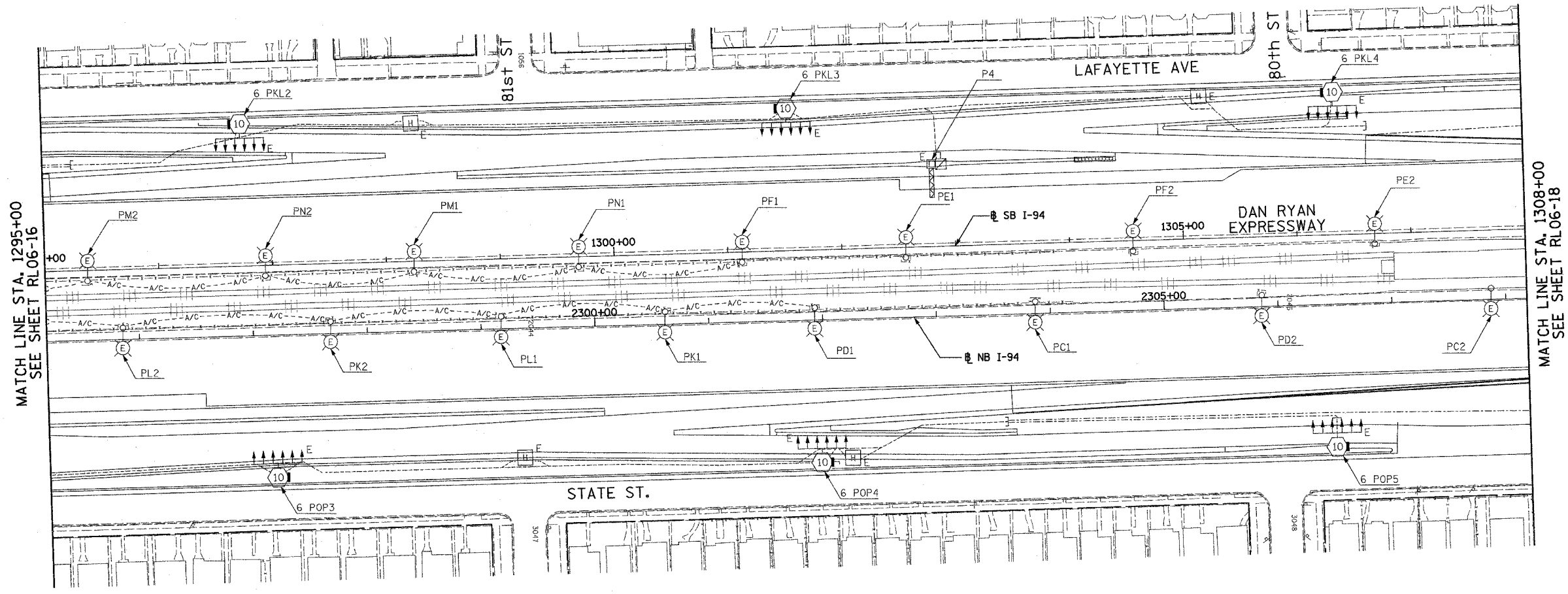
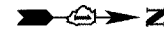

MATCH LINE STA. 1295+00
SEE SHEET RL06-16

MATCH LINE STA. 1308+00
SEE SHEET RL06-18

NO ELECTRICAL WORK THIS SHEET
FOR REFERENCE ONLY

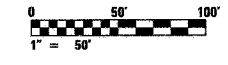

RL06-17

SINGH
SINGH & ASSOCIATES, INC.
CONSULTING ENGINEERS

300 N. ADAMS ST.
CHICAGO, IL 60606
TEL: (312) 629-0240
FAX: (312) 629-8449

REVISIONS	
NAME	DATE

ILLINOIS DEPARTMENT OF TRANSPORTATION
F.A.I. 90/94 (DAN RYAN EXPRESSWAY)
31st STREET TO I-57
ROADWAY LIGHTING PLANS
PROPOSED IMPROVEMENTS 2006
SCALE: 1"=50'
DATE: OCTOBER 29, 2004
DRAWN BY: VG
CHECKED BY: TM

10/15/2004 9:42:28 AM