

F.A.I. RTE.	SECTION	COUNTY	TOTAL SHEETS	SHEET NO.
90/94	2003-03II	COOK	976	180
STA. 1321+00		TO STA. 1334+00		
FED. ROAD DIST. NO.	ILLINOIS	FED. AID PROJECT		62583

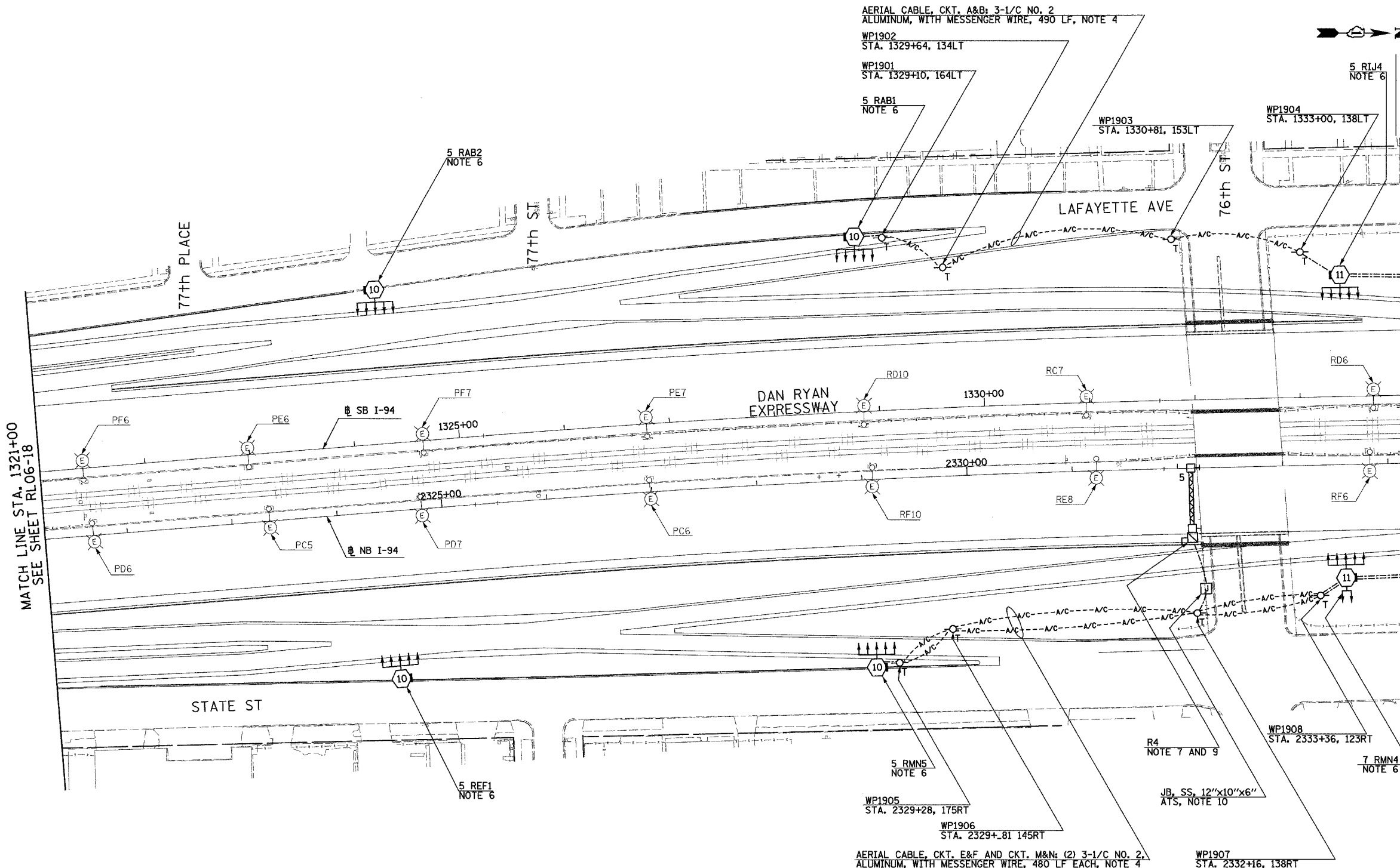

MATCH LINE STA. 1321+00  
SEE SHEET RL06-18

MATCH LINE STA. 1334+00  
SEE SHEET RL06-20

- NOTES:**
- SEE DRAWINGS ME-01 AND ME-02 FOR ELECTRICAL SYMBOLS AND ABBREVIATIONS.
  - UNLESS NOTED OTHERWISE, ALL ITEMS AND WORK SHOWN IN HEAVY LINE WEIGHT ON THIS DRAWING ARE PROPOSED NEW ITEMS OF WORK.
  - THE EXISTING ROADWAY LIGHTING SYSTEM SHALL REMAIN IN OPERATION UNTIL THE PROPOSED ROADWAY LIGHTING SYSTEM HAS BEEN INSTALLED, ENERGIZED, TESTED, AND ACCEPTED BY THE ENGINEER, UNLESS OTHERWISE DIRECTED BY THE ENGINEER.
  - REFER SHEET ME-16 FOR TEMPORARY AERIAL CABLE CONNECTION.
  - WIRING FOR PROPOSED ROADWAY LIGHTING AND SIGNS FOR RAMP BETWEEN 79th AND 76th STREET NOT COMPLETE. ANY REQUIRED DUCTBANKS SHALL BE PROVIDED UNDER SEPARATE CONTRACT. ESTIMATED QUANTITIES ARE INCLUDED IN COST ESTIMATE AS FOLLOWS: 3\*2, 1\*4 GND, 1/4" UD, 3500 LF.
  - INSTALL LIGHT TOWER ONLY. FOUNDATION SHALL BE PROVIDED UNDER SEPARATE CONTRACT. COORDINATE WITH CIVIL CONTRACTS AND AS DIRECTED BY THE ENGINEER.
  - SIGN LUMINAIRES, DISCONNECT SWITCH AND WIRING SHALL BE PROVIDED UNDER THIS CONTRACT. SIGN STRUCTURE SHALL BE INSTALLED UNDER SEPARATE CONTRACT.
  - SEE DRAWING UL-18 FOR 76th STREET UNDERPASS LIGHTING PLAN.
  - REFER TO DETAIL ME-06A FOR TYPICAL TRANSITION FROM UNIT DUCT TO BRIDGE MOUNTED SIGN STRUCTURE COST FOR TRANSITION SHALL BE INCLUDED UNDER "ELECTRIC CONNECTION TO SIGN STRUCTURE" PAY ITEM.
  - ALL JUNCTION BOXES MOUNTED ON OVERPASS STRUCTURES SHALL BE INSTALLED AS SHOWN ON DRAWING ME-06, UNLESS OTHERWISE NOTED.

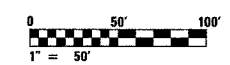

RL06-19

**SINGH** 300 W. ADAMS ST.  
CHICAGO, IL 60606  
SINGH & ASSOCIATES, INC. TEL: (312) 629-0240  
CONSULTING ENGINEERS FAX: (312) 629-8449

REVISIONS	
NAME	DATE

ILLINOIS DEPARTMENT OF TRANSPORTATION  
F.A.I. 90/94 (DAN RYAN EXPRESSWAY)  
31st STREET TO I-57  
ROADWAY LIGHTING PLANS  
PROPOSED IMPROVEMENTS 2006

SCALE: 1"=50'  
DATE: OCTOBER 29, 2004

DRAWN BY: VG  
CHECKED BY: TM

11/22/2004 3:33:03 PM