

F.A.I. RTE.	SECTION	COUNTY	TOTAL SHEETS	SHEET NO.
90/94	2003-0311	COOK	976	295
STA. 1426+00.00		TO STA. 1436+00.00		
FED. ROAD DIST. NO. 1		ILLINOIS	FED. AID PROJECT	

62583

NOTES:

- SEE DRAWINGS ME-01 AND ME-02 FOR ELECTRICAL SYMBOLS AND ABBREVIATIONS.
- SEE DRAWINGS ES-04 & ES-05 FOR HIGH MAST LIGHT TOWER SCHEDULE.
- SEE DRAWING UL-26 FOR THE P. FT. W. & C. RAILROAD UNDERPASS LIGHTING PLANS.

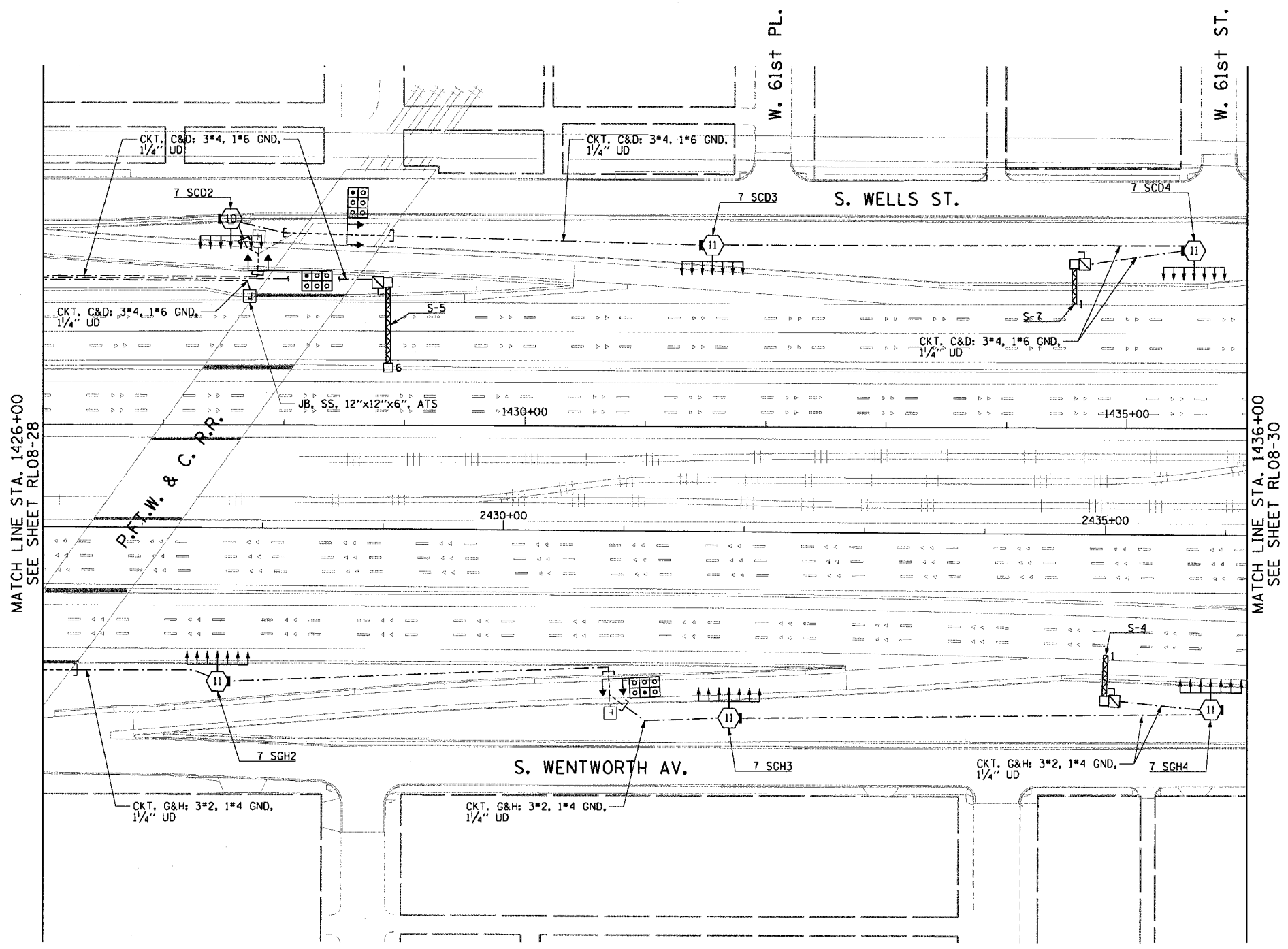
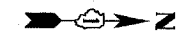

MATCH LINE STA. 1426+00
SEE SHEET RL08-28

MATCH LINE STA. 1436+00
SEE SHEET RL08-30



RL08-29

REVISIONS	
NAME	DATE

ILLINOIS DEPARTMENT OF TRANSPORTATION
F.A.I. 90/94 (DAN RYAN EXPRESSWAY)
31st STREET TO I-57

**ROADWAY LIGHTING PLANS
FINAL CONDITIONS**

SCALE: 1"=50'
DATE: October 29, 2004

DRAWN BY: CJM
CHECKED BY: WDS

CTE ENGINEERS
CONSER TOWNSEND ENVIRONMENTAL ENGINEERS, INC.
303 EAST WACKER DRIVE, SUITE 600
CHICAGO ILLINOIS 60601-5222, PHONE: (312) 938-0300

m:\p\0468\elect\6-entr\2b\sls\contract 2\2003\Tran\70202920_08.sfr

06/05/00 PH

11/19/2004