

F.A.I. RTE.	SECTION	COUNTY	TOTAL SHEETS	SHEET NO.
90/94	2003-0311	COOK	976	666
STA. 1596+50.00		TO STA. 1610+00.00		
FED. ROAD DIST. NO. 1		ILLINOIS		FED. AID PROJECT

62583

NOTES:

- SEE DRAWINGS ME-01 AND ME-02 FOR ELECTRICAL SYMBOLS AND ABBREVIATIONS.
- NOTED CONDUITS ARE FURNISHED AND INSTALLED BY OTHERS UNDER CONTRACT NUMBERS 62301 AND 62584. ALL CABLES ARE TO BE FURNISHED AND INSTALLED UNDER THIS CONTRACT.
- NEW ELECTRIC SERVICE TO BE INSTALLED ON EXISTING UTILITY POLE. SEE DRAWING ESD-01 FOR ELECTRIC SERVICE INSTALLATION DETAILS.
- SIGN TRUSS TO BE FURNISHED AND INSTALLED AT STATION NUMBER 2607+00 BY OTHERS IN CONTRACT NUMBER 62301.
- SEE DRAWING DT-04 FOR SIGN INSTALLATION DETAILS.
- CONTRACTOR MUST INTERCEPT CONDUIT STUBS AND MAKE CONNECTIONS TO THE NEW HANDHOLES INSTALLED UNDER THIS CONTRACT.
- SEE DRAWING DT-06 FOR UPS EQUIPMENT DETAILS. SEE DRAWINGS DT-36 AND DT-47 FOR CABINET AND FOUNDATION DETAILS.
- SEE DRAWING DT-01 FOR DUCT DETAILS IN MEDIAN WALL.
- HANDHOLE AS SHOWN ON DRAWING DET-43.
- DMS UPS CABINET, DMS UPS FOUNDATION, CONDUIT AND CABLE FROM NEW ELECTRIC SERVICE TO CABINET 30, AND NEW 100A ELECTRIC SERVICE MUST BE INSTALLED AS SOON AS THE WORK IN CONTRACT NUMBER 62584 WILL PERMIT. THIS IS NECESSARY TO FACILITATE THE INSTALLATION OF CABINET 30 AS SHOWN ON DET-44. ONCE THE SIGN IS READY FOR INSTALLATION THE CABLES WILL BE PULLED BACK TO DMS-UPS-06. NEW UPS EQUIPMENT WILL BE INSTALLED INSIDE THE CABINET, AND THE SYSTEM CONNECTED IN ITS FINAL CONFIGURATION. THIS WORK WILL BE INCIDENTAL TO THE INSTALLATION OF THE CABINET.
- COORDINATE INSTALLATION OF ALL ITEMS SHOWN ON THIS SHEET WITH CONTRACT NUMBERS 62301 AND 62584. ALL WORK SHOULD BE COMPLETED BY THE TIME THAT THE SIGN TRUSS IS READY TO BE INSTALLED. THE SIGN CONTROLLER AND DMS UPS EQUIPMENT SHOULD NOT BE INSTALLED PRIOR TO THE INSTALLATION OF THE SIGN.

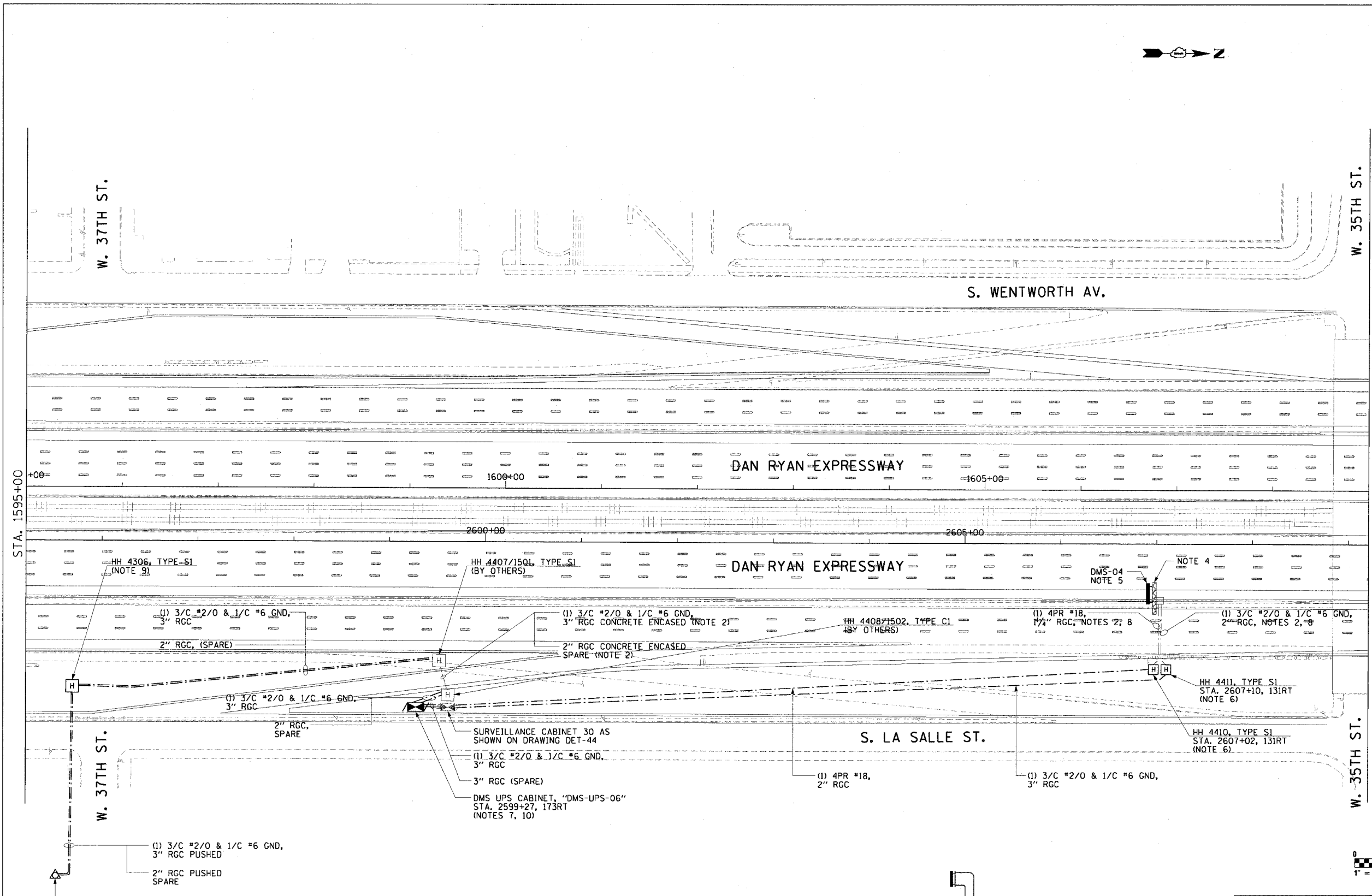

DMS-07

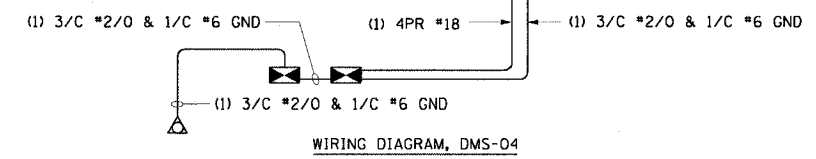

REVISIONS	
NAME	DATE

ILLINOIS DEPARTMENT OF TRANSPORTATION
 F.A.I. 90/94 (DAN RYAN EXPRESSWAY)
 31st STREET TO I-57
 DYNAMIC MESSAGE SIGN
 NB 35TH ST. SITE LAYOUT
 SIGN DMS-04
 SCALE: 1"=50'
 DATE: October 29, 2004
 DRAWN BY: HAR
 CHECKED BY: BMW

CTE ENGINEERS
 CONSOER TOWNSEND ENVIRONMENTAL ENGINEERS, INC.
 303 EAST WALKER DRIVE, SUITE 600
 CHICAGO, ILLINOIS 60601-5212, PHONE: (312) 938-0300

11/23/2004 02:05:38 PM