

F.A.I. RTE.	SECTION	COUNTY	TOTAL SHEETS	SHEET NO.
90/94	2003-0311	COOK	976	694
STA. 1471+00.00		TO STA. 1482+50.00		
FED. ROAD DIST. NO. 1		ILLINOIS	FED. AID PROJECT	

62583

**NOTES:**

1. SEE DRAWINGS ME-01 AND ME-02 FOR ELECTRICAL SYMBOLS AND ABBREVIATIONS.
2. SEE DRAWING COMM-33 FOR CCTV COMMUNICATIONS SYSTEM CONDUIT AND CABLE LAYOUT
3. THIS SHEET ONLY DEPICTS INSTALLATION OF CLOSED CIRCUIT TELEVISION SYSTEM. LIGHTING SYSTEM IS SHOWN FOR INFORMATION ONLY AND SHOULD BE INSTALLED AS SHOWN ON THE LIGHTING PLANS.

THIS SHEET PROVIDED FOR REFERENCE ONLY. ALL CCTV WORK TO BE DONE UNDER A SEPARATE CONTRACT (62733)

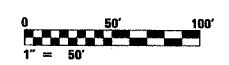
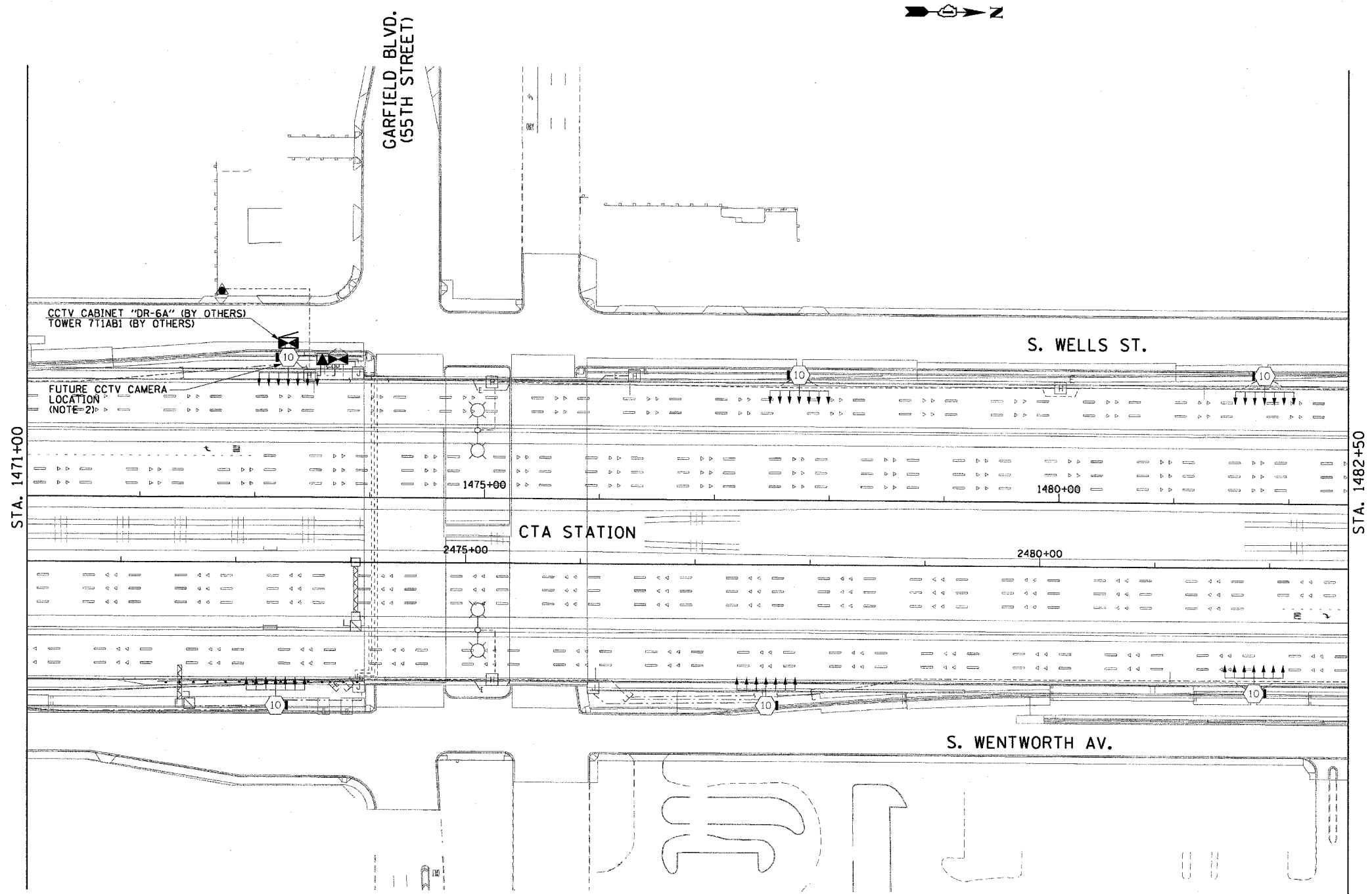

CCTV-22

REVISIONS	
NAME	DATE

ILLINOIS DEPARTMENT OF TRANSPORTATION  
 F.A.I. 90/94 (DAN RYAN EXPRESSWAY)  
 31st STREET TO I-57

**CLOSED CIRCUIT TELEVISION  
 SITE LAYOUT  
 CAMERA DR-6A**

SCALE: 1"=50'  
 DATE: October 29, 2004

DRAWN BY: HAR  
 CHECKED BY: BMW

**CTE ENGINEERS**  
 CONSOER TOWNSEND ENVIRONMENTAL ENGINEERS, INC.  
 303 EAST WACKER DRIVE, SUITE 600  
 CHICAGO ILLINOIS 60601-5212, PHONE: (312) 938-0300

10/15/2004 08:44:23 AM