

SECTION	COUNTY	TOTAL SHEETS	SHEET NO.
2003-0311	COOK	976	817
STA. 1644+00	TO STA.		
FED. ROAD DIST. NO.	ILLINOIS	FED. AID PROJECT	
62583			

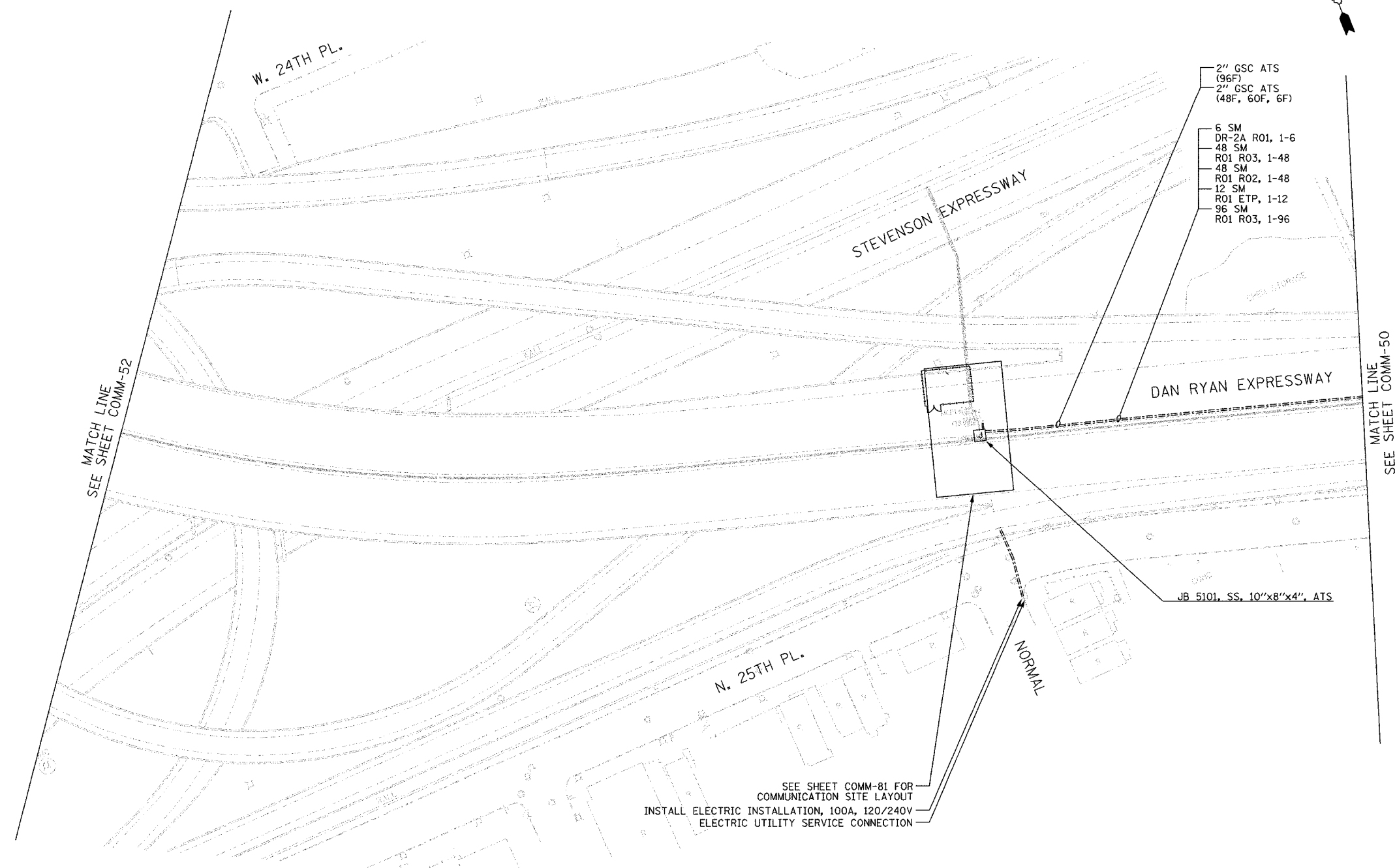

- 2" GSC ATS (96F)
- 2" GSC ATS (48F, 60F, 6F)
- 6 SM DR-2A R01, 1-6
- 48 SM R01 R03, 1-48
- 48 SM R01 R02, 1-48
- 12 SM R01 ETP, 1-12
- 96 SM R01 R03, 1-96

MATCH LINE
SEE SHEET COMM-52

MATCH LINE
SEE SHEET COMM-50

SEE SHEET COMM-81 FOR
COMMUNICATION SITE LAYOUT
INSTALL ELECTRIC INSTALLATION, 100A, 120/240V
ELECTRIC UTILITY SERVICE CONNECTION

- NOTES:**
1. PROPOSED COMMUNICATION SHELTER (RO1) SET AT GRADE UNDER DAN RYAN EXPRESSWAY STRUCTURE. SEE SHEET COMM-81 FOR SHELTER SITE LAYOUT.
 2. FOR CONDUIT AND JUNCTION BOX ATTACHMENT DETAILS, SEE SHEET DT-52.

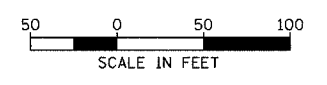

COMM-51

REVISIONS	
NAME	DATE

ILLINOIS DEPARTMENT OF TRANSPORTATION
F.A.I. 94/90 (DAN RYAN EXPRESSWAY)
31st STREET TO I-57

COMMUNICATIONS BACKBONE CONDUIT
AND CABLE LAYOUT

SCALE: 1"=50'
DATE: October 29, 2004

DRAWN BY: DHI
CHECKED BY: MJL

Edwards AND Kelcey
ONE NORTH FRANKLIN
CHICAGO, IL 60606
PHONE: (312) 251-3000
FAX: (312) 251-3015
WEB: WWW.EKCORP.COM

11/23/2004 11:34:12 AM