

F.A.I. RTE.	SECTION	COUNTY	TOTAL SHEETS	SHEET NO.
90/94	2004-075RS	COOK	65	27
STA. 143+00		TO STA. 148+00		
FED. ROAD DIST. NO. 1 ILLINOIS FED. AID PROJECT				

62814

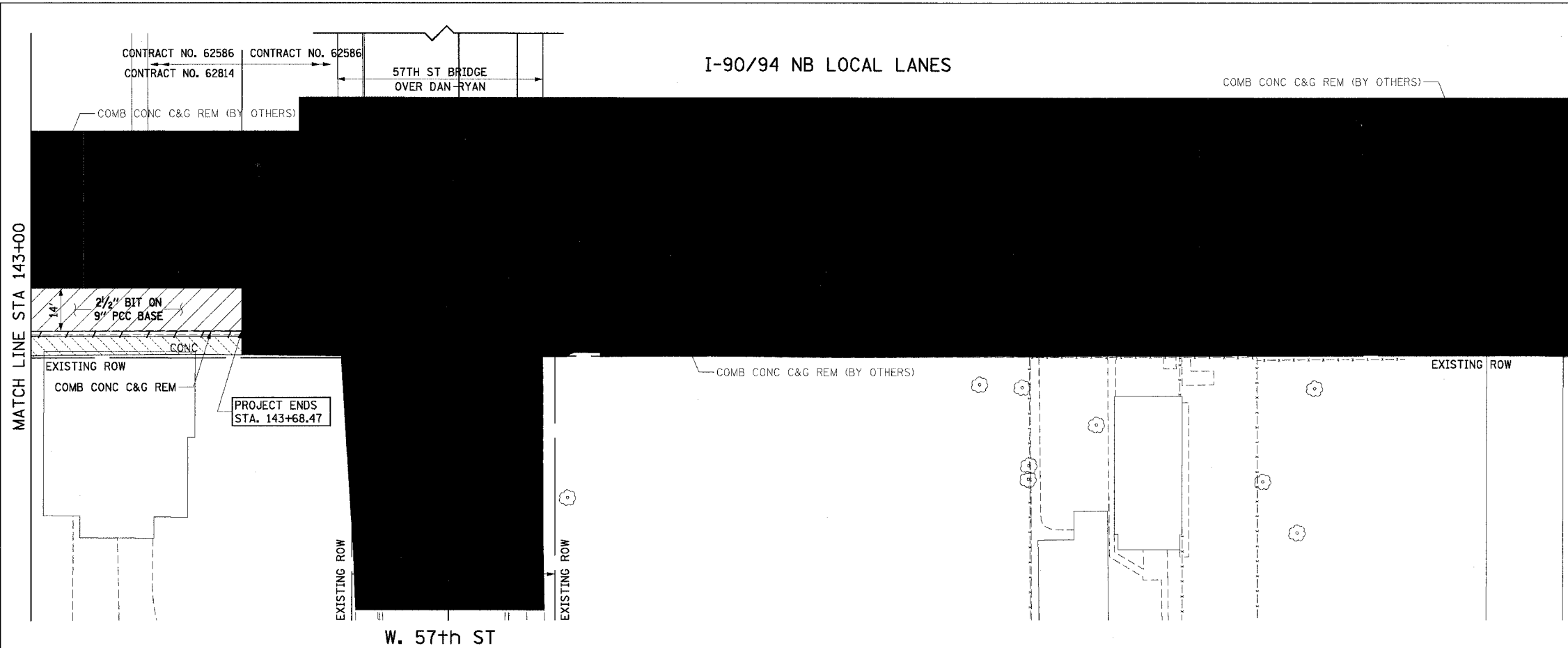
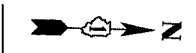

- LEGEND:**
- PAVEMENT REMOVAL
 - LINEAR REMOVALS
 - SIDEWALK REMOVAL
 - APPROACH SLAB REMOVAL (BY OTHERS)
 - DRIVEWAY PAVEMENT REMOVAL
 - PAVED SHOULDER REMOVAL (BY OTHERS)
 - WORK TO BE DONE BY OTHERS

- NOTES:**
1. CONTRACTOR SHALL COORDINATE WITH CONTRACT 62807 FOR ROADWAY LIGHTING REMOVALS AND INSTALLATIONS.
 2. CONTRACTOR SHALL COORDINATE WITH CONTRACT 62801 FOR TRAFFIC SIGNAL REMOVALS AND IMPROVEMENTS.
 3. SEE DRAINAGE AND UTILITY SHEETS FOR REMOVALS AND IMPROVEMENTS.
 4. CONTRACTOR SHALL COORDINATE WITH CONTRACT 62798 FOR FRONTAGE ROAD SIGNING.
 5. ALL DRIVEWAYS SHOWN ARE CONCRETE UNLESS NOTED OTHERWISE.

EXISTING CONDITIONS AND REMOVAL

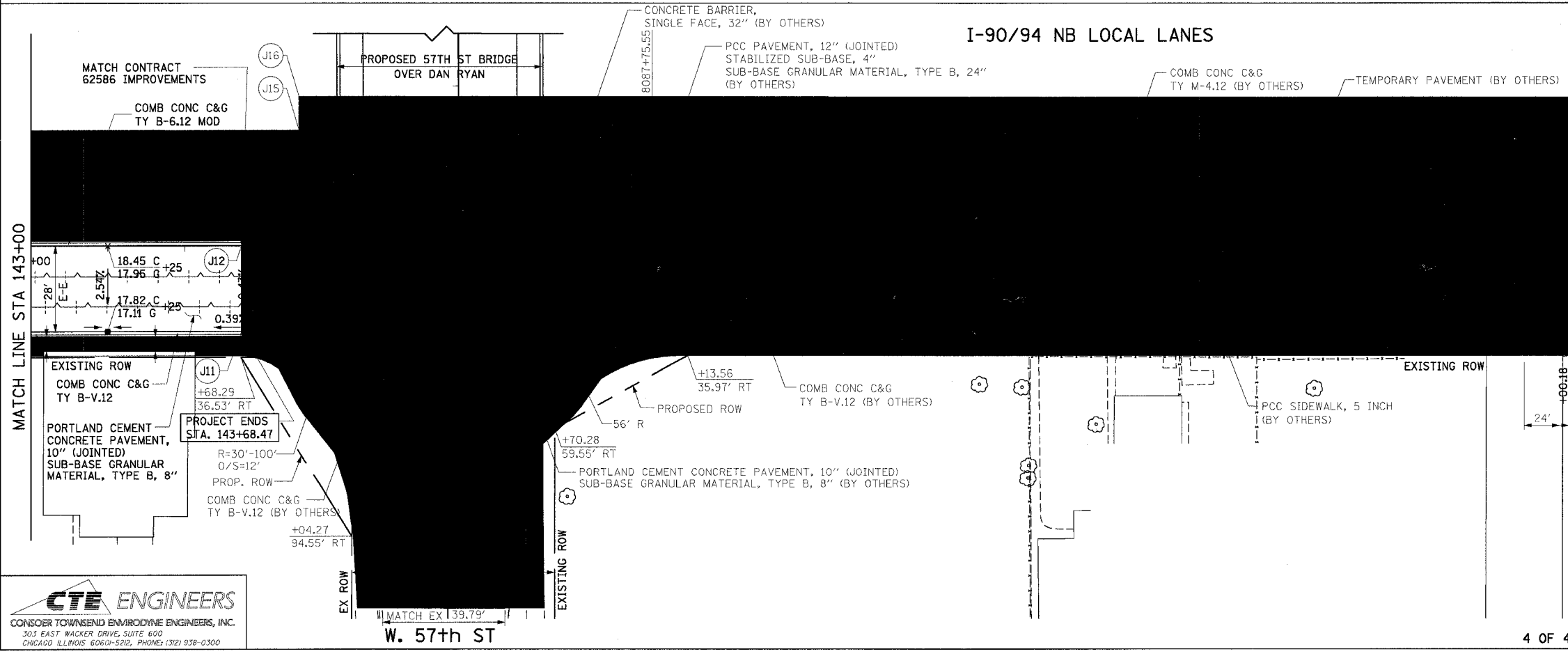

- LEGEND:**
- TEMPORARY PAVEMENT
 - WORK TO BE DONE BY OTHERS

- NOTES:**
1. CONTRACTOR SHALL COORDINATE WITH CONTRACT 62796 FOR SIDEWALK AND DRIVEWAY IMPROVEMENTS.
 2. CONTRACTOR SHALL COORDINATE WITH CONTRACT 62586 FOR RETAINING WALL AND FRONTAGE ROAD IMPROVEMENTS.

PT.	STATION	OFFSET	PT.	STATION	OFFSET
J1	143+99.65	15.00' RT	J9	144+12.76	94.58' RT
J2	143+99.67	0.83' LT	J10	143+92.26	39.73' RT
J3	144+66.67	0.74' LT	J11	143+68.47	28.00' RT
J4	144+66.65	15.00' RT	J12	143+68.47	0.00' RT
J5	145+11.01	28.00' RT	J13	8086+60.64	2.41' RT
J6	144+55.03	82.55' RT	J14	8086+60.64	16.00' LT
J7	144+54.11	117.84' RT	J15	8086+60.57	29.51' LT
J8	144+14.32	117.78' RT	J16	8086+60.51	40.40' LT

REVISIONS	
NAME	DATE

ILLINOIS DEPARTMENT OF TRANSPORTATION
 F.A.I. 90/94 (DAN RYAN EXPRESSWAY)
 59th ST TO 57th ST (WENTWORTH AVENUE)

EXISTING AND PROPOSED ROADWAY PLANS
 WENTWORTH AVENUE

SCALE: 1"=20'
 DATE: OCTOBER 29, 2004

DRAWN BY: AMM
 CHECKED BY: JAL



m:\p\0468\civil\90-94\add_crr\90-94\roadway_plans\909201042a.dwg