

F.A.I. RTE.	SECTION	COUNTY	TOTAL SHEETS	SHEET NO.
90/94	2004-075RS	COOK	65	31
STA. 128+00		TO STA. 133+00		
FED. ROAD DIST. NO. 1		ILLINOIS FED. AID PROJECT		62814

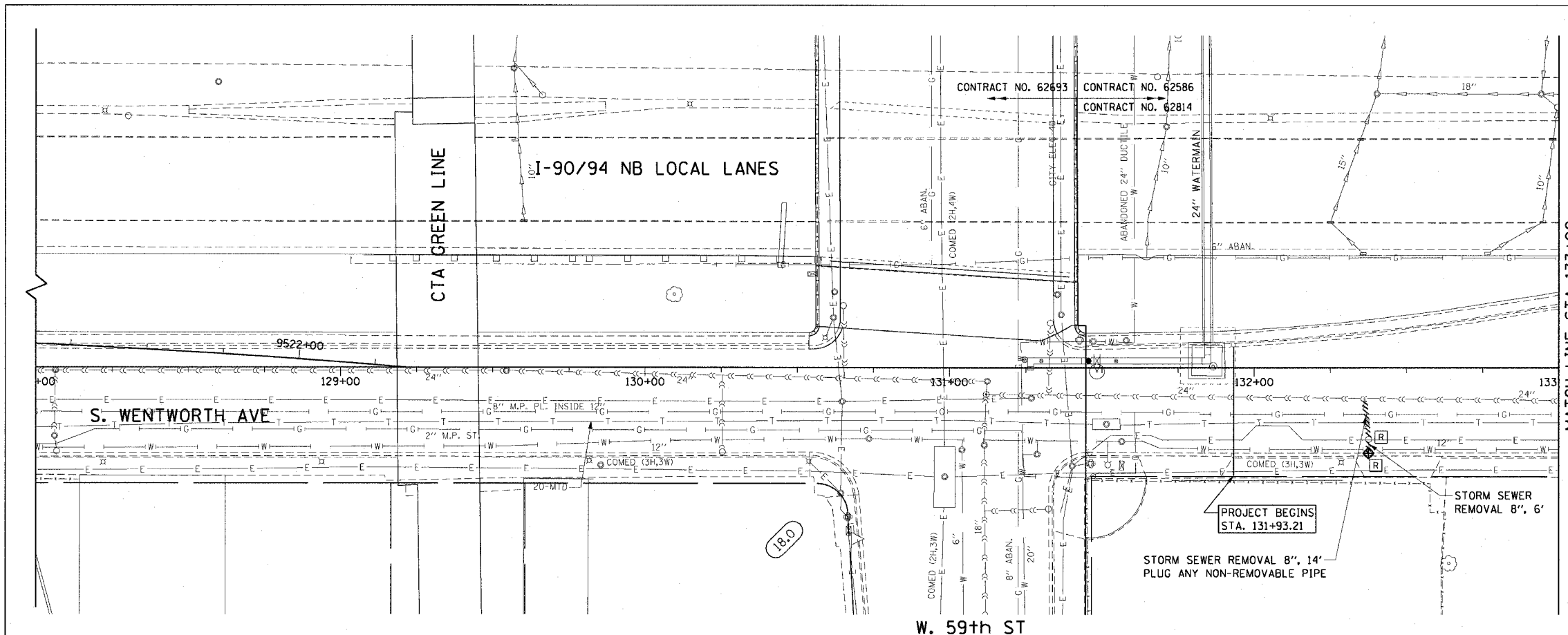

- LEGEND: EXISTING**
- INLET
 - o CATCH BASIN
 - o MANHOLE
 - STORM SEWER
 - COMBINED SEWER
 - PIPE UNDERDRAIN
 - [R] STRUCTURE TO BE REMOVED
 - [AD] STRUCTURE TO BE ADJUSTED
 - //// STORM SEWER REMOVAL
 - //// COMBINED SEWER REMOVAL

NOTE:
ALL EXISTING OPEN LID DRAINAGE STRUCTURES TO REMAIN THRU STAGE 1 SHALL HAVE INLET FILTERS INSTALLED.

EXISTING CONDITIONS AND REMOVAL

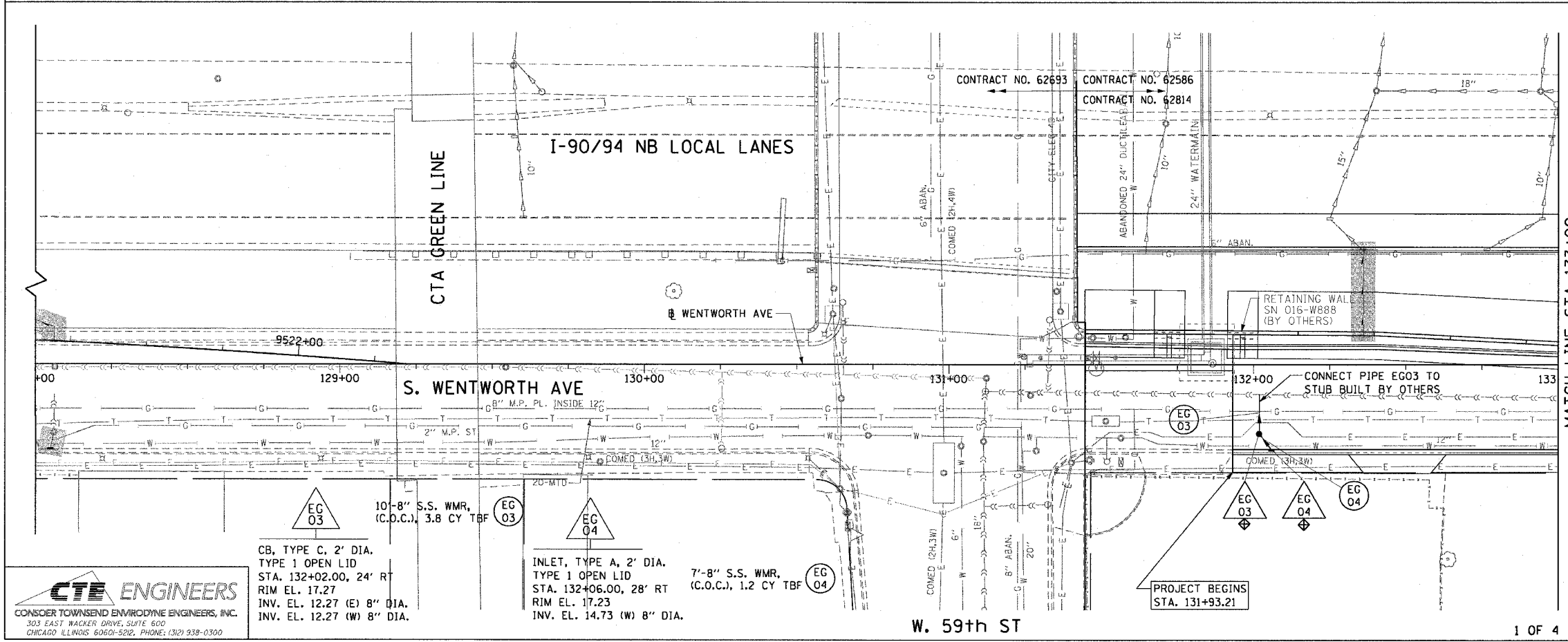

- LEGEND: PROPOSED**
- INLET
 - o CATCH BASIN
 - o MANHOLE
 - STORM SEWER
 - COMBINED SEWER
 - PIPE UNDERDRAIN
 - PROPOSED SWALE
 - (EA 01) PROPOSED STORM SEWER PIPE
 - (EA 01) PROPOSED STRUCTURE
 - WORK TO BE DONE BY OTHERS

NOTES:

- SEE DRAINAGE SCHEDULES FOR STRUCTURE AND PIPE INFORMATION.
- INLET FILTERS TO BE INSTALLED ON ALL PROPOSED DRAINAGE STRUCTURES.

- EC 03 10'-8" S.S. WMR, (C.O.C.), 3.8 CY TBF
- EC 03 CB, TYPE C, 2' DIA. TYPE 1 OPEN LID STA. 132+02.00, 24' RT RIM EL. 17.27 INV. EL. 12.27 (E) 8" DIA. INV. EL. 12.27 (W) 8" DIA.
- EC 04 INLET, TYPE A, 2' DIA. TYPE 1 OPEN LID STA. 132+06.00, 28' RT RIM EL. 17.23 INV. EL. 14.73 (W) 8" DIA.
- EC 04 7'-8" S.S. WMR, (C.O.C.), 1.2 CY TBF

CTE ENGINEERS
CONSER TOWNSEND ENVIRONMENTAL ENGINEERS, INC.
303 EAST WACKER DRIVE, SUITE 600
CHICAGO, ILLINOIS 60601-5022, PHONE: (312) 938-0300

REVISIONS	
NAME	DATE

ILLINOIS DEPARTMENT OF TRANSPORTATION
F.A.I. 90/94 (DAN RYAN EXPRESSWAY)
59th ST TO 57th ST (WENTWORTH AVENUE)

**DRAINAGE AND UTILITY PLANS
WENTWORTH AVENUE**

SCALE: 1"=20'
DATE: OCTOBER 29, 2004

DRAWN BY: JB
CHECKED BY: EBY

M:\940468\Civil\4-Civil\94add_Chr_9820.ssh\Drainage\092010\21.dwg