

F.A.I. NO.	SECTION	COUNTY	TOTAL SHEETS	SHEET NO.
90/94	2004-099TS	COOK	65	27
STA.	TO STA.			
FED. ROAD DIST. NO. 1		ILLINOIS	FED. AID PROJECT	
62840				

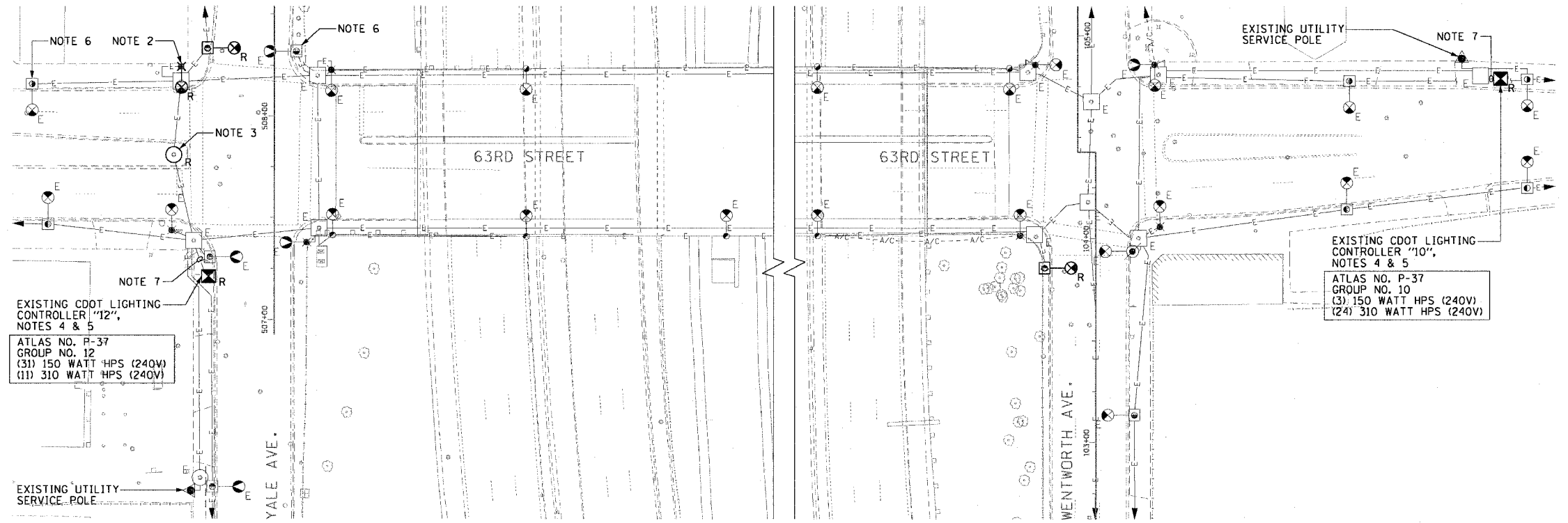

EXISTING CONDITIONS AND DEMOLITION
(NOTES 8 & 12)

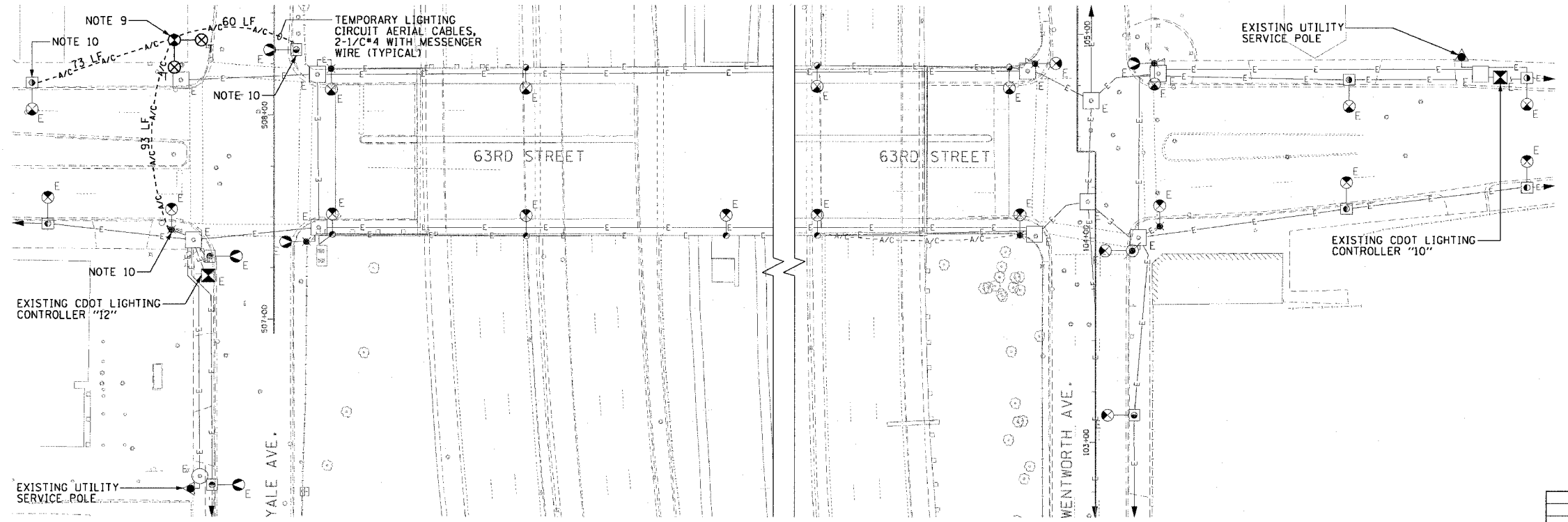

TEMPORARY LIGHTING PLAN (STAGE 1 & STAGE 2)
(NOTES 8, 11, 12, & 14)

- NOTES:**
- SEE DRAWINGS E-1 AND E-2 FOR CDOT ELECTRICAL GENERAL NOTES, SYMBOLS, AND ABBREVIATIONS.
 - REMOVAL AND SALVAGE OF LUMINAIRES AND MAST ARMS MOUNTED ON COMBINATION TRAFFIC SIGNAL/STREET LIGHTING POLES WILL BE MEASURED OR COUNTED FOR PAYMENT UNDER THE APPROPRIATE TRAFFIC SIGNAL PAY ITEM. REFER TO THE TRAFFIC SIGNAL PLANS.
 - REMOVAL OF EXISTING HANDHOLE WILL BE COUNTED FOR PAYMENT UNDER THE APPROPRIATE TRAFFIC SIGNAL PAY ITEM. REFER TO THE TRAFFIC SIGNAL PLANS FOR DETAILS.
 - EXISTING CDOT LIGHTING CONTROLLER MUST REMAIN IN OPERATION UNTIL THE PROPOSED LIGHTING CONTROLLER IS INSTALLED, TESTED, AND ACCEPTED. SEE DRAWING E-4 FOR PROPOSED LIGHTING CONTROLLER LOCATION.
 - REMOVE THE EXISTING SERVICE FEED CABLES FROM THE EXISTING CDOT LIGHTING CONTROLLER BACK TO THE EXISTING SERVICE LOCATION SHOWN ON THIS DRAWING. THIS WORK IS INCLUDED IN THE "REMOVE EXISTING LIGHTING CONTROLLER AND SALVAGE" PAY ITEM.
 - DISCONNECT EXISTING LIGHTING CIRCUIT CABLES LOCATED IN THE BASE OF THE EXISTING LIGHTING UNIT AND REMOVE FROM CONDUIT BACK TO THE NEAREST SPLICE.
 - DISCONNECT EXISTING LIGHTING CIRCUIT CABLES LOCATED IN THE BASE OF THE EXISTING LIGHTING CONTROLLER CABINET, PULL BACK TO EXISTING MANHOLE, AND COIL FOR REUSE.
 - CONTRACTOR IS RESPONSIBLE FOR THE MAINTENANCE OF THE EXISTING LIGHTING SYSTEMS SHOWN ON THIS DRAWING. NO LIGHTING EQUIPMENT MAY BE REMOVED UNTIL SUCH TIME AS THE TEMPORARY LIGHTING EQUIPMENT IS INSTALLED, TESTED, AND ACCEPTED.
 - WOOD POLES FOR TEMPORARY TRAFFIC SIGNAL/LIGHTING WILL BE COUNTED FOR PAYMENT UNDER THE APPROPRIATE TRAFFIC SIGNAL PAY ITEM. REFER TO THE TRAFFIC SIGNAL PLANS.
 - SPLICE TEMPORARY LIGHTING CIRCUIT AERIAL CABLES TO EXISTING LIGHTING CIRCUIT CABLES LOCATED AT EXISTING LIGHTING UNIT.
 - SEE DRAWING E-14 FOR TEMPORARY LIGHTING DETAILS.
 - COORDINATE ALL ELECTRICAL WORK WITH CIVIL WORK, TRAFFIC SIGNAL WORK, SUGGESTED STAGES OF CONSTRUCTION, TRAFFIC CONTROL PLANS, AND IDOT CONTRACT NOS. 62693 AND 62842.
 - ONCE THE PERMANENT LIGHTING SYSTEM IS INSTALLED, TESTED, AND ACCEPTED, THE CONTRACTOR MUST REMOVE ALL TEMPORARY LIGHTING LUMINAIRES, MAST ARMS, AND AERIAL CABLES. THIS REMOVAL MUST BE COORDINATED WITH THE REMOVAL OF THE TEMPORARY TRAFFIC SIGNALS. REFER TO THE TRAFFIC SIGNAL PLANS.

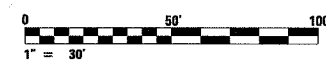

E-3

REVISIONS	
NAME	DATE

ILLINOIS DEPARTMENT OF TRANSPORTATION
F.A.I. 90/94 (DAN RYAN EXPRESSWAY)
TRAFFIC SIGNALS AT 63RD STREET AND
WENTWORTH AVENUE/ WELLS STREET
63RD STREET BRIDGE
EXISTING CONDITIONS, DEMOLITION,
AND TEMPORARY LIGHTING PLAN

SCALE: 1"=30' DRAWN BY: HAR
DATE: November 05, 2004 CHECKED BY: WDS



11/04/2004 09:01:29 AM