

F.A.I. RTE.	SECTION	COUNTY	TOTAL SHEETS	SHEET NO.
94	1516.1-I-1	COOK	195	44
STA. 2016+35		TO STA. 2353+03		
FED. ROAD DIST. NO.	ILLINOIS	FED. AID PROJECT		
		62872		

MATCHLINE NB STA. 2261+00

MATCHLINE NB STA. 2267+00

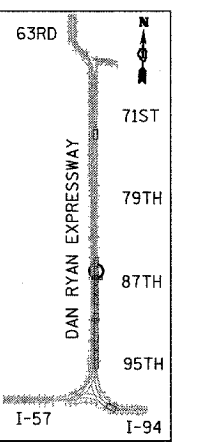
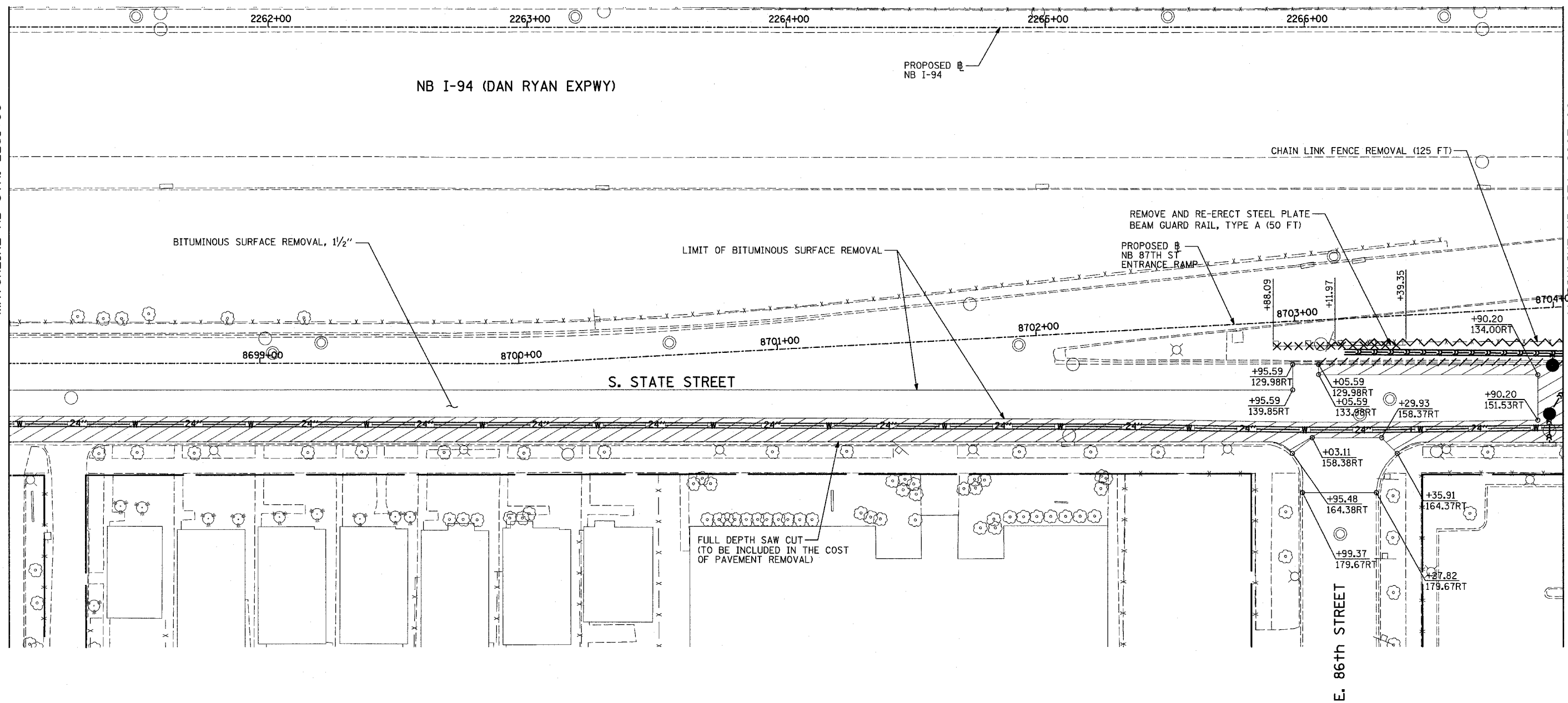

LOCATION MAP

**TYLIN** INTERNATIONAL

- NOTES:**
- SEE SEPARATE PLANS FOR WATER MAIN INSTALLATION DETAILS.
  - SEE SEPARATE PLANS FOR SEWER INSTALLATION DETAILS
  - ALL STATION/OFFSET/RADIUS CALLOUTS MEASURED TO EDGE OF PAVEMENT UNLESS OTHERWISE NOTED.
  - STATIONS AND OFFSETS MEASURED FROM MAINLINE ALIGNMENT.

**LEGEND:**

	PAVEMENT REMOVAL
	PAVED SHOULDER REMOVAL
	SIDEWALK REMOVAL
	DRIVEWAY REMOVAL
	COMB CONC CURB & GUTTER REMOVAL
	CHAIN LINK FENCE REMOVAL
	RETAINING WALL/GUARDRAIL REMOVAL
	TREE REMOVAL (UNITS) (NO UNIT SHOWN = <6)
	LIGHT POLE & FOUNDATION REMOVAL
	STATION/OFFSET

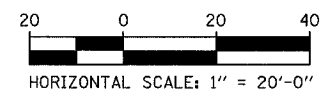

REVISIONS	
NAME	DATE

ILLINOIS DEPARTMENT OF TRANSPORTATION  
**F.A.I. 94 (DAN RYAN EXPRESSWAY)**  
**EXISTING PLAN - STATE ST.**  
**NB I-94 STA. 2261+00 TO 2267+00**

SCALE: 1"=20'  
DATE: OCTOBER 4, 2004

DRAWN BY: JJS  
CHECKED BY: MAG