

MATCHLINE NB STA. 2267+00

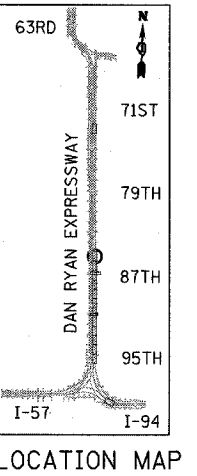
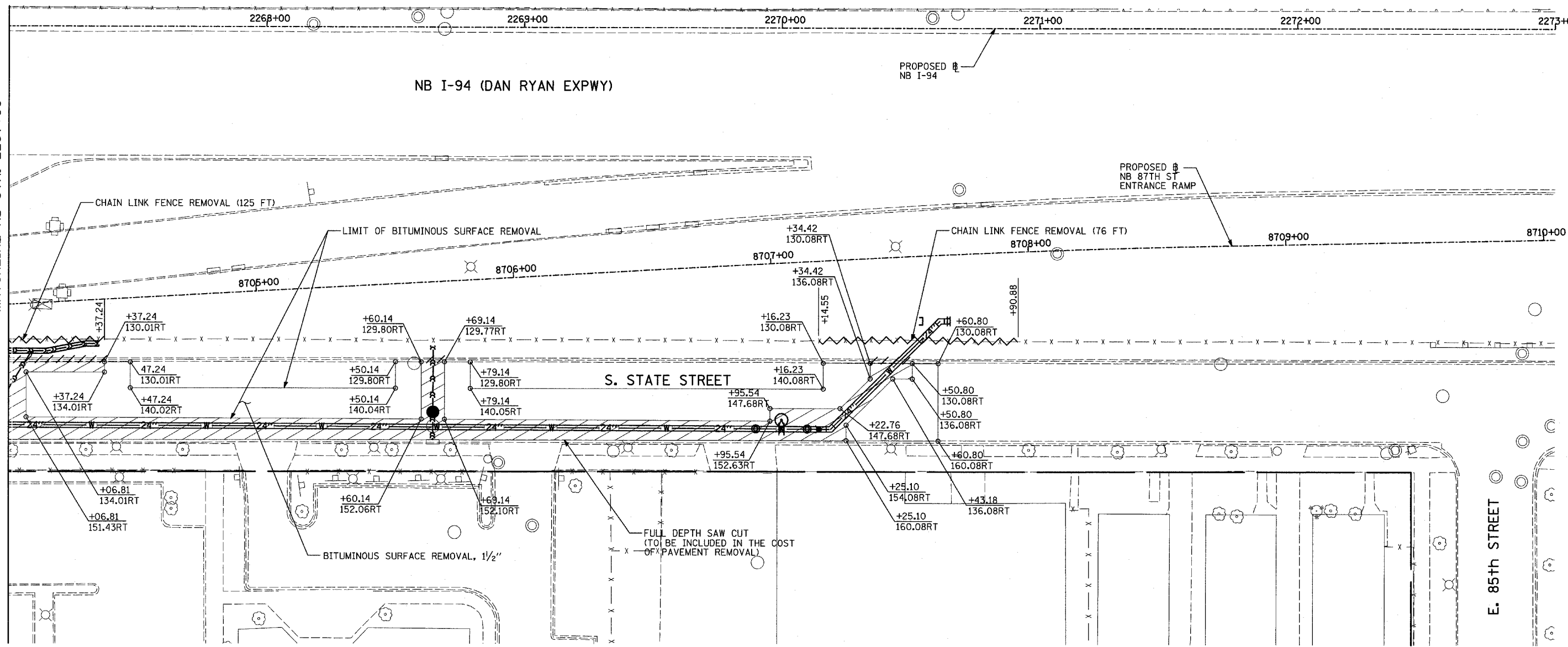

**LEGEND:**

- PAVEMENT REMOVAL
- PAVED SHOULDER REMOVAL
- SIDEWALK REMOVAL
- DRIVEWAY REMOVAL
- COMB CONC CURB & GUTTER REMOVAL
- CHAIN LINK FENCE REMOVAL
- RETAINING WALL/GUARDRAIL REMOVAL
- TREE REMOVAL (UNITS) (NO UNIT SHOWN = 6)
- LIGHT POLE & FOUNDATION REMOVAL
- +XX.XX STATION/OFFSET
- XX.XXRT

**NOTES:**

- SEE SEPARATE PLANS FOR WATER MAIN INSTALLATION DETAILS.
- SEE SEPARATE PLANS FOR SEWER INSTALLATION DETAILS
- ALL STATION/OFFSET/RADIUS CALLOUTS MEASURED TO EDGE OF PAVEMENT UNLESS OTHERWISE NOTED.
- STATIONS AND OFFSETS MEASURED FROM MAINLINE ALIGNMENT.

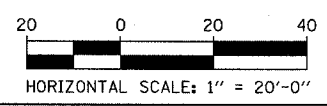

REVISIONS	
NAME	DATE

ILLINOIS DEPARTMENT OF TRANSPORTATION  
 F.A.I. 94 (DAN RYAN EXPRESSWAY)  
 EXISTING PLAN - STATE ST.  
 NB I-94 STA. 2267+00 TO 2273+00

SCALE: 1"=20'  
 DATE: OCTOBER 4, 2004

DRAWN BY: JJS  
 CHECKED BY: MAG

**TYLIN** INTERNATIONAL

1/12/2004 07:59:48 AM