

F.A.I. RTE.	SECTION	COUNTY	TOTAL SHEETS	SHEET NO.
94	1516.1-I-1	COOK	195	49
STA. 2016+35		TO STA. 2353+03		
FED. ROAD DIST. NO.	ILLINOIS	FED. AID PROJECT		

62872

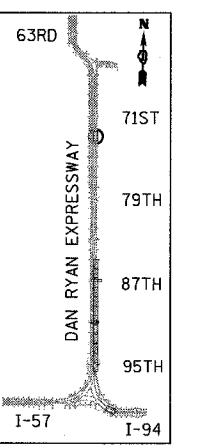
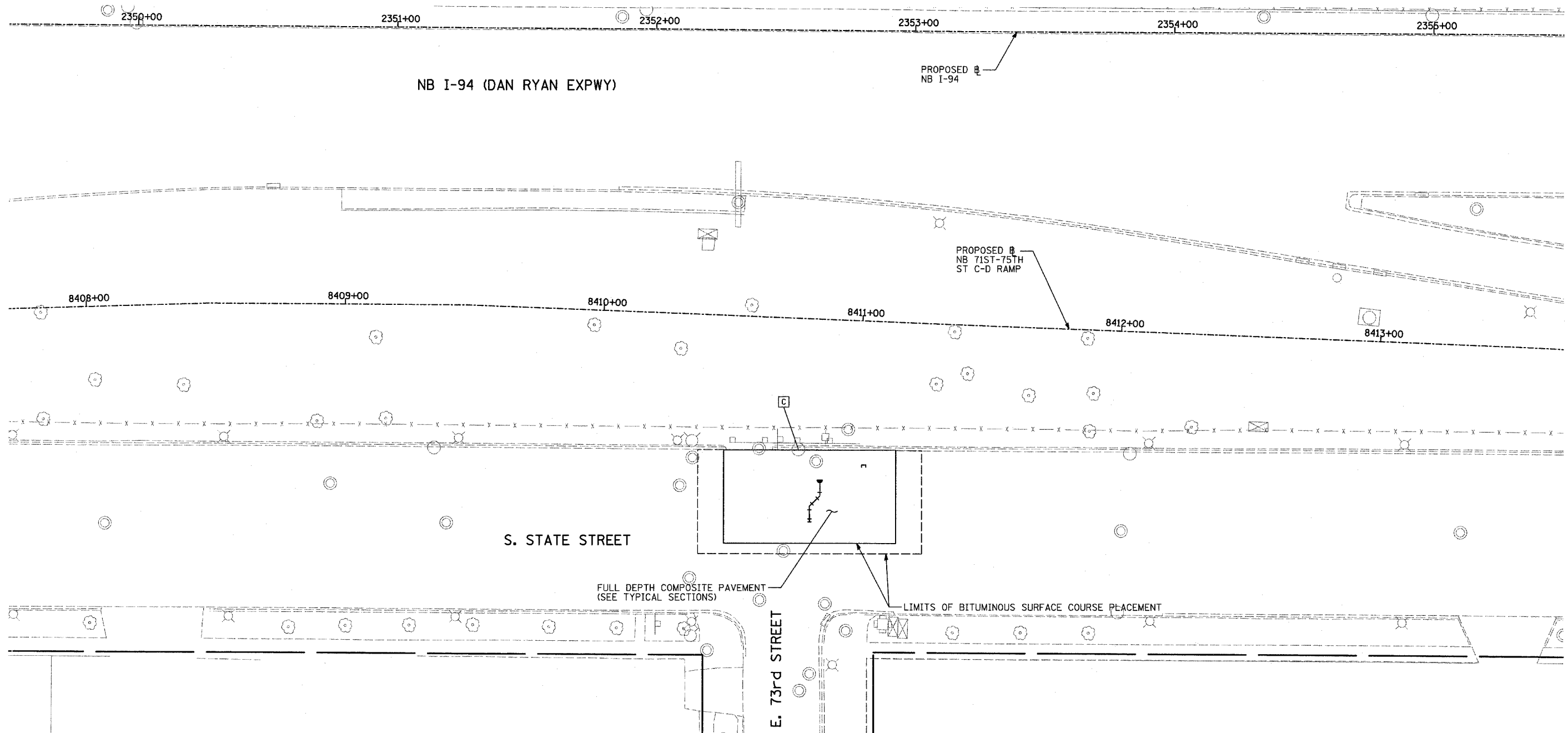

LOCATION MAP

LEGEND:

- [C] STRUCTURE TO BE CLEANED
- [A] FRAME AND GRATE TO BE ADJUSTED
- +XX.XX
XX.XXRT STATION/OFFSET

NOTES:

1. SEE SEPARATE PLANS FOR WATER MAIN INSTALLATION DETAILS.
2. SEE SEPARATE PLANS FOR SEWER INSTALLATION DETAILS
3. ALL STATION/OFFSET/RADIUS CALLOUTS MEASURED TO EDGE OF PAVEMENT UNLESS OTHERWISE NOTED.
4. STATIONS AND OFFSETS MEASURED FROM MAINLINE ALIGNMENT.

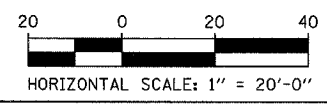

REVISIONS	
NAME	DATE

ILLINOIS DEPARTMENT OF TRANSPORTATION
F.A.I. 94 (DAN RYAN EXPRESSWAY)
PROPOSED PLAN - STATE ST.
NB I-94 STA. 2349+50 TO 2355+50

SCALE: 1"=20'
DATE: OCTOBER 4, 2004

DRAWN BY: JJS
CHECKED BY: MAG

TYLININTERNATIONAL

11/12/2004 08:00:34 AM