

FURNISHING TEMPORARY CONCRETE BARRIER  
DETAIL

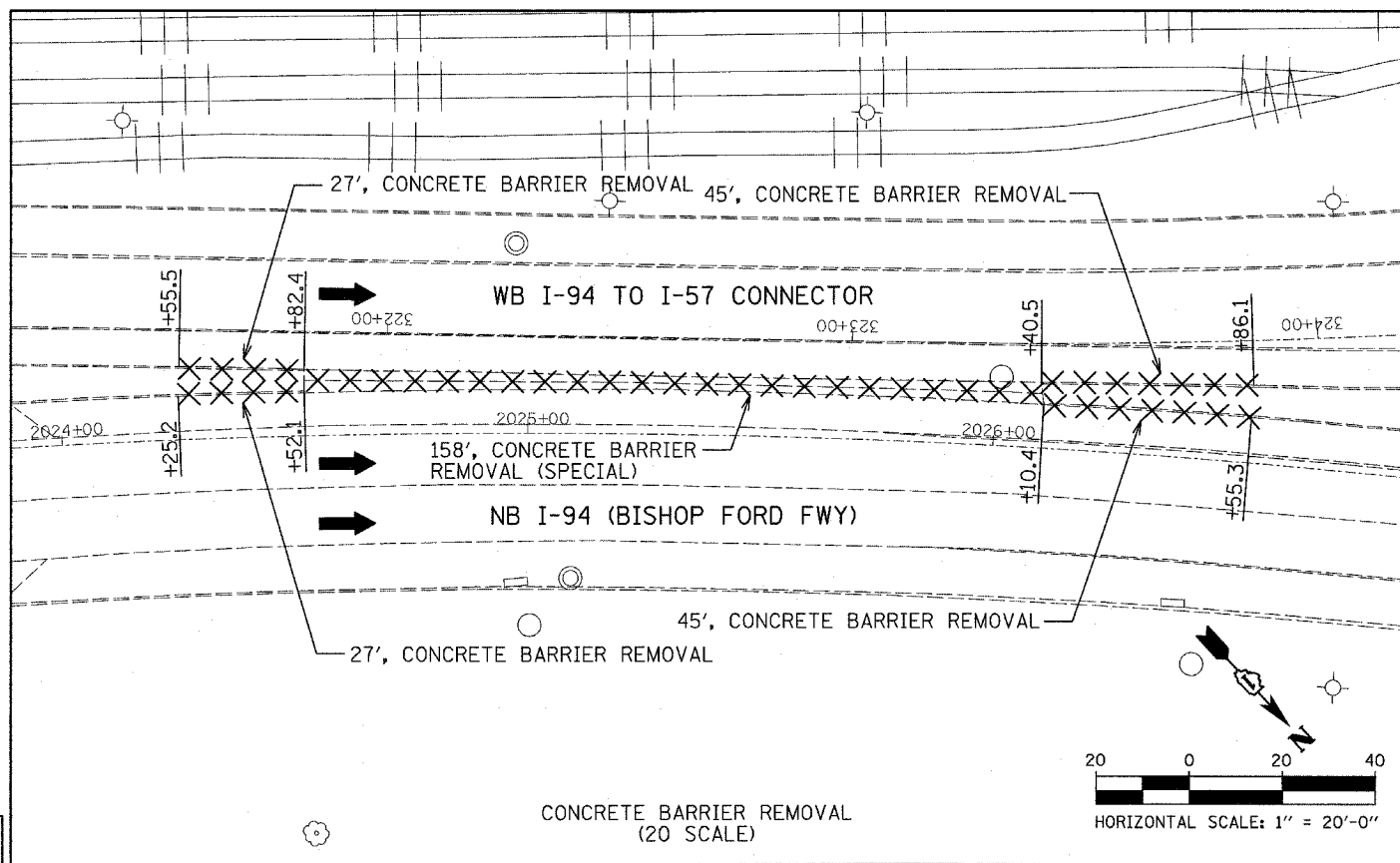

CONCRETE BARRIER REMOVAL  
DETAIL

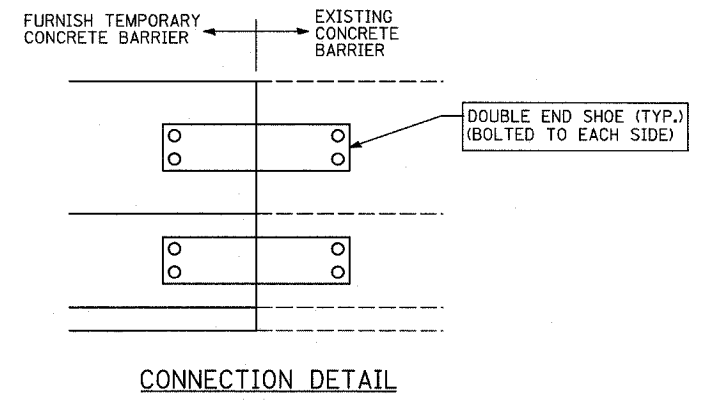
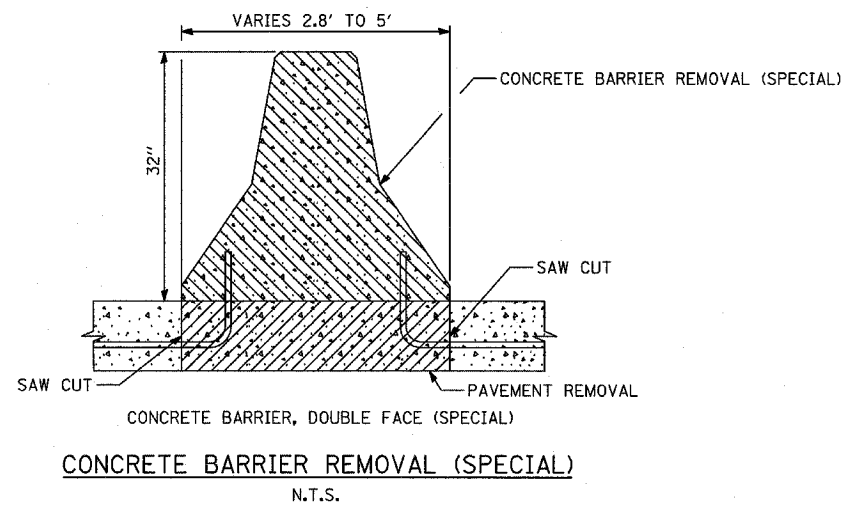
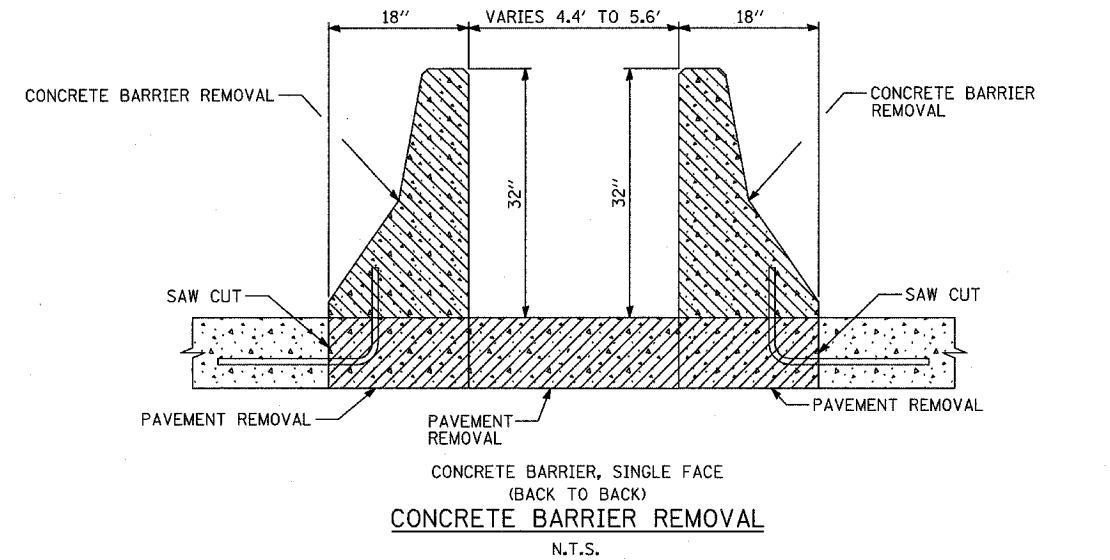

**NOTES:**

TEMPORARY CONCRETE BARRIER SHALL BE SECURED TO THE PAVEMENT WITH DOWEL BARS ACCORDING TO ARTICLE 704.06 OF THE STANDARD SPECIFICATION.

TEMPORARY CONCRETE BARRIER SHALL BE INSTALLED SO THE FULL SHOULDER WIDTH FOR NB I-94 IS MAINTAINED.

REVISIONS	
NAME	DATE

ILLINOIS DEPARTMENT OF TRANSPORTATION  
F.A.I. 94 (DAN RYAN EXPRESSWAY)  
BARRIER REMOVAL  
FURNISHING TEMPORARY CONCRETE BARRIER  
AT JUNCTION CHAMBERS #71 & #72

SCALE: NO SCALE  
DATE: OCTOBER 4, 2004  
DRAWN BY: JPA  
CHECKED BY: JPM