

F.A.I. RTE.	SECTION	COUNTY	TOTAL SHEETS	SHEET NO.
94	1516.1-I-1	COOK	195	61
STA. 2016+35		TO STA. 2353+03		
FED. ROAD DIST. NO.	ILLINOIS	FED. AID PROJECT	62872	

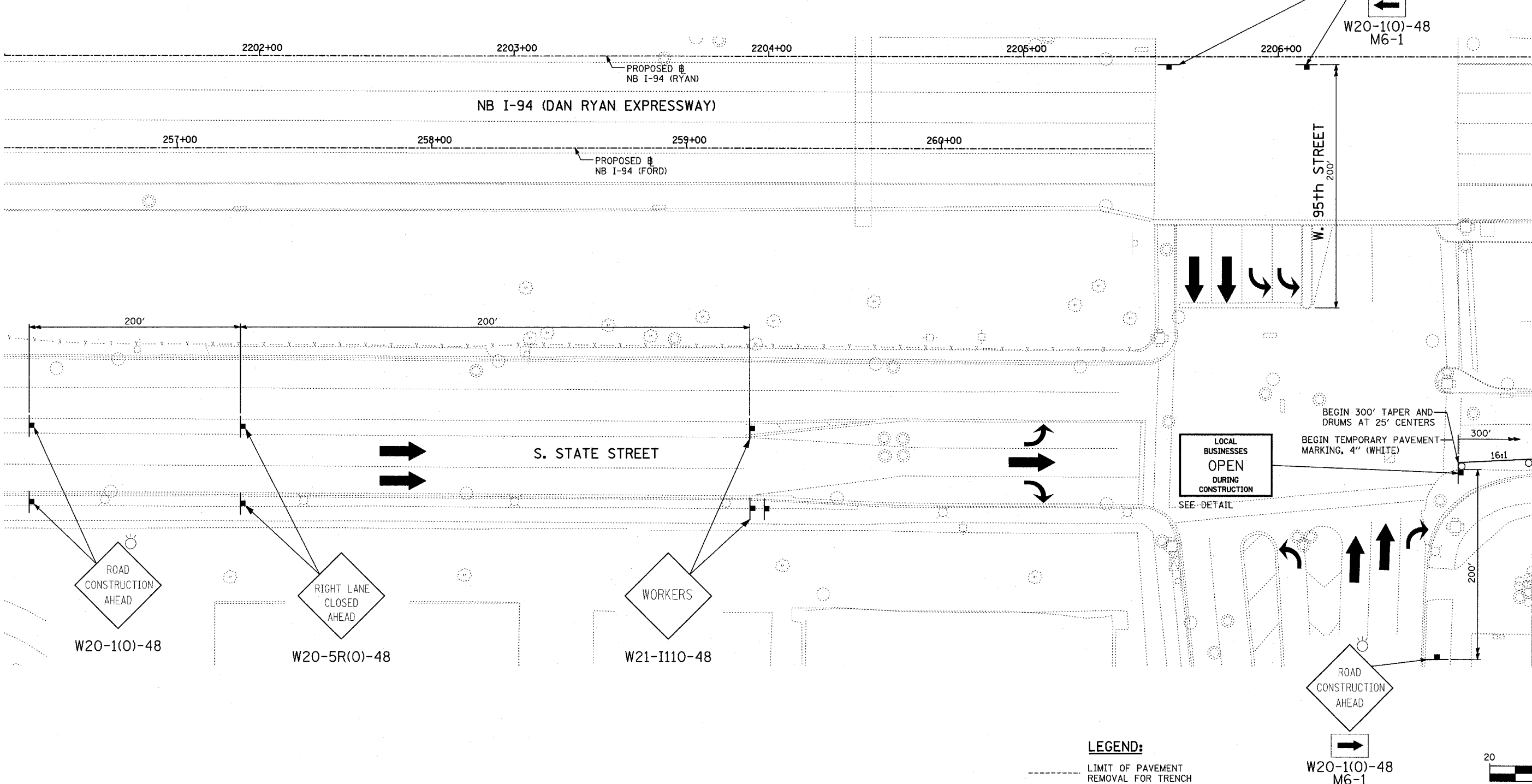

MATCHLINE NB STA. 2207+00.00

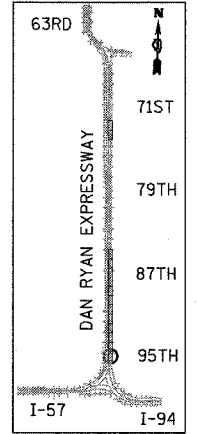

LOCATION MAP

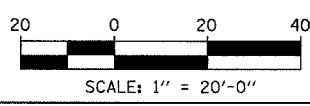

**LEGEND:**

- LIMIT OF PAVEMENT REMOVAL FOR TRENCH
- TRAFFIC LANE
- WORK ZONE
- BARRICADE, TYPE III
- DRUM WITH MONO-DIRECTIONAL STEADY BURNING LIGHT
- ARROW BOARD

REVISIONS	
NAME	DATE

ILLINOIS DEPARTMENT OF TRANSPORTATION  
 F.A.I. 94 (DAN RYAN EXPRESSWAY)  
 MAINTENANCE OF TRAFFIC  
 NB I-94 STA. 2201+00 TO 2207+00  
 (STAGE 2 SHEET 1 OF 4)

SCALE: 1"=20'  
 DATE: OCTOBER 4, 2004

DRAWN BY: JPA  
 CHECKED BY: MPG

**TYLIN** INTERNATIONAL