

F.A.I. RTE.	SECTION	COUNTY	TOTAL SHEETS	SHEET NO.
94	1516.1-I-1	COOK	195	62
STA. 2016+35		TO STA. 2353+03		
FED. ROAD DIST. NO.	ILLINOIS FED. AID PROJECT			

62872

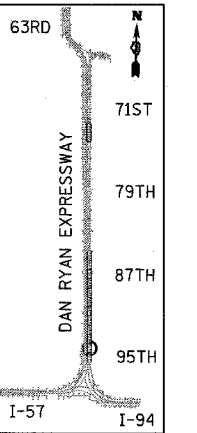
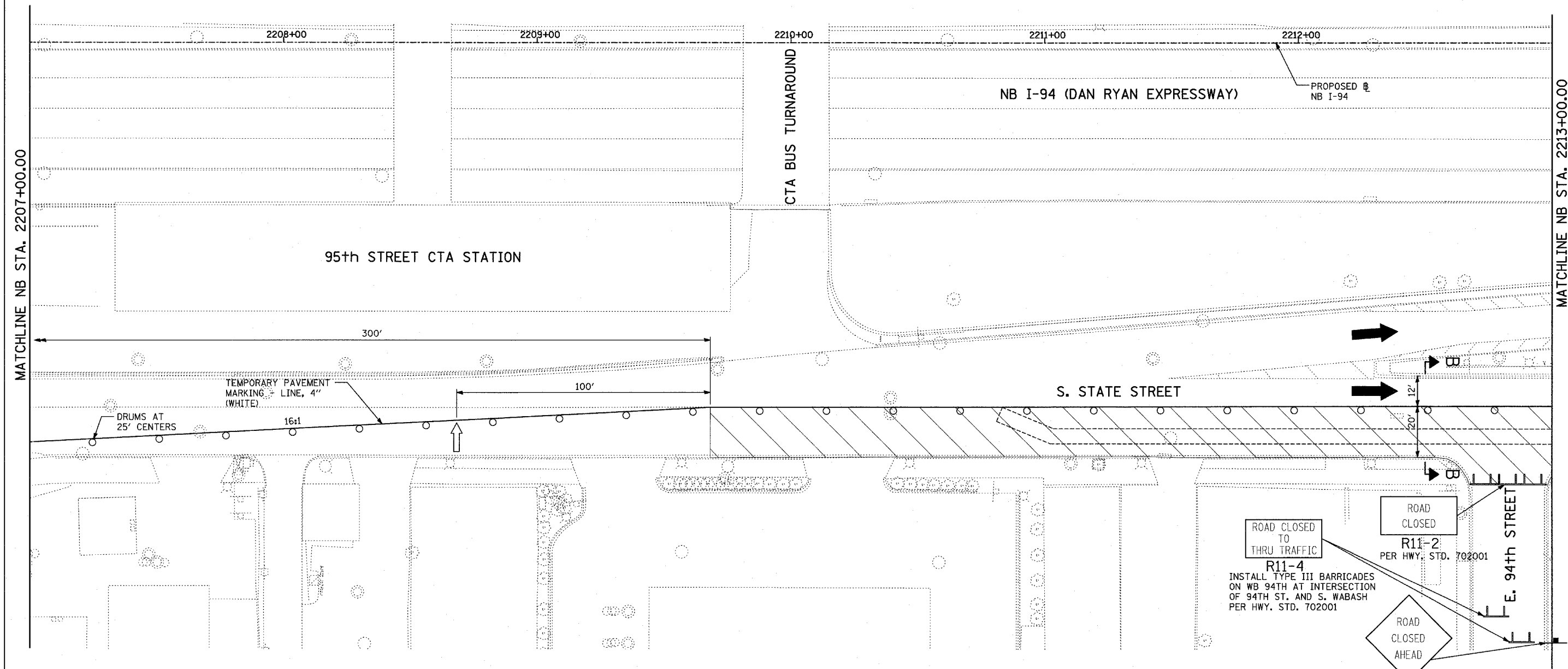

LEGEND:

- LIMIT OF PAVEMENT REMOVAL FOR TRENCH
- TRAFFIC LANE
- WORK ZONE
- BARRICADE, TYPE III
- DRUM WITH MONO-DIRECTIONAL STEADY BURNING LIGHT
- ARROW BOARD

R11-4
 INSTALL TYPE III BARRICADES ON WB 94TH AT INTERSECTION OF 94TH ST. AND S. WABASH PER HWY. STD. 702001

R11-2
 ROAD CLOSED PER HWY. STD. 702001

ROAD CLOSED AHEAD

W20-3(O)-48
 INSTALL SIGN AT NW CORNER OF INTERSECTION OF 94TH ST. AND S. WABASH

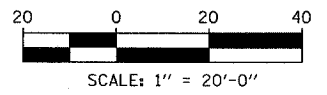

REVISIONS	
NAME	DATE

ILLINOIS DEPARTMENT OF TRANSPORTATION
 F.A.I. 94 (DAN RYAN EXPRESSWAY)
 MAINTENANCE OF TRAFFIC
 NB I-94 STA. 2207+00 TO 2213+00
 (STAGE 2 SHEET 2 OF 4)

SCALE: 1"=20'
 DATE: OCTOBER 4, 2004

DRAWN BY: JPA
 CHECKED BY: MPG

TYLIN INTERNATIONAL