

| | | | | |
|---------------------|------------|------------------|--------------|-----------|
| F.A.I. RTE. | SECTION | COUNTY | TOTAL SHEETS | SHEET NO. |
| 94 | 1516.1-I-1 | COOK | 195 | 91 |
| STA. 2016+35 | | TO STA. 2353+03 | | |
| FED. ROAD DIST. NO. | ILLINOIS | FED. AID PROJECT | | |

62872

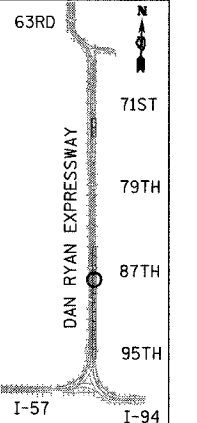

LOCATION MAP

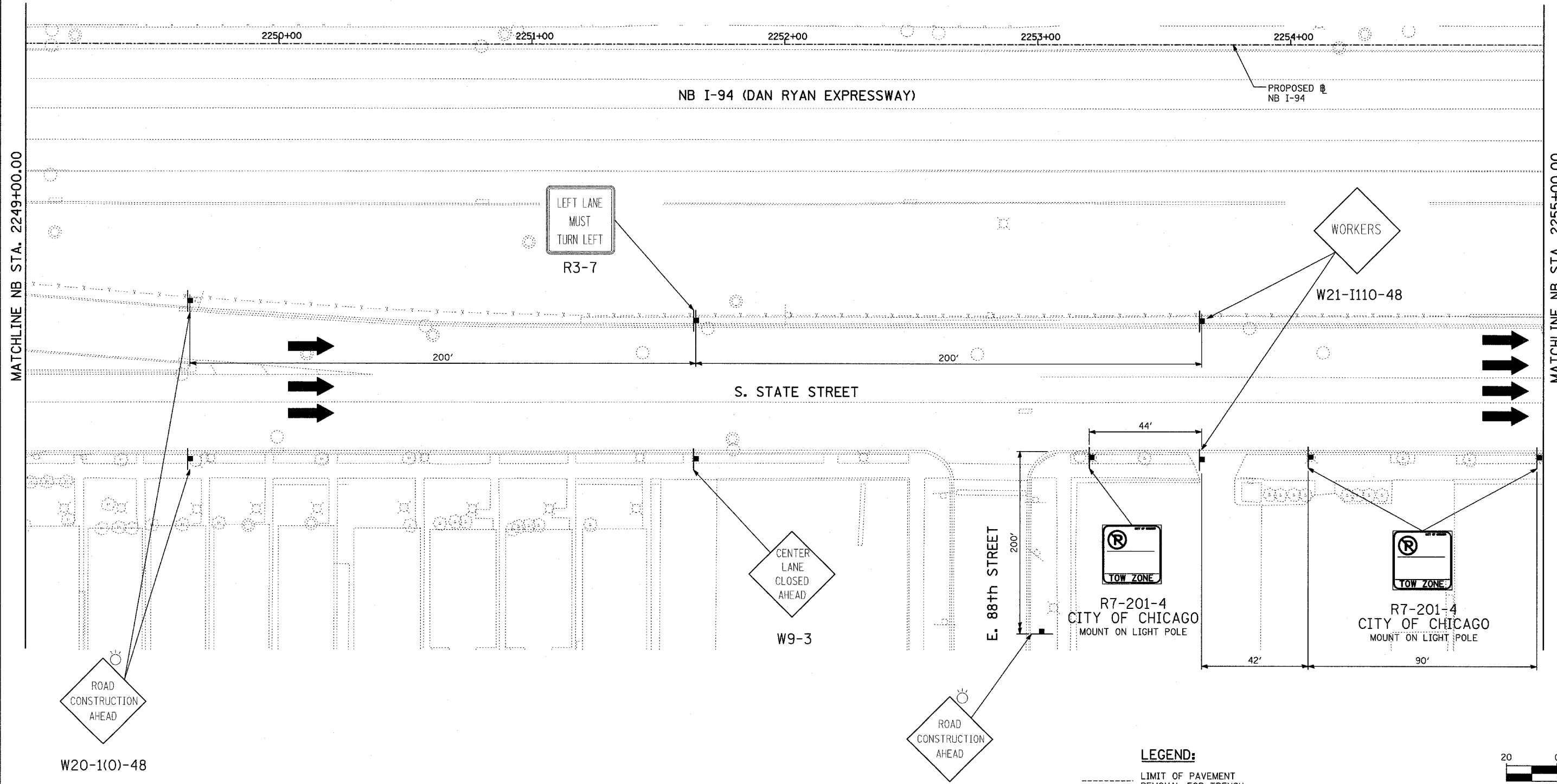
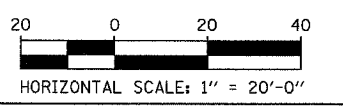

- LEGEND:**
- LIMIT OF PAVEMENT REMOVAL FOR TRENCH
 - TRAFFIC LANE
 - WORK ZONE
 - BARRICADE, TYPE III
 - DRUM WITH MONO-DIRECTIONAL STEADY BURNING LIGHT
 - ARROW BOARD

| REVISIONS | |
|-----------|------|
| NAME | DATE |
| | |
| | |
| | |
| | |
| | |
| | |
| | |
| | |
| | |
| | |

ILLINOIS DEPARTMENT OF TRANSPORTATION
 F.A.I. 94 (DAN RYAN EXPRESSWAY)
 MAINTENANCE OF TRAFFIC
 NB I-94 STA. 2249+00 TO 2255+00
 (STAGE 9 SHEET 1 OF 2)

SCALE: 1"=20'
 DATE: OCTOBER 4, 2004

DRAWN BY: JPA
 CHECKED BY: MPG

MATCHLINE NB STA. 2249+00.00

MATCHLINE NB STA. 2255+00.00

TYLIN INTERNATIONAL

11/12/2004 09:21:55 AM