

F.A.I. RTE.	SECTION	COUNTY	TOTAL SHEETS	SHEET NO.
94	1516.1-1-1	COOK	195	95
STA. 2016+35		TO STA. 2353+03		
FED. ROAD DIST. NO.	ILLINOIS FED. AID PROJECT			

62872

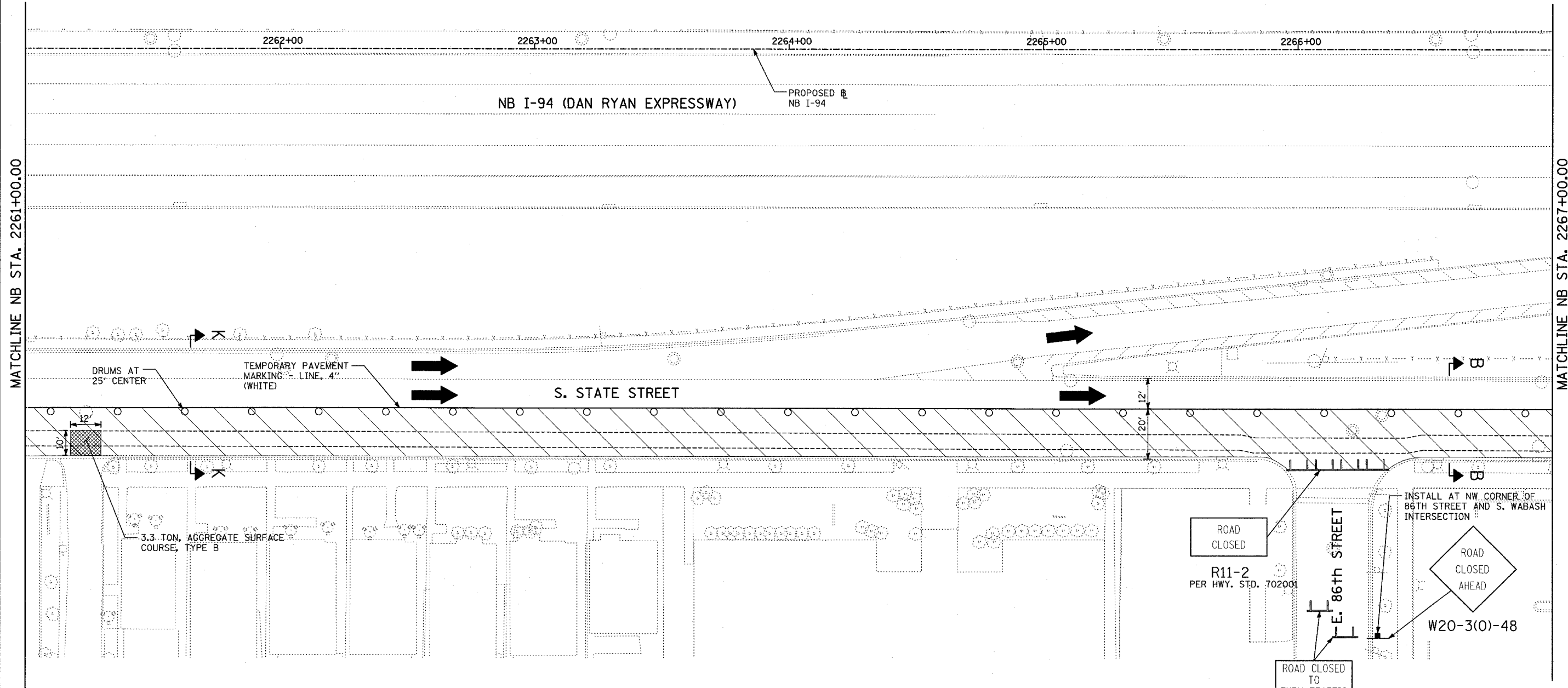

MATCHLINE NB STA. 2261+00.00

MATCHLINE NB STA. 2267+00.00

LEGEND:

- LIMIT OF PAVEMENT REMOVAL FOR TRENCH
- TRAFFIC LANE
- WORK ZONE
- BARRICADE, TYPE III
- DRUM WITH MONO-DIRECTIONAL STEADY BURNING LIGHT
- ARROW BOARD

ROAD CLOSED
R11-2
PER HWY. STD. 702001

ROAD CLOSED TO THRU TRAFFIC
R11-4

INSTALL TYPE III BARRICADES ON WB 94TH AT INTERSECTION OF 94TH ST. AND S. WABASH PER HWY. STD. 702001

INSTALL AT NW CORNER OF 86TH STREET AND S. WABASH INTERSECTION

ROAD CLOSED AHEAD
W20-3(O)-48

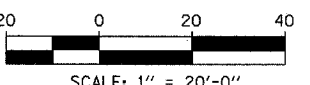

REVISIONS	
NAME	DATE

ILLINOIS DEPARTMENT OF TRANSPORTATION
F.A.I. 94 (DAN RYAN EXPRESSWAY)
MAINTENANCE OF TRAFFIC
NB I-94 STA. 2261+00 TO 2267+00
(STAGE 10 SHEET 3 OF 4)

SCALE: 1"=20'
DATE: OCTOBER 4, 2004
DRAWN BY: JPA
CHECKED BY: MPG

TYLIN INTERNATIONAL

11/12/2004 09:42:05 AM