

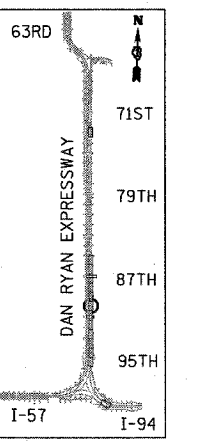

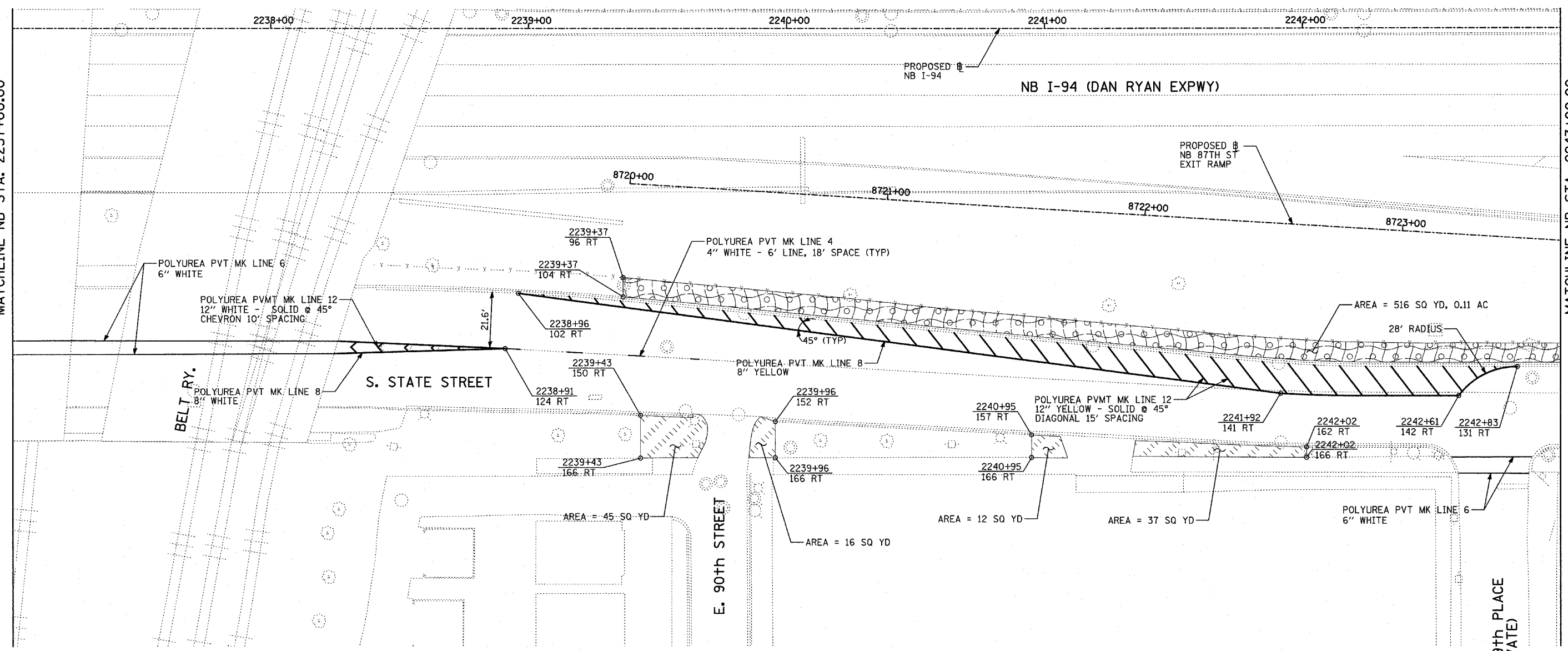

MATCHLINE NB STA. 2237+00.00

MATCHLINE NB STA. 2243+00.00

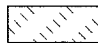

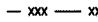
**LEGEND:**

-  SODDING, SALT TOLERANT, NITROGEN, PHOSPHORUS, AND POTASSIUM FERTILIZER NUTRIENTS, TOPSOIL FURNISH AND PLACE, 4"
-  EROSION CONTROL BLANKET, SEEDING, CLASS 2A, NITROGEN, PHOSPHORUS, AND POTASSIUM FERTILIZER NUTRIENTS, TOPSOIL FURNISH AND PLACE, 4"
-  PERIMETER EROSION BARRIER (PEB)
-  TEMPORARY FENCE
-  INLET FILTER, TO BE INSTALLED IN OFF PROJECT DRAINAGE STRUCTURES ACCEPTING STORMWATER RUNOFF

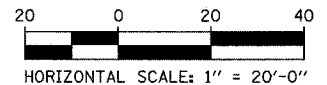

REVISIONS	
NAME	DATE

ILLINOIS DEPARTMENT OF TRANSPORTATION  
 F.A.I. 94 (DAN RYAN EXPRESSWAY)  
 EROSION CONTROL, LANDSCAPING,  
 & PAVEMENT MARKING  
 NB I-94 STA. 2237+00 TO 2243+00.00  
 SHEET 6 OF 14

SCALE: 1"=20'  
 DATE: OCTOBER 4, 2004

DRAWN BY: RTM  
 CHECKED BY: MPG

11/12/2004 07:44:34 AM