

F.A.I. RTE.	SECTION	COUNTY	TOTAL SHEETS	SHEET NO.
94	1516.1-I-1	COOK	195	112
STA. 2016+35		TO STA. 2353+03		
FED. ROAD DIST. NO.		ILLINOIS FED. AID PROJECT		

62872

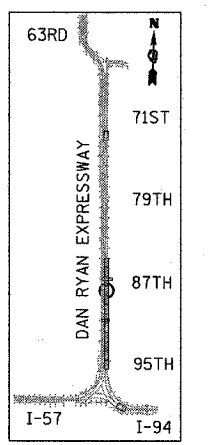
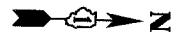
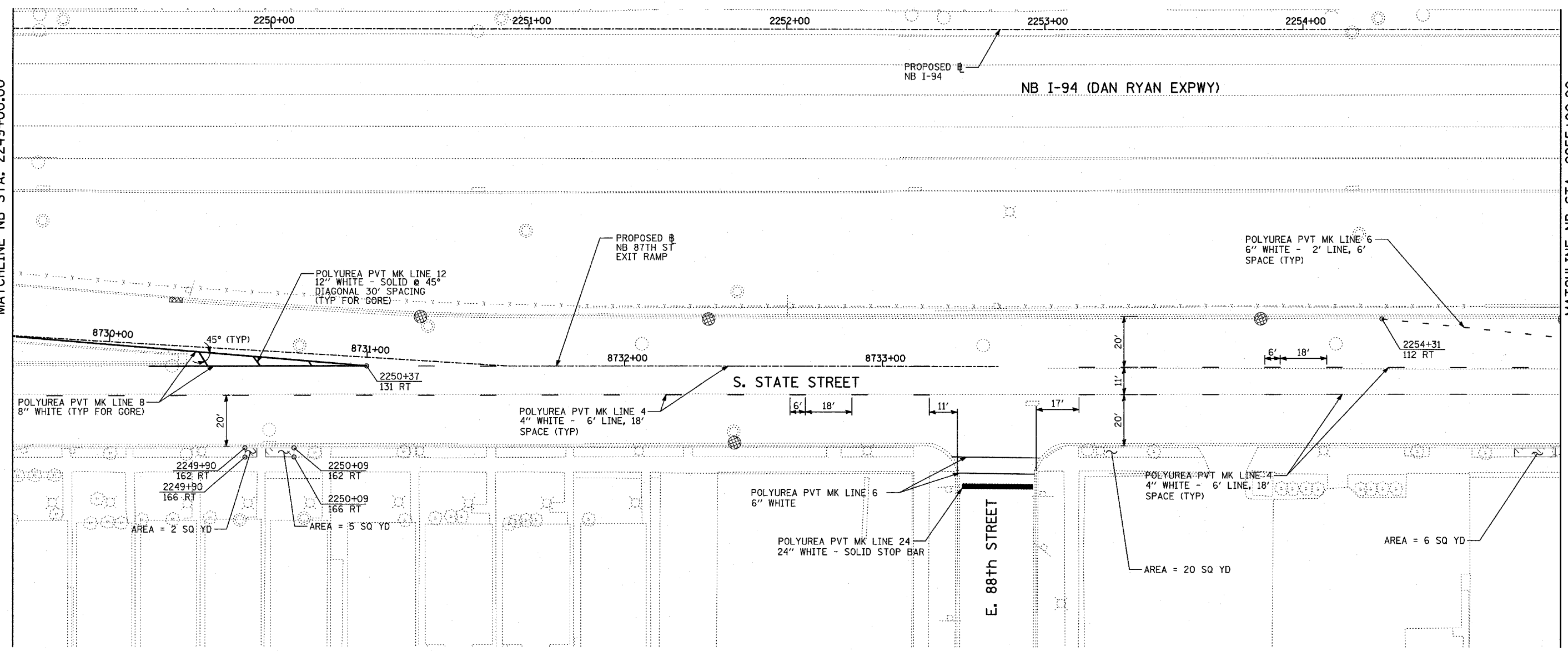

MATCHLINE NB STA. 2249+00.00

MATCHLINE NB STA. 2255+00.00

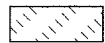

LOCATION MAP

**LEGEND:**

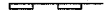
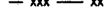
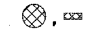
-  SODDING, SALT TOLERANT, NITROGEN, PHOSPHORUS, AND POTASSIUM FERTILIZER NUTRIENTS, TOPSOIL FURNISH AND PLACE, 4"
-  EROSION CONTROL BLANKET, SEEDING, CLASS 2A, NITROGEN, PHOSPHORUS, AND POTASSIUM FERTILIZER NUTRIENTS, TOPSOIL FURNISH AND PLACE, 4"
-  PERIMETER EROSION BARRIER (PEB)
-  TEMPORARY FENCE
-  INLET FILTER, TO BE INSTALLED IN OFF PROJECT DRAINAGE STRUCTURES ACCEPTING STORMWATER RUNOFF

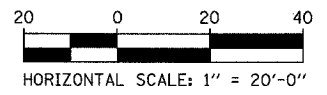

REVISIONS	
NAME	DATE

ILLINOIS DEPARTMENT OF TRANSPORTATION  
 F.A.I. 94 (DAN RYAN EXPRESSWAY)  
 EROSION CONTROL, LANDSCAPING,  
 & PAVEMENT MARKING  
 NB I-94 STA. 2249+00 TO 2255+00.00  
 SHEET 8 OF 14  
 SCALE: 1"=20'  
 DATE: OCTOBER 4, 2004  
 DRAWN BY: RTM  
 CHECKED BY: MPC

**TYLIN** INTERNATIONAL

11/12/2004 07:45:02 AM