

F.A.I. RTE.	SECTION	COUNTY	TOTAL SHEETS	SHEET NO.
94	1516.1-1-1	COOK	195	113
STA. 2016+35		TO STA. 2353+03		
FED. ROAD DIST. NO.	ILLINOIS	FED. AID PROJECT		

62872

MATCHLINE NB STA. 2255+00.00

MATCHLINE NB STA. 2261+00.00

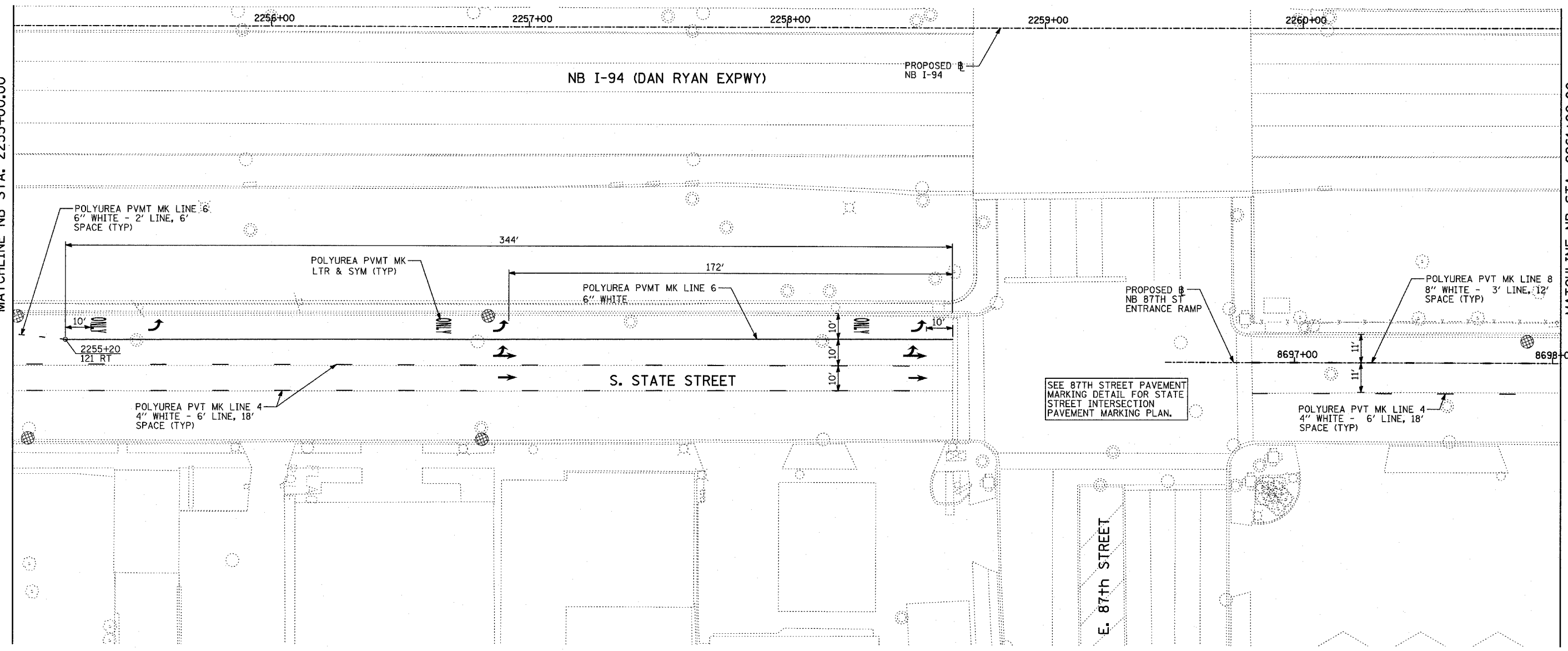

SEE 87TH STREET PAVEMENT MARKING DETAIL FOR STATE STREET INTERSECTION PAVEMENT MARKING PLAN.

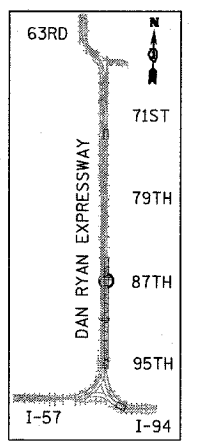

LOCATION MAP

LEGEND:

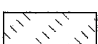
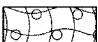
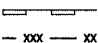
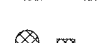
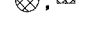
-  SODDING, SALT TOLERANT, NITROGEN, PHOSPHORUS, AND POTASSIUM FERTILIZER NUTRIENTS, TOPSOIL FURNISH AND PLACE, 4"
-  EROSION CONTROL BLANKET, SEEDING, CLASS 2A, NITROGEN, PHOSPHORUS, AND POTASSIUM FERTILIZER NUTRIENTS, TOPSOIL FURNISH AND PLACE, 4"
-  PERIMETER EROSION BARRIER (PEB)
-  TEMPORARY FENCE
-  INLET FILTER, TO BE INSTALLED IN OFF PROJECT DRAINAGE STRUCTURES ACCEPTING STORMWATER RUNOFF

TYLIN INTERNATIONAL

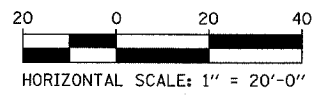

REVISIONS	
NAME	DATE

ILLINOIS DEPARTMENT OF TRANSPORTATION
F.A.I. 94 (DAN RYAN EXPRESSWAY)
EROSION CONTROL, LANDSCAPING,
& PAVEMENT MARKING
NB I-94 STA. 2255+00 TO 2261+00.00
SHEET 9 OF 14
 SCALE: 1"=20'
 DATE: OCTOBER 4, 2004
 DRAWN BY: RTM
 CHECKED BY: MPG

11/12/2004 07:45:16 AM