

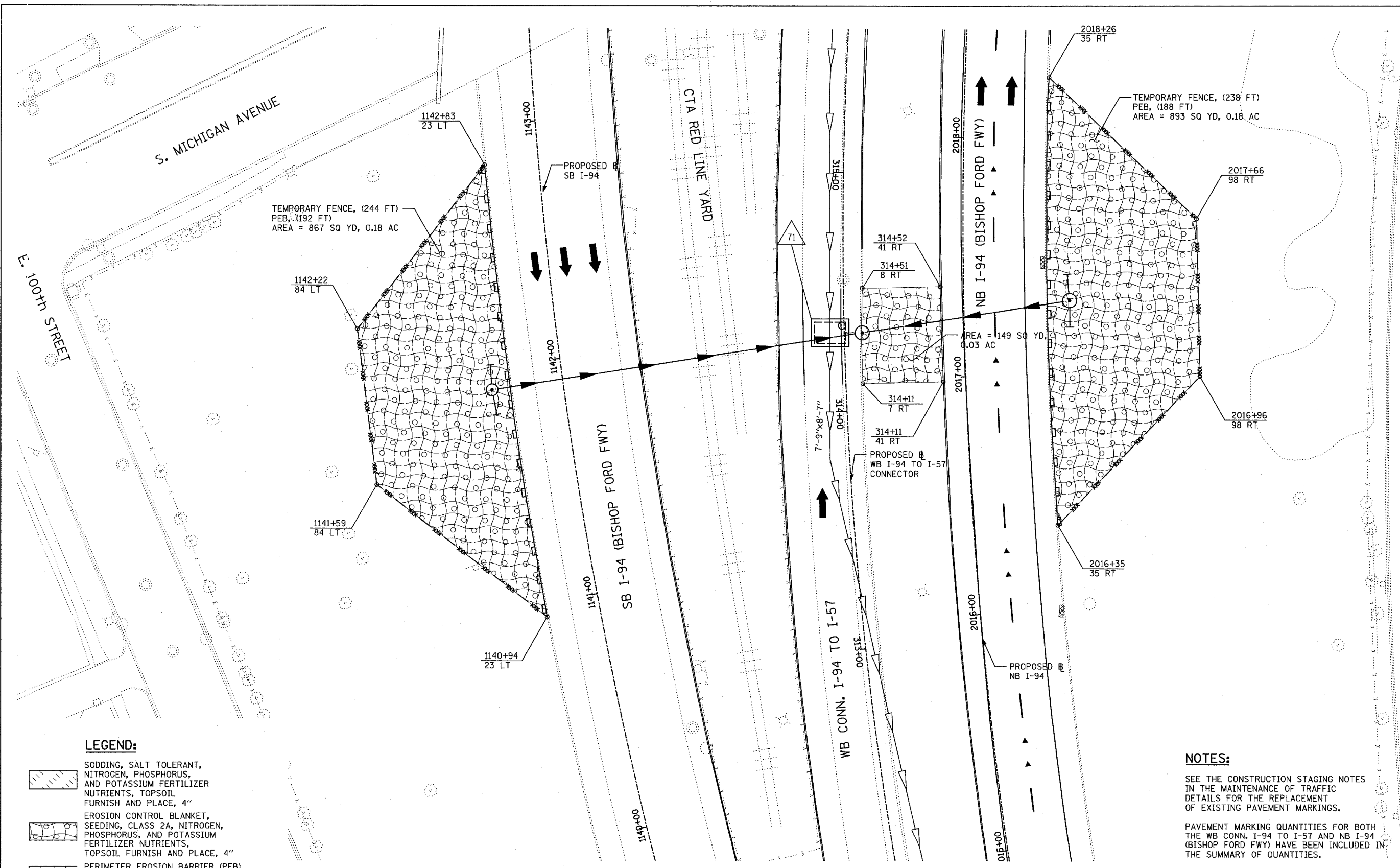

F.A.I. RTE.	SECTION	COUNTY	TOTAL SHEETS	SHEET NO.
94	1516.1-I-1	COOK	195	117
STA. 2016+35		TO STA. 2353+03		
FED. ROAD DIST. NO.		ILLINOIS FED. AID PROJECT		

62872

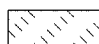
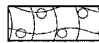
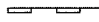
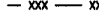

LEGEND:

-  SODDING, SALT TOLERANT, NITROGEN, PHOSPHORUS, AND POTASSIUM FERTILIZER NUTRIENTS, TOPSOIL FURNISH AND PLACE, 4"
-  EROSION CONTROL BLANKET, SEEDING, CLASS 2A, NITROGEN, PHOSPHORUS, AND POTASSIUM FERTILIZER NUTRIENTS, TOPSOIL FURNISH AND PLACE, 4"
-  PERIMETER EROSION BARRIER (PEB)
-  TEMPORARY FENCE
-  INLET FILTER, TO BE INSTALLED IN OFF PROJECT DRAINAGE STRUCTURES ACCEPTING STORMWATER RUNOFF

NOTES:

SEE THE CONSTRUCTION STAGING NOTES IN THE MAINTENANCE OF TRAFFIC DETAILS FOR THE REPLACEMENT OF EXISTING PAVEMENT MARKINGS.

PAVEMENT MARKING QUANTITIES FOR BOTH THE WB CONN. I-94 TO I-57 AND NB I-94 (BISHOP FORD FWY) HAVE BEEN INCLUDED IN THE SUMMARY OF QUANTITIES.

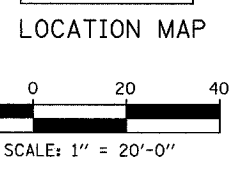
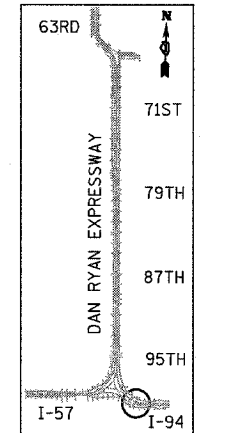

REVISIONS	
NAME	DATE

ILLINOIS DEPARTMENT OF TRANSPORTATION
 F.A.I. 94 (DAN RYAN EXPRESSWAY)
 EROSION CONTROL, LANDSCAPING,
 & PAVEMENT MARKING
 JUNCTION CHAMBER #71
 SHEET 13 OF 14

SCALE: 1"=20'
 DATE: OCTOBER 4, 2004
 DRAWN BY: RTM
 CHECKED BY: MPG

TYLININTERNATIONAL

11/12/2004 07:46:14 AM