

STATE OF ILLINOIS
DEPARTMENT OF TRANSPORTATION

Sheet No. 2
of 11 Sheets

ROUTE NO.	SECTION	COUNTY	TOTAL SHEETS	SHEET NO.
FAS 1197	105BR-2	WHITESIDE	59	17
FED. ROAD DIST. NO.	ILLINOIS	PROJECT		

CONTRACT 64421

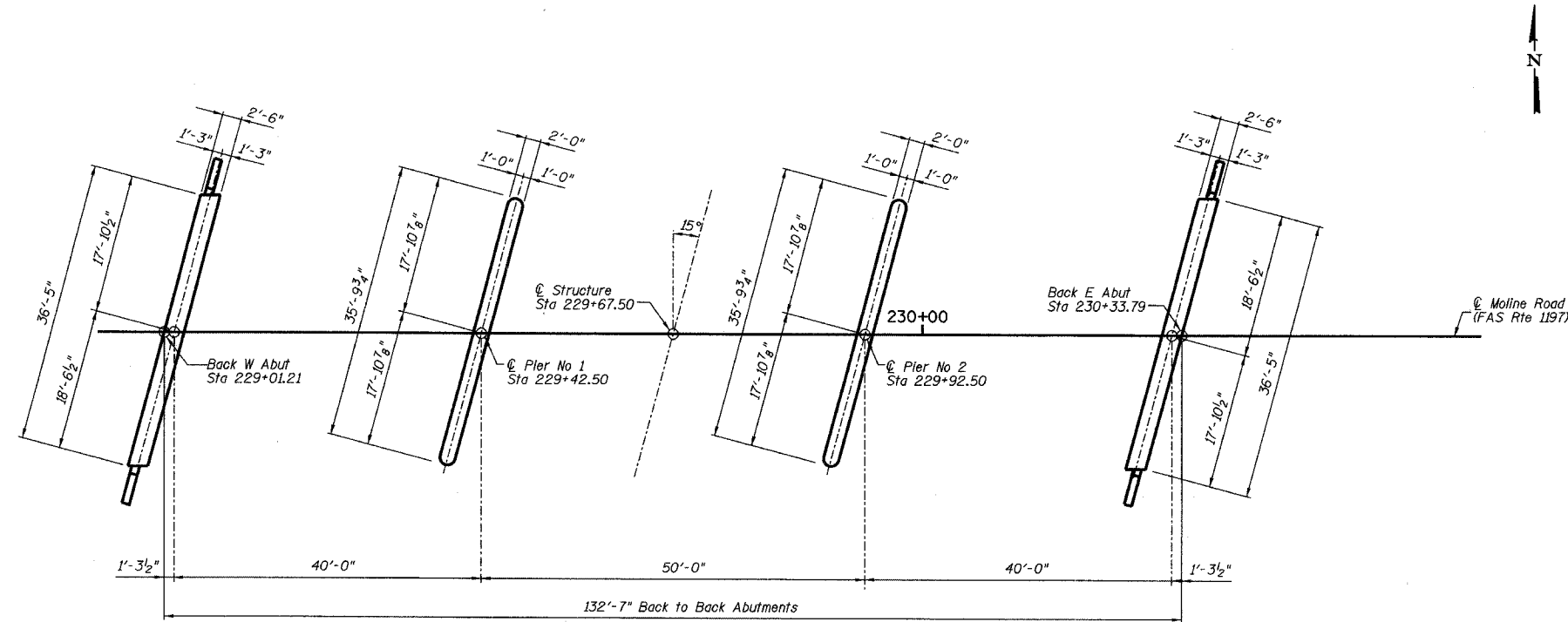

PLAN

GENERAL NOTES

- Reinforcement bars shall conform to the requirements of AASHTO M 31 or M 322 Grade 60.
- Layout of slope protection system may be varied in the field to suit ground conditions as directed by the Engineer.
- The Contractor shall make allowance for the deflection of forms, shrinkage and settlement of falsework, in addition to allowance for dead load deflection.
- The Contractor shall drive one test pile in a permanent location at the West Abut as directed by the Engineer before ordering the remainder of piles.
- Excavation behind the existing abutment walls shall be done before removing the existing superstructure.
- All Construction joints shall be bonded.

TOTAL BILL OF MATERIAL

ITEM	UNIT	SUPER	SUB	TOTAL
Porous Granular Embankment	Cu Yd		83	83
Stone Riprap Class A5	Sq Yd		1018	1018
Filter Fabric for use with Riprap	Sq Yd		1018	1018
Removal of Existing Structures No. 1	Each	1		1
Structure Excavation	Cu Yd		121	121
Floor Drains	Each	12		12
Concrete Structures	Cu Yd		88.2	88.2
Concrete Superstructure	Cu Yd	293.4		293.4
Bridge Deck Grooving	Sq Yd	439		439
Protective Coat	Sq Yd	578		578
Reinforcement Bars, Epoxy Coated	Pound	65,280	8,200	73,480
Furnishing Steel Piles HP12x63	Lin Ft		1381	1381
Driving Steel Piles	Lin Ft		1381	1381
Test Pile Steel HP12x63	Each		1	1
Name Plates	Each	1		1
Underwater Structure Excavation Protection - Location 1	Each		1	1
Underwater Structure Excavation Protection - Location 2	Each		1	1

FOUNDATION PLAN

REVISIONS		MOLINE ROAD OVER UNNAMED TRIBUTARY TO ROCK RIVER		DRAWN BY DATE R King 8/04 CHECKED BY DATE CWC 8/04 QA/QC BY DATE CWC 8/04 BOOK NUMBER
No.	DATE	INITIALS		
1				
2				
3				
4				
5				
6				
7				
8				
9				
10				
11				
12				

FAS ROUTE 1197 SECTION 105BR-2
SN 098-0110
STA 229+67.50 WHITESIDE COUNTY
HOMER L. CHASTAIN & ASSOCIATES, LLP
CONSULTING ENGINEERS
184-001397

PROJECT NO.
4858-3
SHEET NO.