

INDEX OF SHEETS

- 1 COVER SHEET
- 2 GENERAL NOTES
- 3 SUMMARY OF QUANTITIES
- 4 - 5 TYPICAL SECTIONS
- 6 REFERENCE MAP
- 7 - 9 SCHEDULE OF QUANTITIES
- 10 - 11 TIE POINTS
- 12 - 15 DETAILS

HIGHWAY STANDARDS

- 000001-04 STANDARD SYMBOLS, ABBREVIATIONS AND PATTERNS
- 406201 MAILBOX TURNOUTS
- 442201-01 CLASS C AND D PATCHES
- 667101 PERMANENT SURVEY MARKERS
- 701011-01 OFF-RD MOVING OPERATIONS 2L, 2W DAY ONLY
- 701306-01 LANE CLOSURE, 2L, 2W, SLOW MOVING OPERATIONS DAY ONLY, FOR SPEEDS ≥ 45 MPH
- 701311-02 LANE CLOSURE, 2L, 2W MOVING OPERATIONS - DAY ONLY
- 701336-04 LANE CLOSURE, 2L, 2W, WORK AREAS IN A SERIES, FOR SPEEDS ≥ 45 MPH
- 702001-05 TRAFFIC CONTROL DEVICES
- 781001-02 TYPICAL APPLICATIONS RAISED REFLECTIVE PAVEMENT MARKERS

FULL SIZE PLANS HAVE BEEN PREPARED USING STANDARD ENGINEERING SCALES, REDUCED SIZED PLANS WILL NOT CONFORM TO STANDARD SCALES, IN MAKING MEASUREMENTS ON REDUCED PLANS, THE ABOVE SCALES MAY BE USED.

MICROFILMED _____
 REEL NUMBER _____
 AWARDED _____
 RESIDENT ENGINEER _____
 AS BUILT CHANGES WERE MADE ON THE FOLLOWING SHEETS _____

JULIE 1-800-892-0123

DISTRICT 3 NO. (815) 434-6131

PROJECT ENGINEER: DAVE BROVIK
 UNIT CHIEF: LINDA POHAR
 TOWNSHIP: FORREST & FAYETTE

CONTRACT NO. 66459

STATE OF ILLINOIS
DEPARTMENT OF TRANSPORTATION
DIVISION OF HIGHWAYS
PLANS FOR PROPOSED
FEDERAL AID HIGHWAY
F.A.P. 326 (IL 47)
SECTION 124 RS-6, 125 RS-3 & 1
PROJECT NHF-0326(058)
LIVINGSTON COUNTY

C-93-102-04

MILLING AND RESURFACING ON IL 47 FROM US 24 TO FORD COUNTY LINE

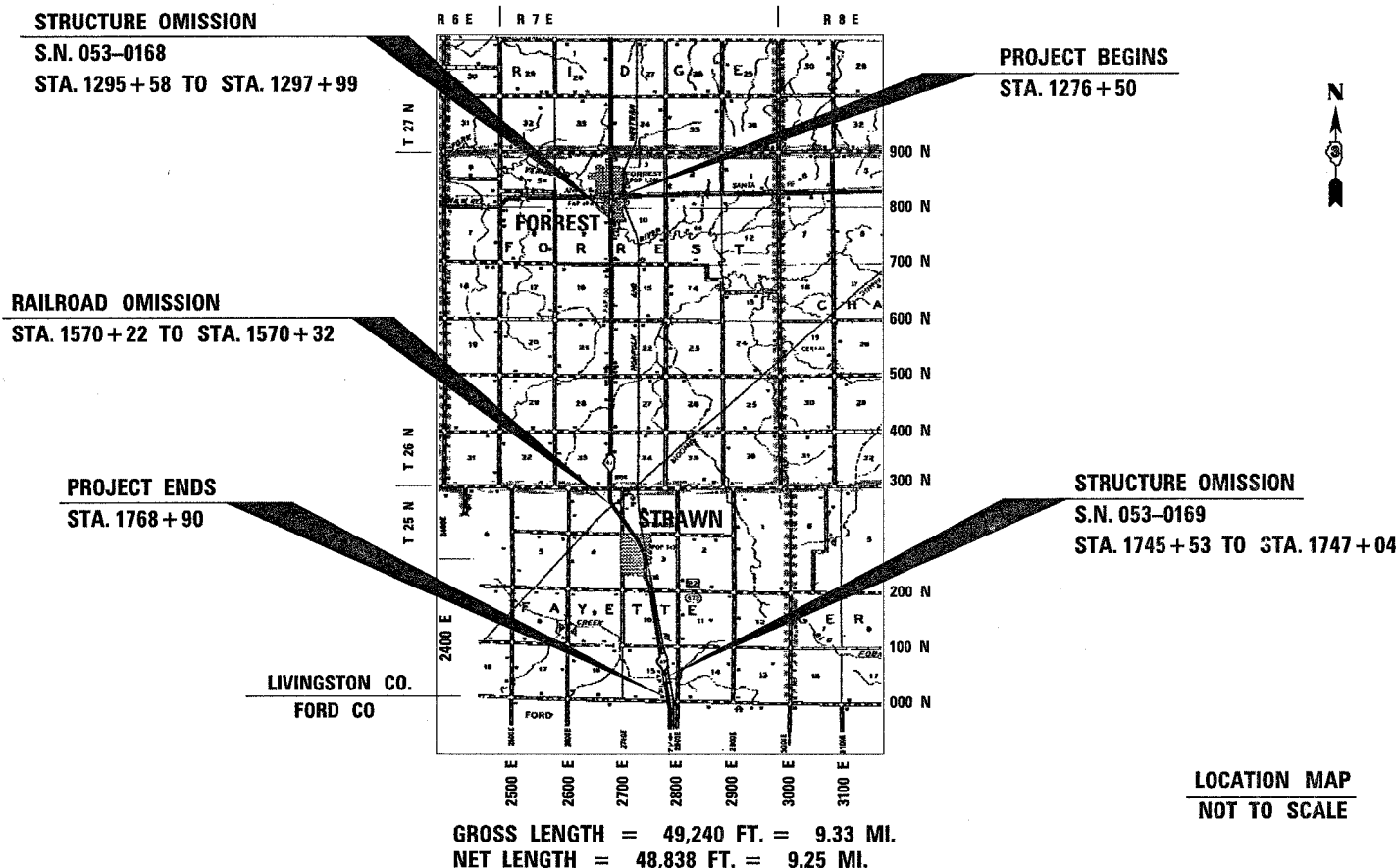

LOCATION MAP
 NOT TO SCALE

F.A.P. RTE.	SECTION	COUNTY	TOTAL SHEETS	SHEET NO.
326	124RS-6, 125RS-3 & 1	LIVINGSTON	15	1

CONTRACT #66459
 P-93-023-04
 D-93-053-04

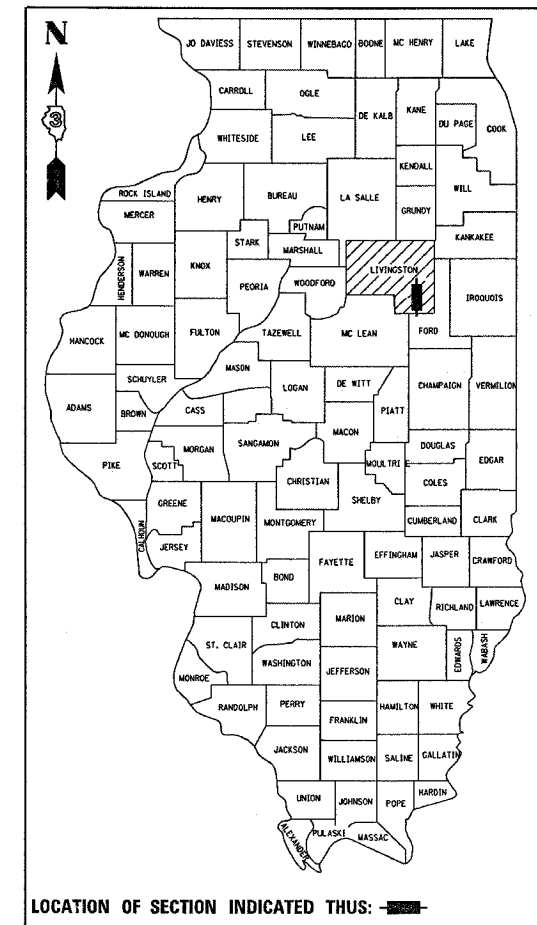

FUNCTION CLASSIFICATION
RURAL OTHER PRINCIPAL ARTERIAL

2003 ADT = 3250
 P.V. = 73.8% S.U. = 7.7% M.U. = 18.5%

STATE OF ILLINOIS
DEPARTMENT OF TRANSPORTATION
DIVISION OF HIGHWAYS

SUBMITTED October 29 2004
Jim P. Kue DISTRICT ENGINEER
December 10 2004
Mike Hine ENGINEER OF DESIGN AND ENVIRONMENT
December 10 2004
Victor Maden DIRECTOR, DIVISION OF HIGHWAYS

PRINTED BY THE AUTHORITY
 OF THE STATE OF ILLINOIS