

CONTRACT NO. 68074				
F.A.S. RTE.	SECTION	COUNTY	TOTAL SHEETS	SHEET NO.
1379	(108B) BR-1	STARK	33	8
STA. 210+02		TO STA. 217+40		
FED. ROAD DIST. NO.		ILLINOIS	FED. AID PROJECT	

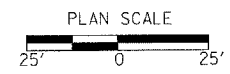
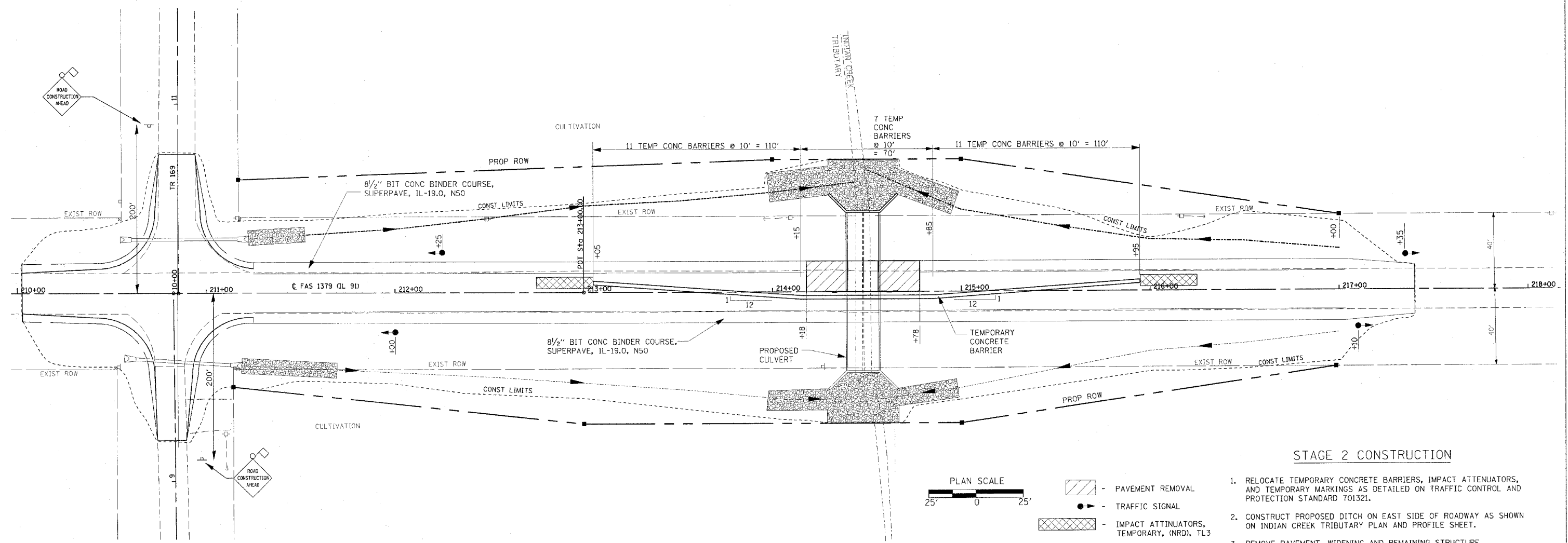

- PAVEMENT REMOVAL
- TRAFFIC SIGNAL
- IMPACT ATTENUATORS, TEMPORARY, (NRD), TL3

**STAGE 2 CONSTRUCTION**

1. RELOCATE TEMPORARY CONCRETE BARRIERS, IMPACT ATTENUATORS, AND TEMPORARY MARKINGS AS DETAILED ON TRAFFIC CONTROL AND PROTECTION STANDARD 701321.
2. CONSTRUCT PROPOSED DITCH ON EAST SIDE OF ROADWAY AS SHOWN ON INDIAN CREEK TRIBUTARY PLAN AND PROFILE SHEET.
3. REMOVE PAVEMENT, WIDENING AND REMAINING STRUCTURE FROM STATION 214+18 TO STATION 214+78 AS SHOWN, INCLUDING SECTIONS OF TEMPORARY SHEET PILING DESIGNATED TO BE REMOVED AFTER STAGE 1 CONSTRUCTION. REMOVE GUARDRAIL ON EAST SIDE.
4. CONSTRUCT CAST-IN-PLACE BOX CULVERT, WINGWALLS, NEW PAVEMENT SUBBASE AND BASE COURSE, AND ALL OTHER COLLATERAL WORK FOR EAST SIDE OF ROADWAY AS SHOWN.
5. REMOVE TRAFFIC CONTROL PAVEMENT MARKINGS, TEMPORARY CONCRETE BARRIERS AND TEMPORARY SIGNALS. COST IS INCLUDED IN TRAFFIC CONTROL AND PROTECTION STANDARD 701321.
6. CONSTRUCT PROPOSED 2" SURFACING LAYER FROM STA 210+02.00 TO 217+40.00 AS SHOWN. USE TRAFFIC CONTROL AS DETAILED ON STANDARD 701301.
7. CONSTRUCT AGGREGATE SHOULDERS ALONG SIDEROAD APPROACHES AS SHOWN.
8. SURFACE COURSE AND PAVEMENT MARKING WILL BE PLACED AFTER THE COMPLETION OF STAGE 2.

NOTE: THE COST OF ROAD CONSTRUCTION AHEAD SIGNS FOR TR 169 IS INCLUDED IN THE COST FOR HIGHWAY STANDARD 701321.

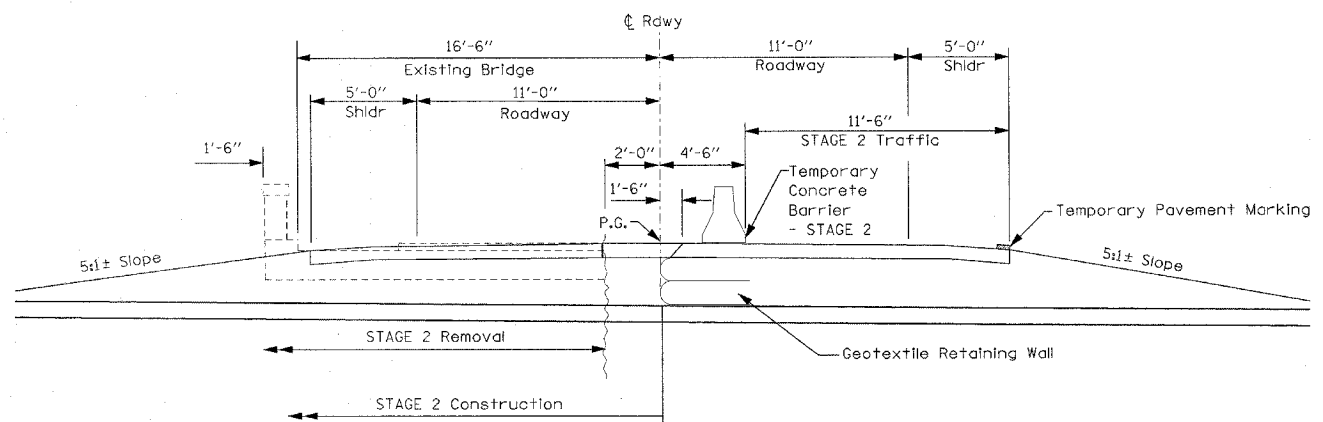

**STAGE 2 CONSTRUCTION CROSS SECTION (LOOKING SOUTH)**

**SECTION (108B) BR-1  
STAGE 2 CONSTRUCTION AT INDIAN CREEK TRIBUTARY**

REVISIONS	
NAME	DATE

ILLINOIS DEPARTMENT OF TRANSPORTATION  
**STAGE 2 CONSTRUCTION**  
**INDIAN CREEK TRIB**  
**EXISTING SN 088-0018**  
**PROPOSED SN 088-2500**  
 SCALE: 1"=25'  
 DATE: 06-02-03  
 DRAWN BY: BAD  
 CHECKED BY: JLG