

STATE OF ILLINOIS
DEPARTMENT OF TRANSPORTATION

FAS RTE	SECTION	COUNTY	TOTAL SHEETS	SHEET NO
1379	(108B)BR-1	STARK	33	22
STA 214+48.00			ILLINOIS	

Bench Mark #6: 214+56.53, 19.00' Rt Chiseled "□" set on SW wingwall of SN 088-0018, El 719.19

Existing Structure: SN 088-0018
Single span reinforced concrete slab bridge on closed concrete abuts on timber piles. 18' bk-bk, 36'-0" wide. Built 1933 as SBI Rte 93, Section 10B-B to be removed. Traffic shall be maintained by stage construction.

Salvage: None

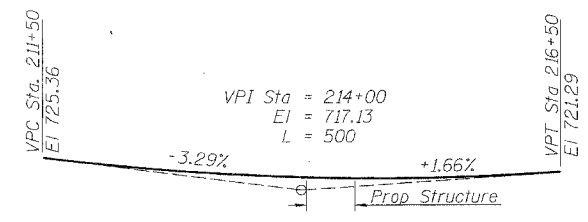
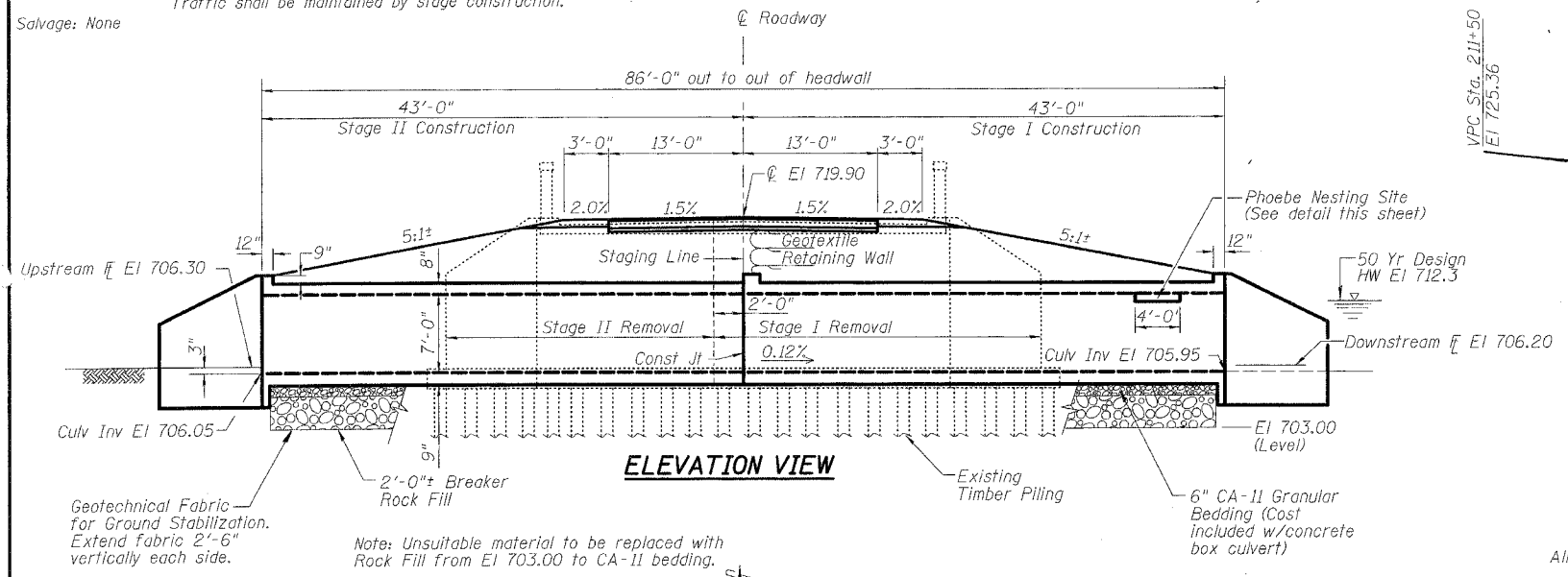

GENERAL NOTES

1. Reinforcement bars shall conform to the requirements of AASHTO M-31, or M-322 Grade 60.
2. All exposed edges shall have 3/4" chamfer
3. The existing superstructure shall not be removed until after the fill has been excavated behind the abutment walls and the slab and abutment walls have been saw cut along the stage construction line.
4. Remove existing structure including wings, abutments, and footings. Cut off existing piles below bottom of unsuitable material excavation
5. For staging details, see sheet 3.
6. Precast alternate is not allowed.

DESIGN SPECIFICATIONS

Design In Accordance With 1996 AASHTO Specifications And Interim Specifications Dated 1997, 1998, 1999 & 2000.

LOADING HS20-44

Allow 50#/#Sq Ft For Future Wearing Surface

DESIGN STRESSES

$f_c = 3,500 \text{ psi}$
 $f_y = 60,000 \text{ psi}$

SEISMIC DATA

Seismic Performance Category (SPC) = A
Bedrock Acceleration Coefficient (A) = 0.04
Site Coefficient (S) = 1.0

TOTAL BILL OF MATERIAL

ITEM	UNIT	TOTAL
Removal and Disposal of Unsuitable Material	Cu Yd	136
Geotechnical Fabric for Ground Stabilization	Sq Yd	253
Removal of Existing Structures	Each	1
* Temporary Sheet Piling	Sq Ft	572
Reinforcement Bars	Pound	25,270
Name Plates	Each	1
Concrete Box Culverts	Cu Yd	143
* Geotextile Retaining Wall	Sq Ft	120
Bar Splacers	Each	83
* Rock Fill	Ton	273

* See Special Provisions

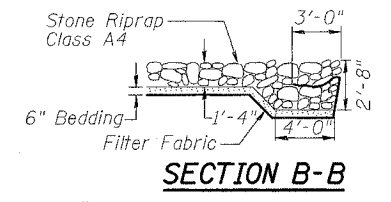
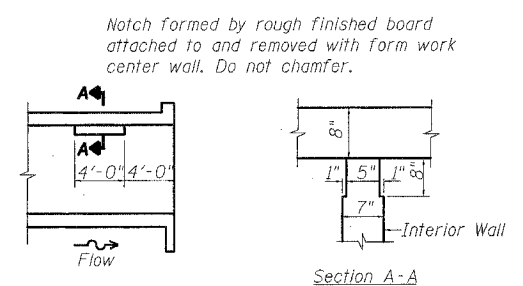
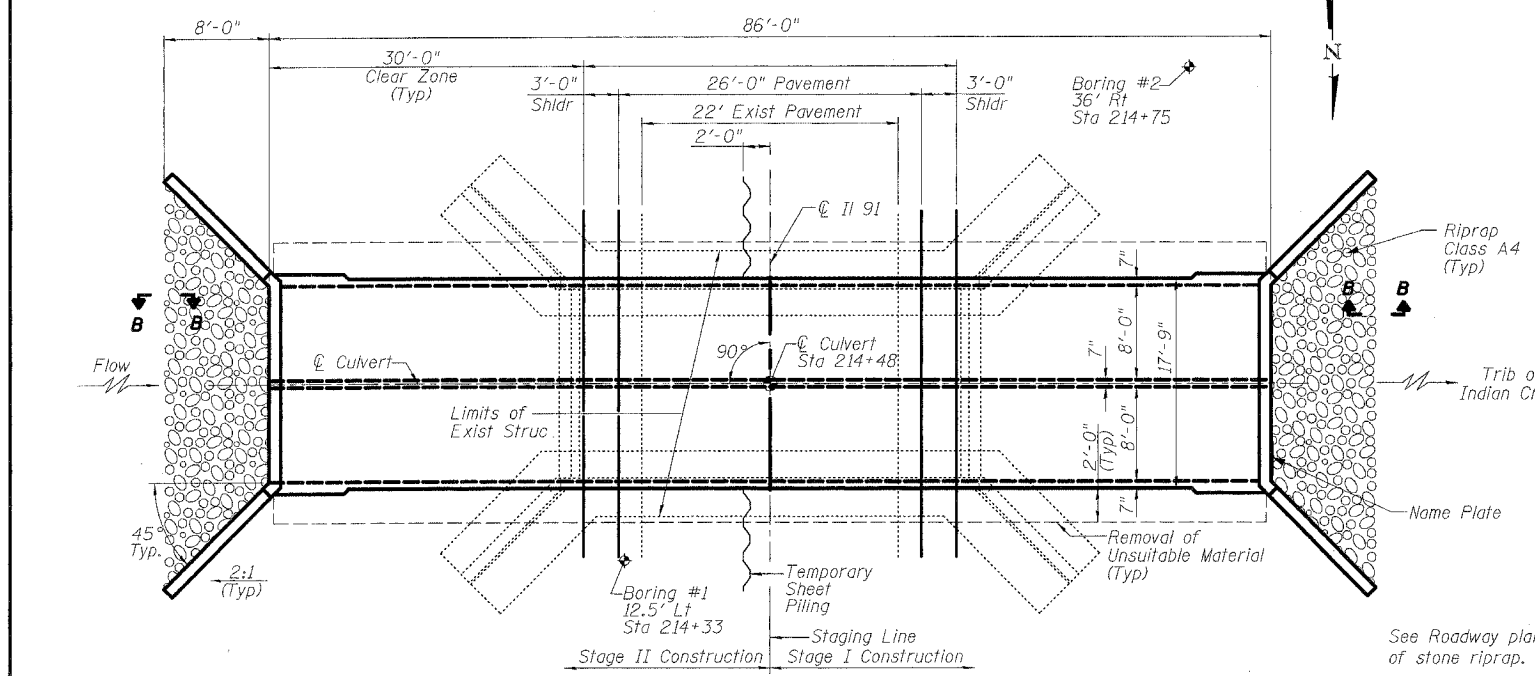

PHOEBE NESTING SITE

APPROVED FOR STRUCTURAL ADEQUACY ONLY
Ralph E. Anderson
ENGINEER OF BRIDGES AND STRUCTURES

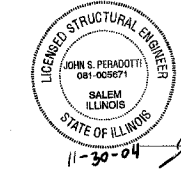

John S. Peradotti
John S. Peradotti
Licensed Structural Engineer
in Illinois No. 081-005671
License Expires 11/30/04

See Roadway plans for limits of stone riprap.

PLAN VIEW

WATERWAY INFORMATION

Drainage Area = 2.54 Sq Mi Low Grade Elev 719.9 @ Sta 214+48

Flood	Freq Yr	Q C.F.S.	Opening Sq Ft		Nat H.W.E.	Head-Ft		Headwater El	
			Exist	Prop		Exist	Prop	Exist	Prop
Design	10	350	77	86	711.7	0.1	0.0	711.8	711.4
Base	50	540	93	106	712.3	0.4	0.4	712.7	712.7
Overtopping	100	620	96	112	712.5	0.6	0.6	713.1	713.1
Max Calc	500	820	104	112	712.9	1.4	1.1	714.3	714.0

STA 214+48.00
BUILT 20... BY
STATE OF ILLINOIS
FAS RT 1379 SEC (108B)BR-1
LOADING HS20
STR NO 088-2500

NAME PLATE
See Std. 515001

Range 6 E. 4th P.M. Prop Structure

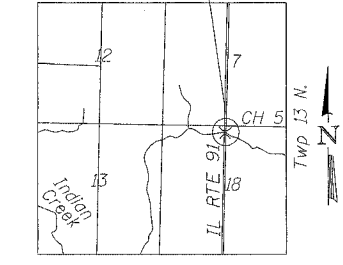

LOCATION SKETCH

GENERAL PLAN & ELEVATION
FAS 1379 (IL RT 91) OVER
INDIAN CREEK TRIBUTARY
SECTION (108B)BR-1
STARK COUNTY STA 214+48.00
SN 088-2500

DESIGNED	JLG
CHECKED	GEP
DRAWN	BAD
CHECKED	JLG