

BENCH MARK:
Chiseled "X" in sidewalk @ S.W. Corner of Brummel St. & Asbury Ave.
Elev. = 32.96

EXISTING STRUCTURE:
Structure No. 016-6311 has a 3-Span Concrete Filled Steel Trough Superstructure, 82.5 Ft. Long by 66 Ft. Wide. Skew 7° 25' 27". The Steel is Supported by two Concrete Gravity Wall Abutments and two steel Frame Piers. Existing Abutment to Remain.

CONSTRUCTION STAGING:
Traffic will be maintained using stage construction.

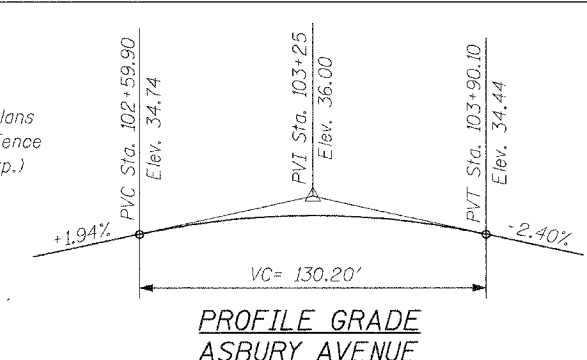
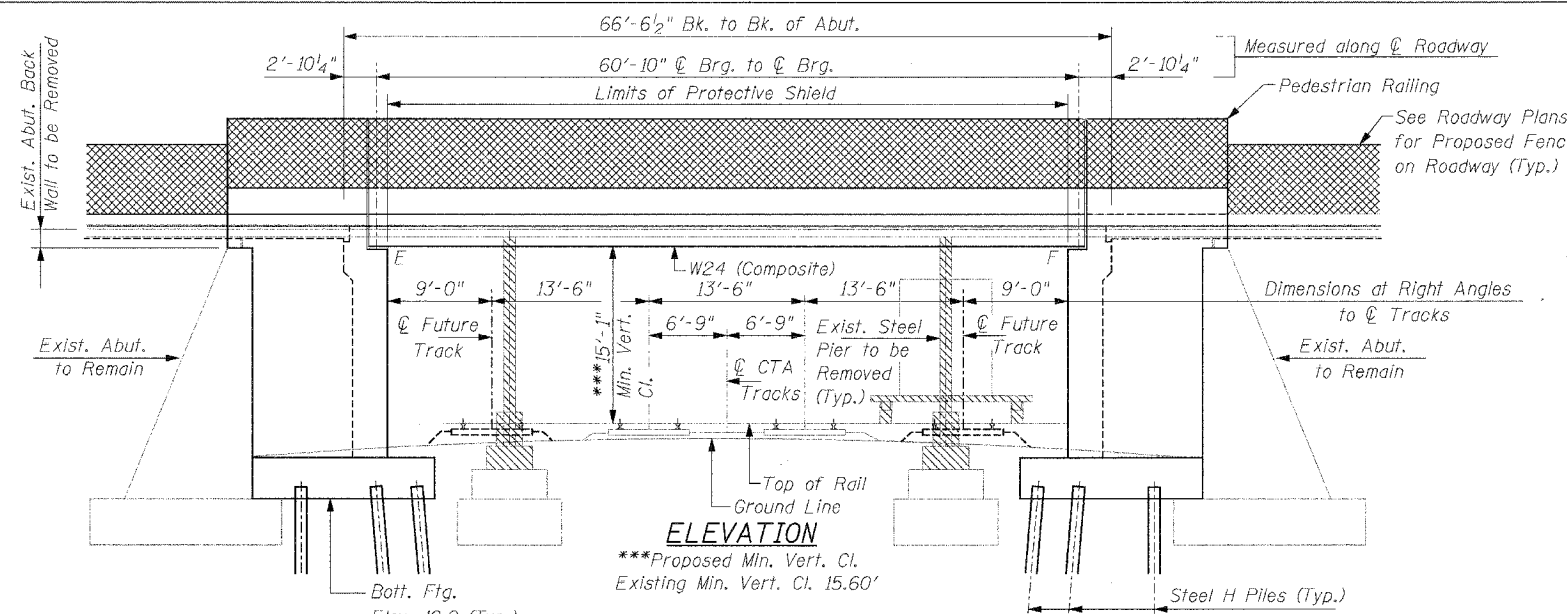

TOP OF TRACK ELEVATION

Station	South Track	North Track
44+50	16.71	16.68
45+00	16.62	16.64
45+25	16.61	16.59
45+50	16.58	16.59
45+75	16.56	16.59
46+00	16.51	16.56
46+25	16.48	16.55
46+50	16.45	16.53
47+00	16.53	16.52

F.A.U. RTE.	SECTION	COUNTY	TOTAL SHEETS	SHEET NO.
3732	00-00125-00-BR	COOK	58	18
STA. 102+57.23 TO STA. 103+82.77				
FED. ROAD DIST. NO.		ILLINOIS	PROJECT BHM-7003(802)	
Sheet S-1 of S-28		CONTRACT 83584		

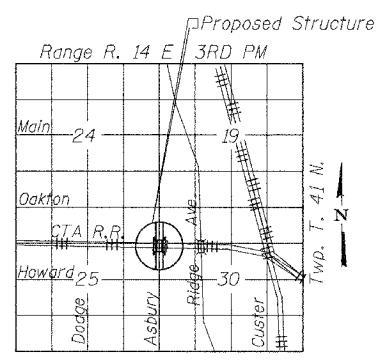

LOCATION SKETCH

LOADING HS20-44
Allow 50#/sq. ft. for future wearing surface.

DESIGN SPECIFICATIONS
2002 AASHTO

DESIGN STRESSES

FIELD UNITS
 $f'_c = 3,500$ psi
 $f_y = 60,000$ psi (reinforcement)
 $f_y = 50,000$ psi (M270 Grade 50)

SEISMIC DATA

Seismic Performance Category (SPC) = A
 Bedrock Acceleration Coefficient (A) = 0.04 g
 Site Coefficient (S) = 1.0

STATION 103+20.00
 BUILT 200_ BY
 STATE OF ILLINOIS
 F.A.U RT. 3732 SEC. 00-00215-00-BR
 F.A.U PROJ. NO. BHM-7003(801)
 LOADING HS20
 STR. NO. 016-6959

NAME PLATE
See Std. 515001

"I CERTIFY THAT TO THE BEST OF MY KNOWLEDGE, INFORMATION AND BELIEF, THIS BRIDGE DESIGN IS STRUCTURALLY ADEQUATE FOR THE DESIGN LOADING SHOWN ON THE PLANS. THE DESIGN IS AN ECONOMICAL ONE FOR THE STYLE OF STRUCTURE AND COMPLIES WITH REQUIREMENTS OF THE CURRENT 'AASHTO STANDARD SPECIFICATIONS FOR HIGHWAY BRIDGES.'"

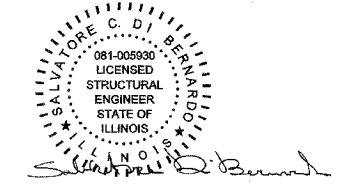

DATE: 10/25/2004
SEAL EXPIRES: 11/30/04

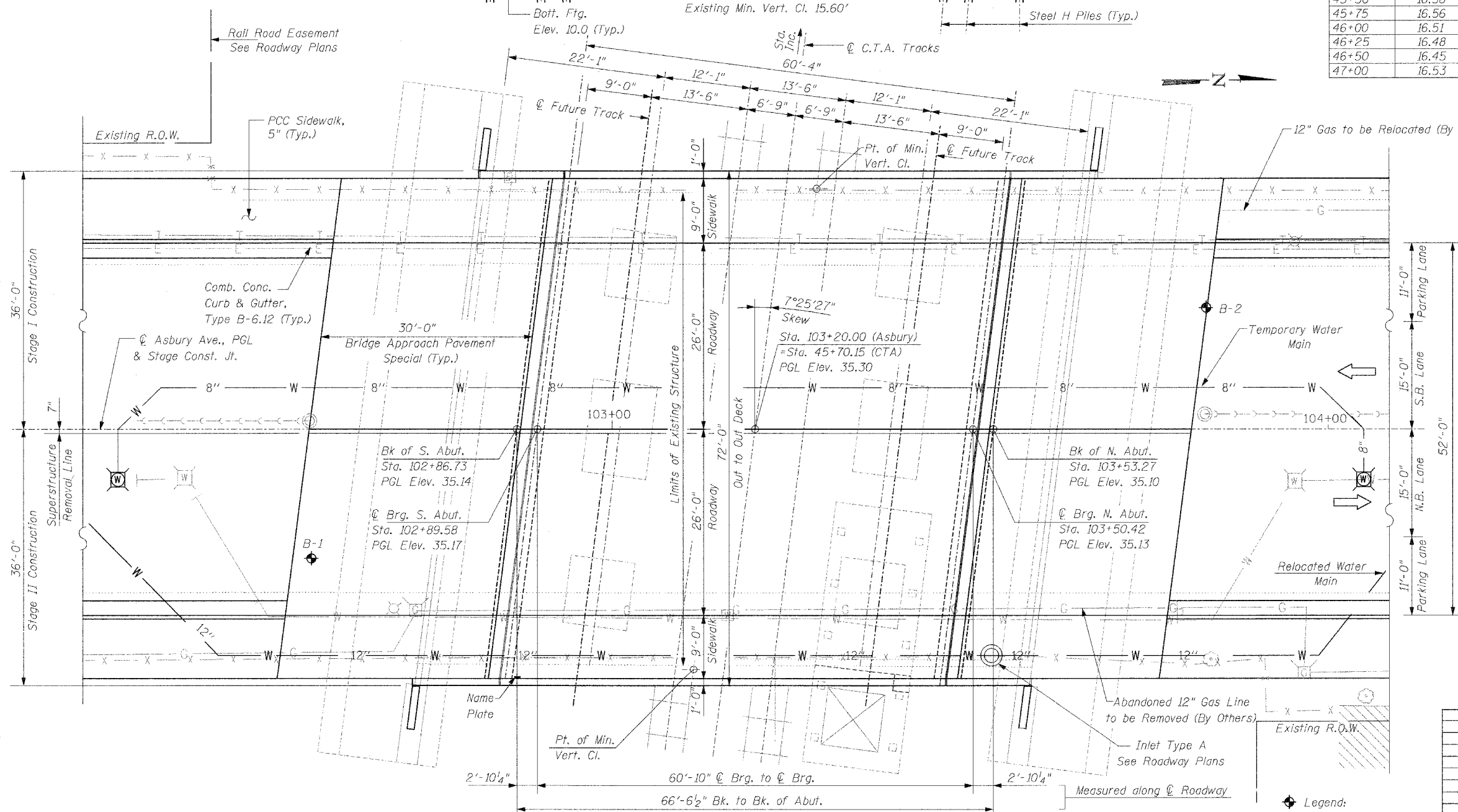

PLAN

Note: No deck drains will be permitted over tracks

REVISIONS

NAME	DATE

Clorba Group, Inc.
 CONSULTING ENGINEERS
 2807 NORTH CLEVELAND AVENUE • CHICAGO, ILLINOIS 60664 • (773) 778-0069

CITY OF EVANSTON, ILLINOIS
 GENERAL PLAN & ELEVATION
 ASBURY AVENUE OVER CTA YELLOW LINE
 SECTION 00-00215-00-BR
 COOK COUNTY
 STA. 103+20.00
 STRUCTURE NO. 016-6959

SCALE: NONE
 DATE: OCTOBER 2004
 FILE: 3212

DRAWN BY: IMG
 CHECKED BY: SCD

DATE: 10/25/2004
FILENAME: N:\PROJ\3212\Design\Structural\3212-S-01-GenPlan.dgn