

F. A. U. NO.	SECTION	COUNTY	TOTAL SHEETS	SHEET NO.
1636	92-00037-03-PV	WILL	39	10
STA.	TO STA.			
FED. ROAD DIST. NO.	BLANKS	FED. AID PROJECT		

83680

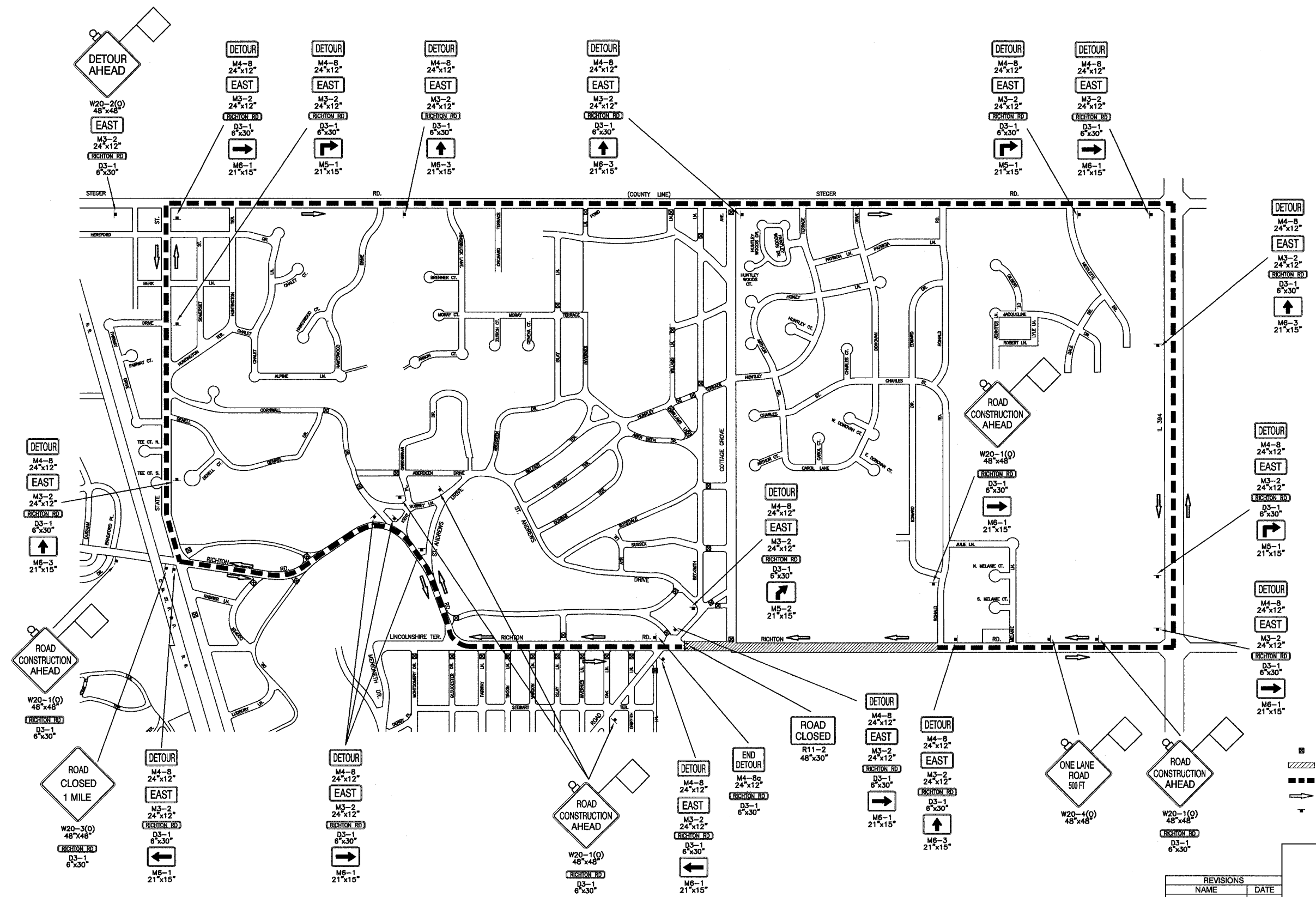

LEGEND

- R.O.W. CORRIDOR ONLY, NO DEVELOPED ROADWAY
- CONSTRUCTION AREA
- DETOUR ROUTE
- DIRECTION OF TRAFFIC
- SIGN

REVISIONS	
NAME	DATE

ILLINOIS DEPARTMENT OF TRANSPORTATION
 F.A.U. 1636 RICHTON ROAD
 DETOUR PLAN

SCALE: VERT. NA
 HORIZ. NA
 DATE: 02-17-03

DRAWN BY: EC
 CHECKED BY: PKB