

F.A.U. NO.	SECTION	COUNTY	TOTAL SHEETS	SHEET NO.
1636	92-00037-03-PV	WILL	39	14
STA.		TO STA.		
FED. ROAD DIST. NO.	ILLINOIS	FED. AID PROJECT		

83680

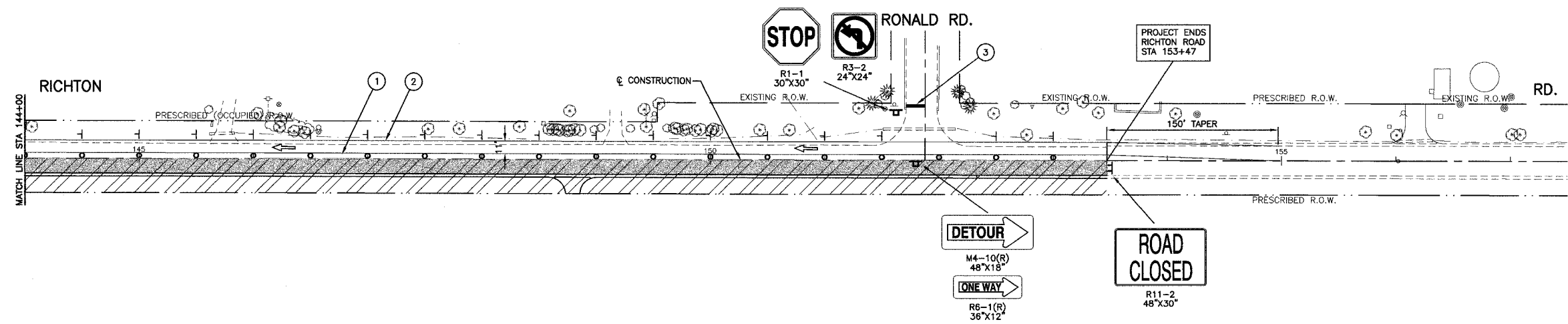

**LEGEND**

- |  |   |   |   |
|--|---|---|---|
|  | WORK AREA   | ① | 4" YELLOW EDGE LINE - TEMPORARY PAVEMENT MARKINGS         |
|  | TEMPORARY PAVEMENT TO BE CONSTRUCTED (8")                           | ② | 4" WHITE EDGE LINE - TEMPORARY PAVEMENT MARKINGS          |
|  | PAVEMENT CONSTRUCTION LIMITS  | ③ | 24" WHITE STOP BAR - TEMPORARY PAVEMENT MARKINGS          |
|  | VERTICAL PANEL WITH STEADY BURNING LIGHT (50' C-C)                  | ④ | 4" DOUBLE YELLOW CENTER LINE - TEMPORARY PAVEMENT MARKING |
|  | TYPE I OR II BARRICADE OR DRUM WITH STEADY BURNING LIGHTS (50' C-C) |   |   |
|  | TYPE III BARRICADE WITH STEADY BURNING LIGHT                        |   |   |
|  | SIGN  |   |   |

REVISIONS	
NAME	DATE

ILLINOIS DEPARTMENT OF TRANSPORTATION  
 F.A.U. 1636 RICHTON ROAD  
 SUGGESTED CONSTRUCTION STAGING  
 STAGE 2 - RICHTON RD  
 STA 144+00 TO END PROJECT

SCALE: VERT. 1"=50'  
 HORIZ. 1"=50'  
 DATE 02-17-03

DRAWN BY EC  
 CHECKED BY PKB