

F.A.U. FILE	SECTION	COUNTY	TOTAL SHEETS	SHEET NO.
1636	92-00037-03-PV	WILL	39	38
STA.		TO STA.		
FED. ROAD DIST. NO.	BLKNO.	FED. AID PROJECT		

83280

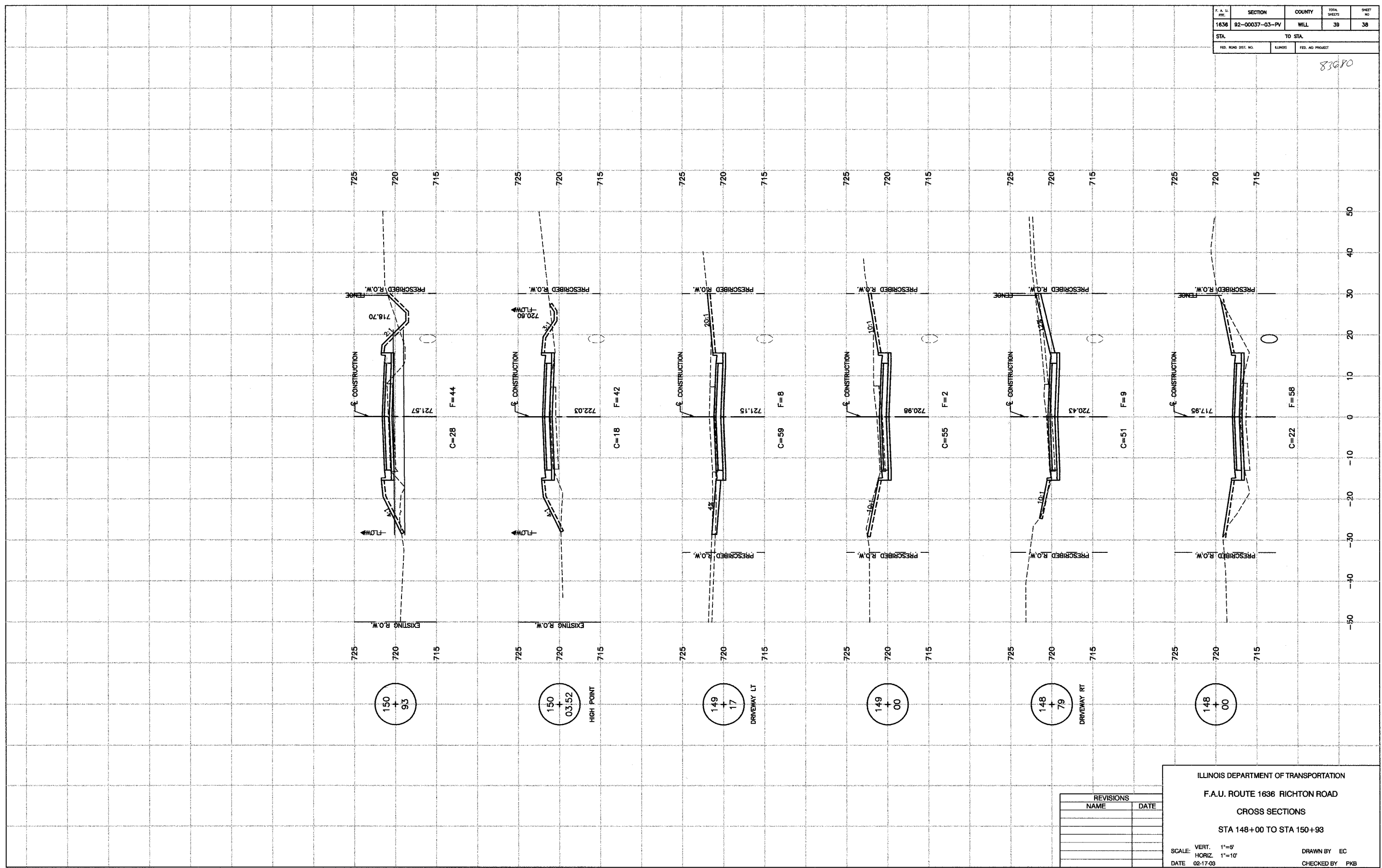

REVISIONS	
NAME	DATE

ILLINOIS DEPARTMENT OF TRANSPORTATION
 F.A.U. ROUTE 1636 RICHTON ROAD
 CROSS SECTIONS
 STA 148+00 TO STA 150+93
 SCALE: VERT. 1"=5'
 HORIZ. 1"=10'
 DATE 02-17-08
 DRAWN BY EC
 CHECKED BY PKB