

F. A. U. RITE	SECTION	COUNTY	TOTAL SHEETS	SHEET NO.
1636	92-00037-03-PV	WILL	39	39
STA.	TO STA.			
FED. ROAD DIST. NO.	ALMOST	FED. AID PROJECT		

82680

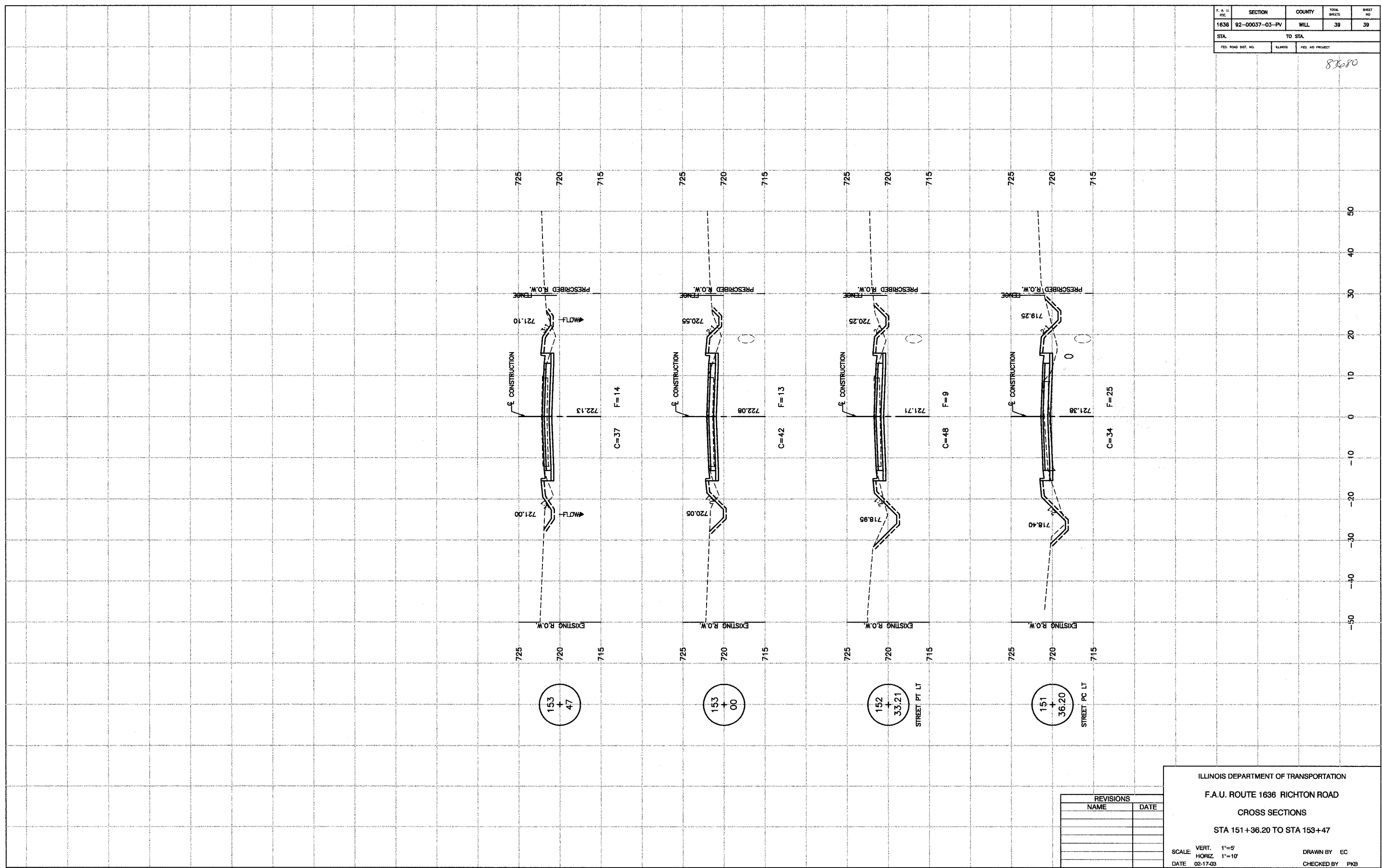

REVISIONS	
NAME	DATE

ILLINOIS DEPARTMENT OF TRANSPORTATION  
 F.A.U. ROUTE 1636 RICHTON ROAD  
 CROSS SECTIONS  
 STA 151+36.20 TO STA 153+47  
 SCALE: VERT. 1"=5'  
 HORIZ. 1"=10'  
 DATE 02-17-03  
 DRAWN BY EC  
 CHECKED BY PKB