

**PROP. CURVE CL2-14**  
 PI STA = 13+621.049  
 N = 48,112.957  
 E = 6,086.554  
 $\Delta = 50^\circ 59' 19''$  (RT)  
 R = 40.000 m  
 T = 19.074 m  
 L = 35.597 m  
 E = 4.315 m

**PROP. CURVE CL2-15**  
 PI STA = 13+679.358  
 N = 48,052.291  
 E = 6,081.694  
 $\Delta = 17^\circ 51' 33''$  (LT)  
 R = 30.000 m  
 T = 4.714 m  
 L = 9.351 m  
 E = 0.368 m

**PROP. CURVE CL2-16**  
 PI STA = 13+701.516  
 N = 48,030.651  
 E = 6,086.800  
 $\Delta = 21^\circ 18' 36''$  (LT)  
 R = 30.000 m  
 T = 5.644 m  
 L = 11.158 m  
 E = 0.526 m

**PROP. CURVE CL2-17**  
 PI STA = 13+733.892  
 N = 48,003.890  
 E = 6,105.253  
 $\Delta = 38^\circ 58' 08''$  (LT)  
 R = 30.000 m  
 T = 10.614 m  
 L = 20.404 m  
 E = 1.822 m

**PROP. CURVE CL2-18**  
 PI STA = 13+753.020  
 N = 47,998.242  
 E = 6,124.391  
 $\Delta = 12^\circ 43' 21''$  (LT)  
 R = 30.000 m  
 T = 3.344 m  
 L = 6.661 m  
 E = 0.186 m

**PROP. CURVE CL2-19**  
 PI STA = 13+832.060  
 N = 47,993.111  
 E = 6,203.291  
 $\Delta = 94^\circ 01' 46''$  (RT)  
 R = 30.000 m  
 T = 32.188 m  
 L = 49.234 m  
 E = 14.000 m

**PROP. CURVE CL2-20**  
 PI STA = 13+940.438  
 N = 47,870.721  
 E = 6,186.635  
 $\Delta = 20^\circ 45' 38''$  (LT)  
 R = 40.000 m  
 T = 7.327 m  
 L = 14.494 m  
 E = 0.666 m

SECTION	COUNTY	TOTAL SHEETS	SHEET NO.
02-00090-00-BT	DUPAGE	117	26
STA. TO STA.			
IDOT PROJECT NO. M-8003(222)			
SALT CREEK GREENWAY TRAIL			

CONTRACT NO. 83713

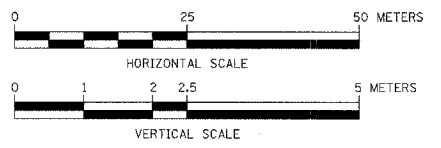
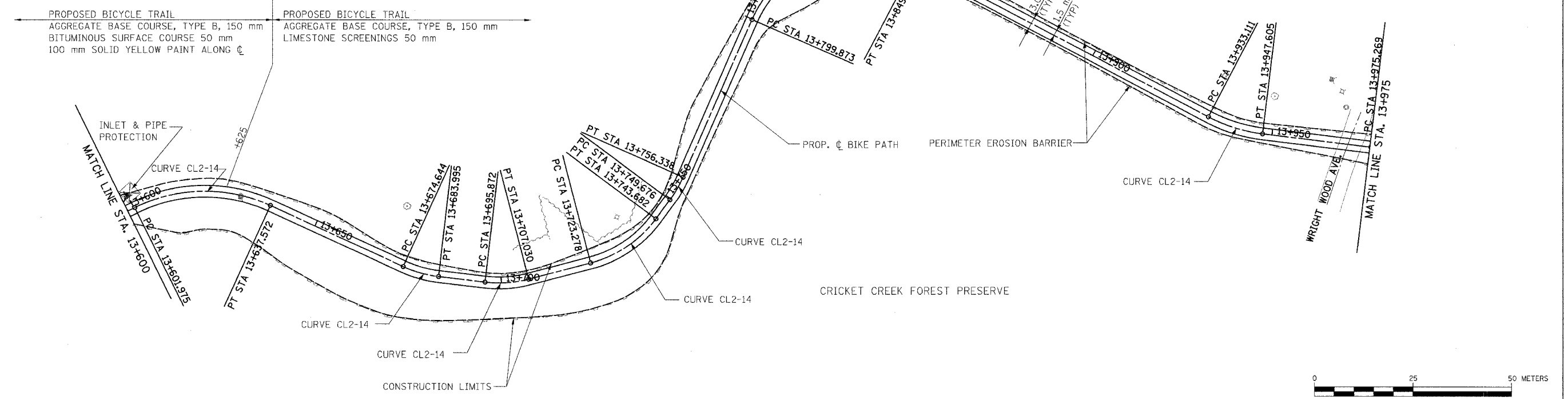

FOR LEGEND SEE SHEET NO. 14

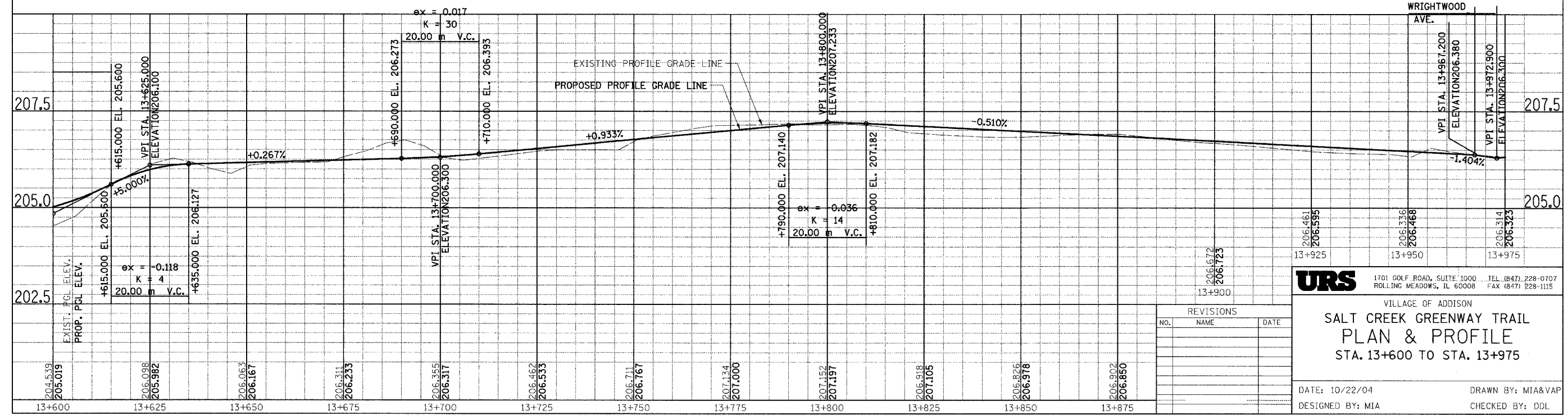

REVISIONS		
NO.	NAME	DATE

**URS** 1701 GOLF ROAD, SUITE 1000 TEL (847) 228-0707  
 ROLLING MEADOWS, IL 60008 FAX (847) 228-1115

VILLAGE OF ADDISON  
**SALT CREEK GREENWAY TRAIL**  
**PLAN & PROFILE**  
 STA. 13+600 TO STA. 13+975

DATE: 10/22/04  
 DESIGNED BY: MIA  
 DRAWN BY: MIA&VAP  
 CHECKED BY: DDL