

FAU	SECTION	COUNTY	TOTAL SHEETS	SHEET NO.
2667	02-00165-00-RP	DUPAGE	87	15
STA.	102+49	TO STA.	110+98.1	
	200+62.05		201+50	
FED. ROAD DIST. NO. 7 ILLINOIS FED. AID PROJECT				
CONTRACT NO. 83768				

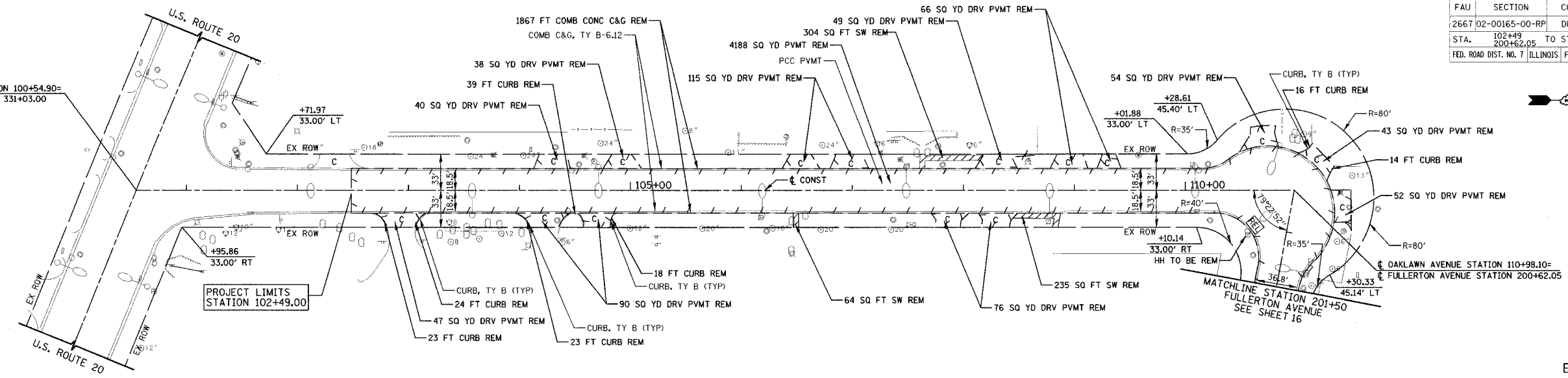

EXISTING VIEW

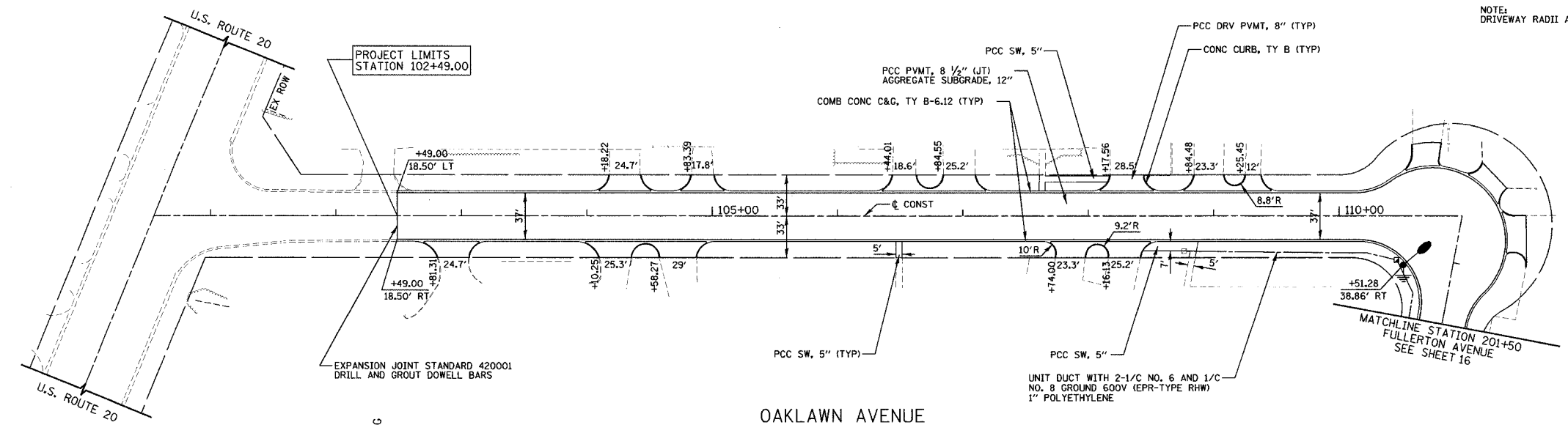

PROPOSED VIEW

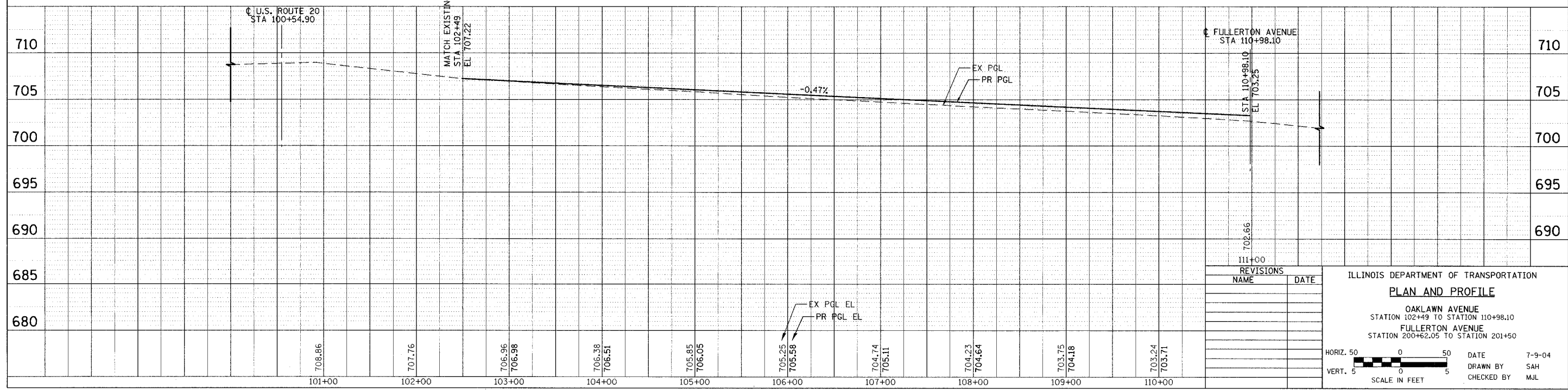

REVISIONS	
NAME	DATE

ILLINOIS DEPARTMENT OF TRANSPORTATION

PLAN AND PROFILE

OAKLAWN AVENUE
STATION 102+49 TO STATION 110+98.10
FULLERTON AVENUE
STATION 200+62.05 TO STATION 201+50

HORIZ. 50 0 50
VERT. 5 0 5
SCALE IN FEET

DATE 7-9-04
DRAWN BY SAH
CHECKED BY MJL

DATE	BY
DATE	BY
DATE	BY

DATE	BY
DATE	BY
DATE	BY

