

FAU	SECTION	COUNTY	TOTAL SHEETS	SHEET NO.
2667	02-00165-00-RP	DUPAGE	87	34
STA.	TO STA.			
32+00	46+50			
FED. ROAD DIST. NO. 7 [ILLINOIS] FED. AID PROJECT				
CONTRACT NO. 83768				

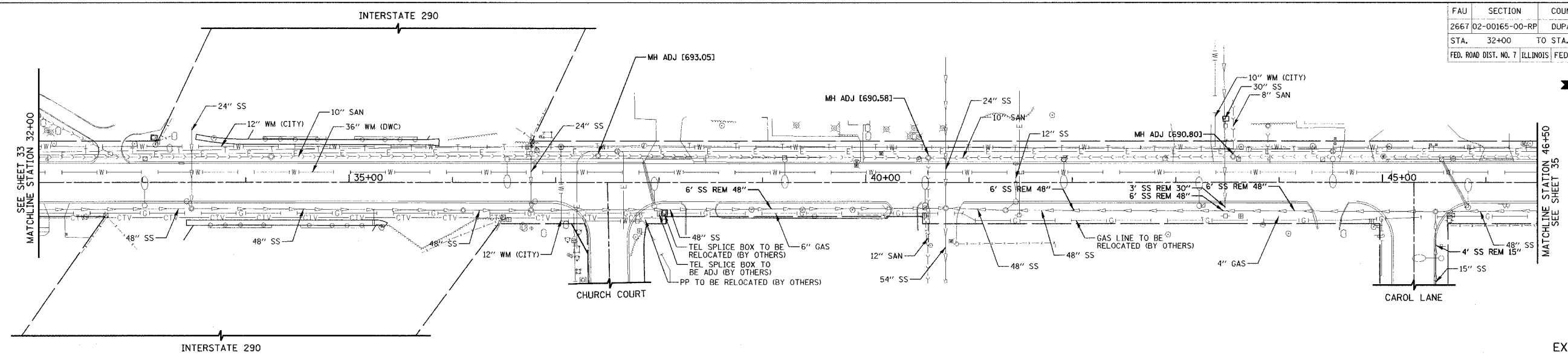

EXISTING VIEW

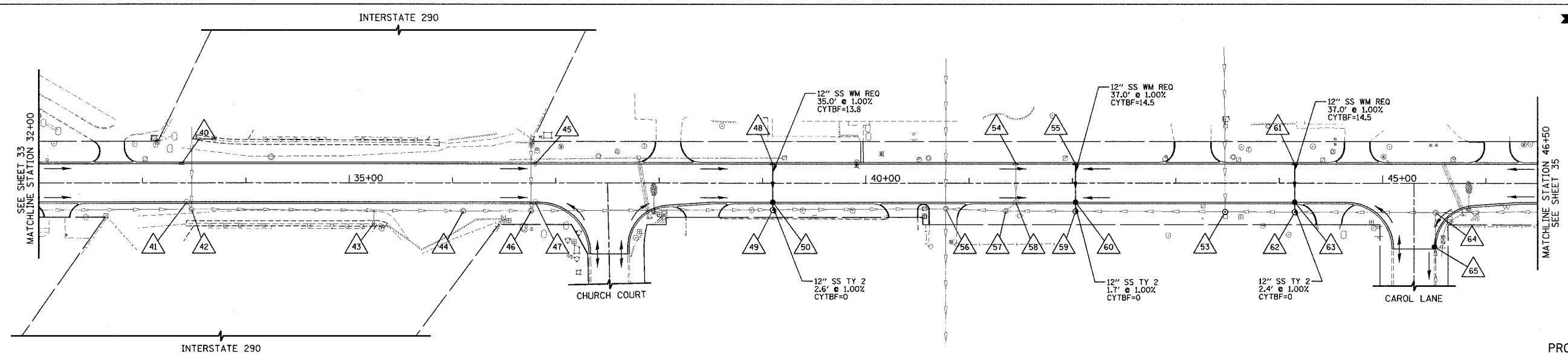

PROPOSED VIEW

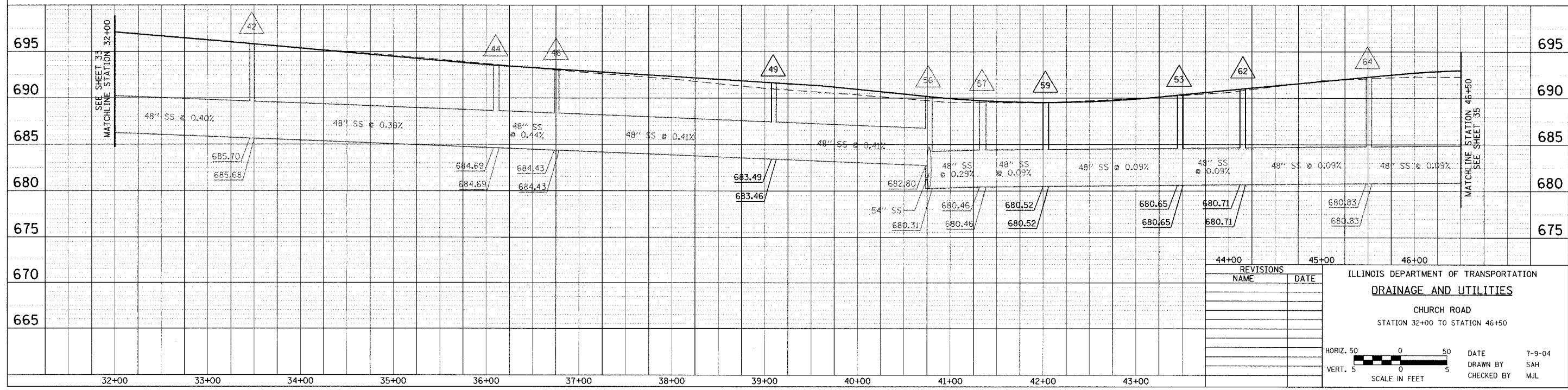

REVISIONS	
NAME	DATE

ILLINOIS DEPARTMENT OF TRANSPORTATION  
**DRAINAGE AND UTILITIES**  
 CHURCH ROAD  
 STATION 32+00 TO STATION 46+50

HORIZ. 50 0 50  
 VERT. 5 0 5  
 SCALE IN FEET

DATE 7-9-04  
 DRAWN BY SAH  
 CHECKED BY MJL

DATE: \_\_\_\_\_  
 BY: \_\_\_\_\_  
 CHECKED: \_\_\_\_\_  
 APPROVED: \_\_\_\_\_  
 NOTE BOOK NO. \_\_\_\_\_  
 DRAWING FILE NAME: \_\_\_\_\_

DATE: \_\_\_\_\_  
 BY: \_\_\_\_\_  
 CHECKED: \_\_\_\_\_  
 APPROVED: \_\_\_\_\_  
 NOTE BOOK NO. \_\_\_\_\_  
 DRAWING FILE NAME: \_\_\_\_\_

