

| | | | | |
|---------------------|----------------|------------------|------------------|-----------|
| F.A.U. RTE. | SECTION | COUNTY | TOTAL SHEETS | SHEET NO. |
| 2652 | 00-00069-00-PV | DUPAGE | 146 | 21 |
| STA. 10+70.70 | | TO STA. 66+16.00 | | |
| FED. ROAD DIST. NO. | | ILLINOIS | FED. AID PROJECT | |
| CONTRACT NO. 83781 | | | | |

| | | | |
|------|----------------|----|------|
| PLAN | SURVEYED | BY | DATE |
| | ALIGNED | | |
| | CHECKED | | |
| | BY | | |
| | NOTE BOOK NO. | | |
| | PAID FILE NAME | | |

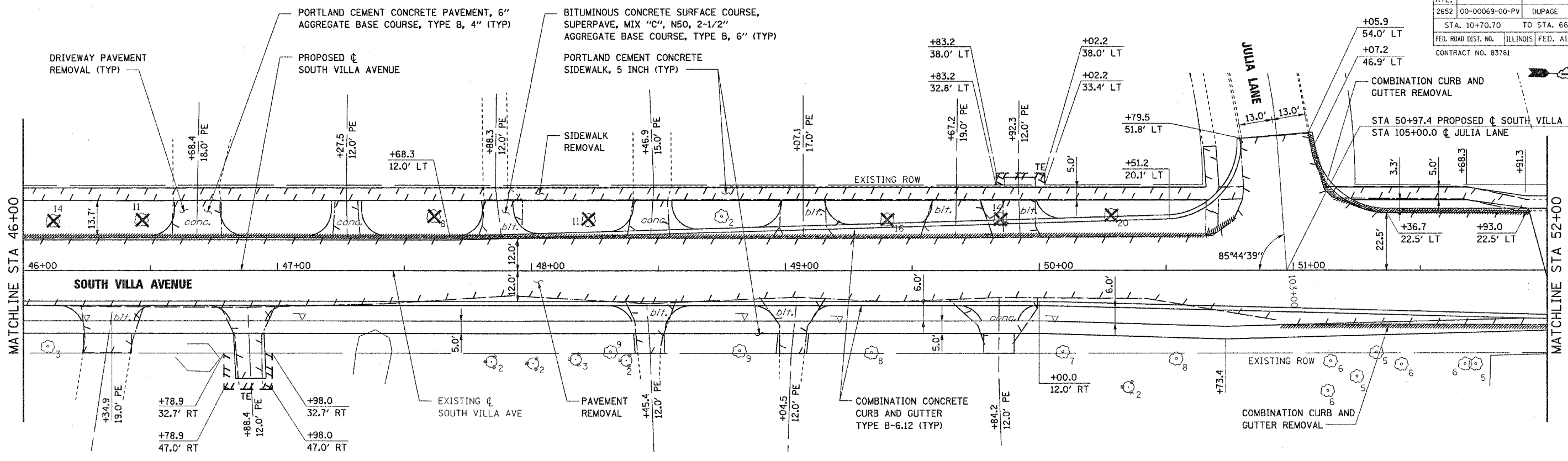

NOTE:
 ALL PROPOSED ENTRANCES TO BE REPLACED IN KIND.
 AGGREGATE ENTRANCES TO BE REPLACED WITH BITUMINOUS MATERIALS

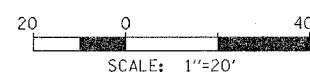

| | | | |
|---------|-------------------------|----|------|
| PROFILE | SURVEYED | BY | DATE |
| | GRADES | | |
| | CHECKED | | |
| | BY | | |
| | NOTE BOOK NO. | | |
| | STRUCTURE NOTATING CARD | | |

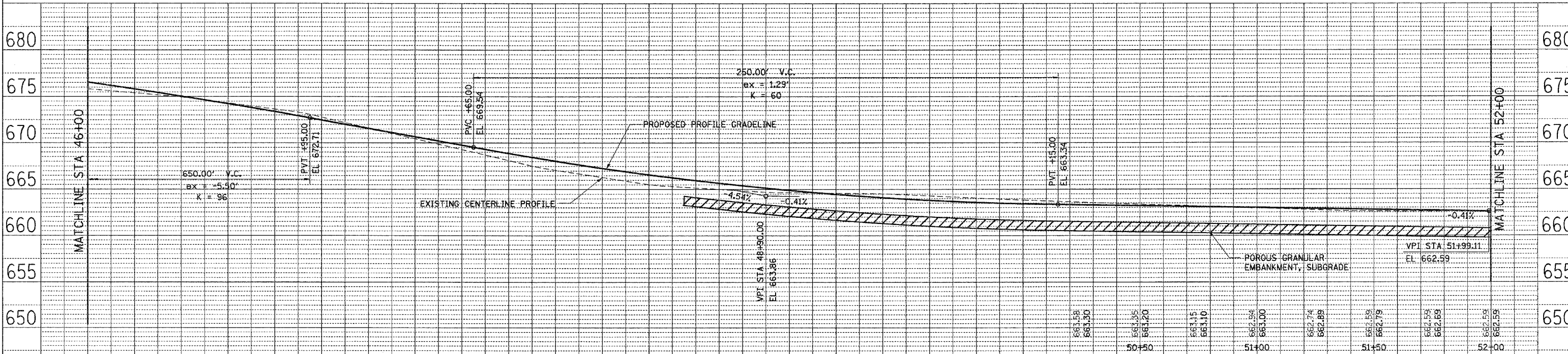

| STATION | EXIST. ELEV. | PROP. ELEV. |
|---------|--------------|-------------|
| 46+00 | 675.83 | 676.56 |
| | 675.28 | 675.64 |
| | 674.64 | 674.65 |
| 47+00 | 673.80 | 673.60 |
| | 672.77 | 672.49 |
| | 671.31 | 671.35 |
| 47+50 | 669.85 | 670.22 |
| | 668.39 | 669.09 |
| | 667.08 | 668.05 |
| 48+00 | 666.09 | 667.11 |
| | 665.30 | 666.27 |
| 48+50 | 664.92 | 665.54 |
| | 664.63 | 664.91 |
| 49+00 | 664.56 | 664.38 |
| | 664.41 | 663.96 |
| 49+50 | 664.11 | 663.64 |
| | 663.83 | 663.42 |
| 50+00 | 663.58 | 663.30 |
| | 663.35 | 663.20 |
| | 663.15 | 663.10 |
| | 662.94 | 663.00 |
| | 662.74 | 662.89 |
| | 662.59 | 662.79 |
| | 662.59 | 662.69 |
| | 662.59 | 662.59 |
| 51+00 | 662.59 | 662.59 |
| 52+00 | 662.59 | 662.59 |



| REVISIONS | |
|-----------|------|
| NAME | DATE |
| | |
| | |
| | |
| | |
| | |

VILLAGE OF VILLA PARK, ILLINOIS
PLAN AND PROFILE
SOUTH VILLA AVENUE
 SHEET 7 OF 10
 STA 46+00 TO STA 52+00

SCALE: HORIZ: 1"=20'
 VERT: 1"=5'
 DATE: 11-NOV-2004

DRAWN BY: E.D.
 CHECKED BY: J.T.G.