

F.A.U. RTE.	SECTION	COUNTY	TOTAL SHEETS	SHEET NO.
2652	00-00069-00-PV	DUPAGE	146	25
STA. 10+70.70		TO STA. 66+16.00		
FED. ROAD DIST. NO.	ILLINOIS	FED. AID PROJECT		
CONTRACT NO. 83781				

SUGGESTED MAINTENANCE OF TRAFFIC

1. TRAFFIC CONTROL AND PROTECTION SHALL BE PERFORMED IN ACCORDANCE WITH THE TRAFFIC CONTROL PLAN AND SECTION 701 OF THE IDOT STANDARD SPECIFICATION AS AMENDED BY THE SPECIAL PROVISION FOR CONSTRUCTION ZONE TRAFFIC CONTROL (CHECK SHEET LRS 3).
2. THE TYPE III BARRICADES ARE TO BE PLACED IN ACCORDANCE WITH STANDARD 702001 UNLESS AUTHORIZED BY THE ENGINEER TO USE AN ALTERNATE ARRANGEMENT.
3. EXISTING TRAFFIC CONTROL SIGNS AND DEVICES WILL BE REMOVED BY THE VILLAGE OF VILLA PARK AFTER THE TRAFFIC CONTROL REQUIREMENTS ARE MET OR AS AUTHORIZED BY THE ENGINEER; ANY SIGNS OR DEVICES LEFT IN PLACE AT THIS TIME ARE TO BE RELOCATED. MAINTAINED AND PROTECTED FROM DAMAGE BY THE CONTRACTOR AND ANY DAMAGED OR LOST SIGNS WILL BE REPLACED BY THE CONTRACTOR.
4. TYPE I OR TYPE II BARRICADES, DRUMS, OR VERTICAL PANELS WITH MONODIRECTIONAL STEADY-BURN LIGHTS SHALL BE REQUIRED ALONG TEMPORARY ROADS, DETOURS, AND SIDE STREETS TO DELINEATE THE TRAVELED WAY WITHIN THE CONSTRUCTION ZONE. THE MAXIMUM SPACING FOR THESE DEVICES SHALL BE 100 FEET CENTER TO CENTER.
5. ANY DROP OFF GREATER THAN THREE (3) INCHES BUT LESS THAN SIX (6) INCHES, WITHIN EIGHT (8) FEET OF THE PAVEMENT EDGE, SHALL BE PROTECTED BY TYPE I OR TYPE II BARRICADES, DRUMS OR VERTICAL PANELS WITH MONODIRECTIONAL STEADY BURN LIGHTS AT 100 FOOT CENTER TO CENTER SPACING. IF THE DROP OFF WITHIN EIGHT (8) FEET OF THE PAVEMENT EDGE EXCEEDS SIX (6) INCHES, THE BARRICADES, DRUMS OR VERTICAL PANELS MENTIONED ABOVE SHALL BE PLACED AT FIFTY (50) FOOT CENTER TO CENTER SPACING. BARRICADES THAT MUST BE PLACED IN EXCAVATED AREAS SHALL HAVE LEG EXTENSION INSTALLED SUCH THAT THE TOP OF THE BARRICADE IS IN COMPLIANCE WITH THE HEIGHT REQUIREMENTS OF STANDARD 702001.
6. TYPE I OR TYPE II BARRICADES WITH TWO-WAY FLASHING LIGHTS SHALL BE REQUIRED AT ALL OPEN TRENCHES, EXCAVATIONS, OPEN OR EXPOSED SEWER STRUCTURES, TRANSVERSE PAVEMENT JOINTS, MATERIALS OR EQUIPMENT WITHIN THE RIGHT-OF-WAY (NUMBER AND SPACING DEPENDS ON THE CONDITIONS); AND AT LOCATIONS DESIGNATED BY THE ENGINEER OR LOCAL LAW ENFORCEMENT AGENCIES.
7. TYPE I, II, AND / OR III BARRICADES WITH TWO-WAY FLASHING LIGHTS WILL BE REQUIRED TO GUIDE TRAFFIC AWAY FROM PAVEMENT AREAS CLOSED FOR CONSTRUCTION.
8. THE COST OF SUPPLYING, ERECTING, AND MAINTAINING BARRICADES, WARNING LIGHTS, AND SIGNS WILL BE INCLUDED IN THE CONTRACT LUMP SUM PRICE FOR TRAFFIC CONTROL AND PROTECTION (SPECIAL).
9. WHERE REQUIRED, TRAFFIC SIGNS SHALL BE RELOCATED FOR EACH STAGE OF CONSTRUCTION.
10. ARROW BOARDS WILL BE REQUIRED WHEN IMPLEMENTING ALL LANE CLOSURES.
11. PRIOR TO THE START OF CONSTRUCTION, REQUIRED TRAFFIC CONTROL DEVICES SHALL BE IN PLACE.
12. THE ATTACHED IS THE CONSTRUCTION STAGING FOR THIS PROJECT. THE PURPOSE OF THIS STAGING IS TO MINIMIZE DELAYS TO THE MOTORIST. THE CONTRACTOR MAY ALTER THE SEQUENCE OF CONSTRUCTION WITH THE PRIOR APPROVAL OF THE ENGINEER.
13. ACCESS TO ALBRIGHT SCHOOL SHALL BE PROVIDED AT ALL TIMES WHEN SCHOOL IS IN SESSION.
14. THE PERMANENT BASE COURSE PAVEMENT AT THE SCHOOL BUS DROP OFF AREA SHALL BE PROVIDED FOR ALBRIGHT SCHOOL DURING PERIODS WHEN THE SCHOOL IS IN SESSION DURING STAGE 2.
15. STORM SEWER MAIN SHALL BE CONSTRUCTED ON LEFT SIDE OF VILLA AVENUE IN WIDENING AND PRE STAGE PHASE.

1. INSTALL TRAFFIC CONTROL DEVICES.
2. DETOUR EXISTING TRAFFIC AS SHOWN ON THE DETOUR PLAN. CONSTRUCT TEMPORARY PAVEMENT.
3. INSTALL TEMPORARY EROSION CONTROL MEASURES AND CONSTRUCT LEFT SIDE STORM SEWER.
4. REMOVE EXISTING PAVEMENT ON RIGHT SIDE OF CENTERLINE.
5. MAINTAIN EXISTING LOCAL SOUTHBOUND TRAFFIC.
6. CONSTRUCT PROPOSED RIGHT SIDE STORM SEWERS.
7. CONSTRUCT PROPOSED NORTHBOUND PAVEMENT (EXCLUDING SURFACE COURSE), CURB AND GUTTER, AND SIDEWALK.
8. MAINTAIN TEMPORARY EROSION CONTROL MEASURES.

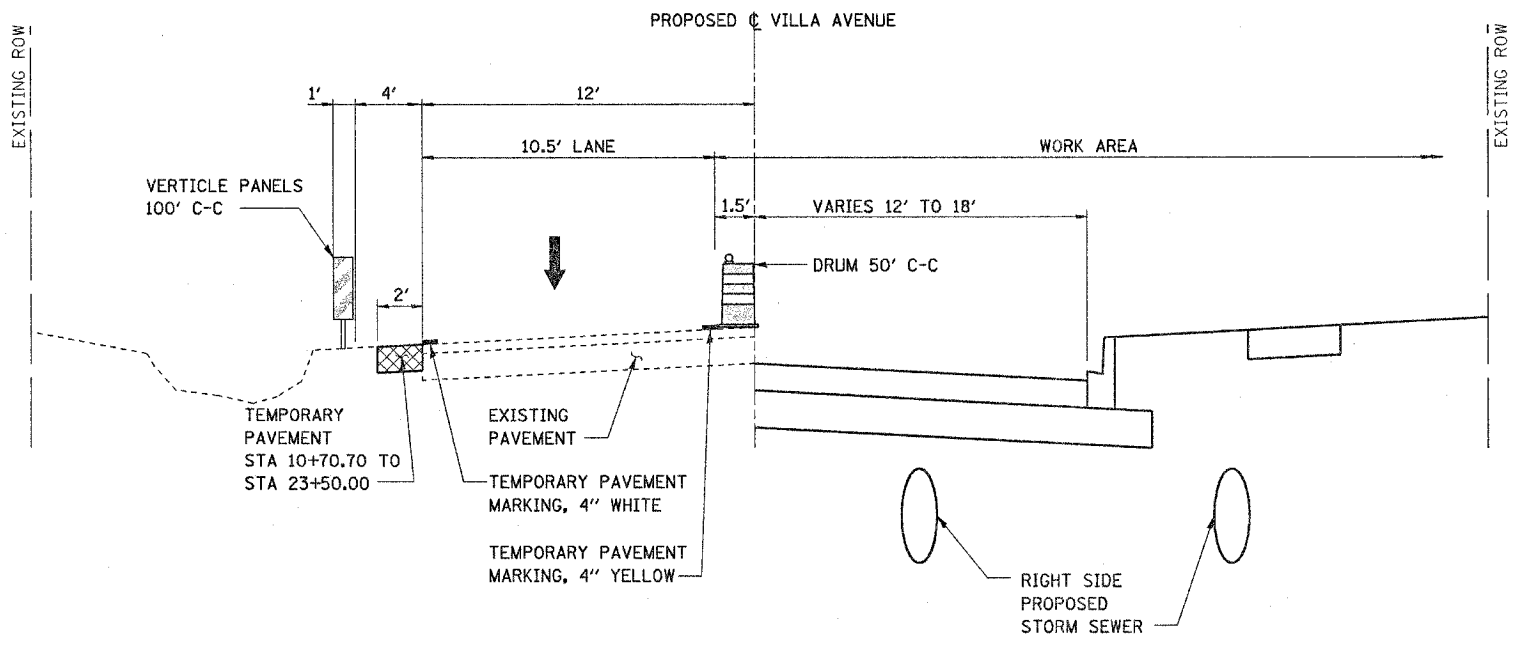

STAGE 1: ILLINOIS ROUTE 38 (ROOSEVELT ROAD) TO HARRISON STREET

STA 10+70.70 TO STA 36+83.00

1. INSTALL TRAFFIC CONTROL DEVICES.
2. DETOUR EXISTING TRAFFIC AS SHOWN ON THE DETOUR PLAN.
3. INSTALL TEMPORARY EROSION CONTROL MEASURES AND CONSTRUCT LEFT SIDE STORM SEWER.
4. REMOVE EXISTING PAVEMENT ON RIGHT SIDE OF CENTERLINE.
5. MAINTAIN EXISTING LOCAL SOUTHBOUND TRAFFIC.
6. CONSTRUCT PROPOSED RIGHT SIDE STORM SEWERS.
7. CONSTRUCT PROPOSED NORTHBOUND PAVEMENT (EXCLUDING SURFACE COURSE), CURB AND GUTTER, AND SIDEWALK.
8. MAINTAIN TEMPORARY EROSION CONTROL MEASURES.

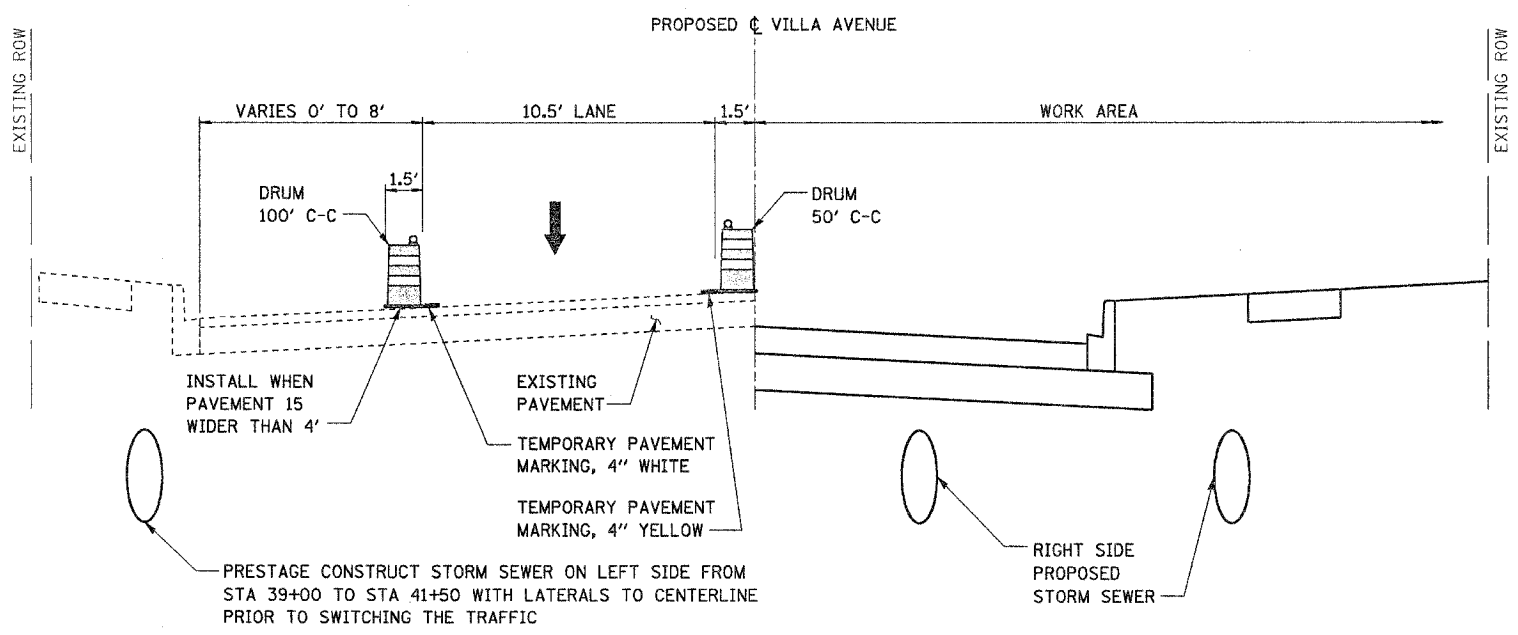

STAGE 1: HARRISON STREET TO MADISON STREET

STA 36+83.00 TO STA 63+00.00

REVISIONS	
NAME	DATE

Stanley Consultants INC.
 850 West Higgins Road
 Suite 730
 Chicago, Illinois 60638-2801 Illinois Firm Registration No. 04-00533

VILLAGE OF VILLA PARK, ILLINOIS

**SUGGESTED MAINTENANCE OF TRAFFIC
 TYPICAL SECTIONS
 SOUTH VILLA AVENUE
 SHEET 1 OF 10**

SCALE: NONE DRAWN BY: E.D.
 DATE: 11-NOV-2004 CHECKED BY: J.T.G.

DATE	
BY	
PLAN	
NO.	
DATE	
BY	
DATE	
BY	
DATE	
BY	

DATE	
BY	
DATE	
BY	
DATE	
BY	
DATE	
BY	
DATE	
BY	