

F.A.U. RTE.	SECTION	COUNTY	TOTAL SHEETS	SHEET NO.
2652	00-00069-00-PV	DUPAGE	146	27
STA. 10+70.70		TO STA. 66+16.00		
FED. ROAD DIST. NO.		ILLINOIS FED. AID PROJECT		
CONTRACT NO. 83781				

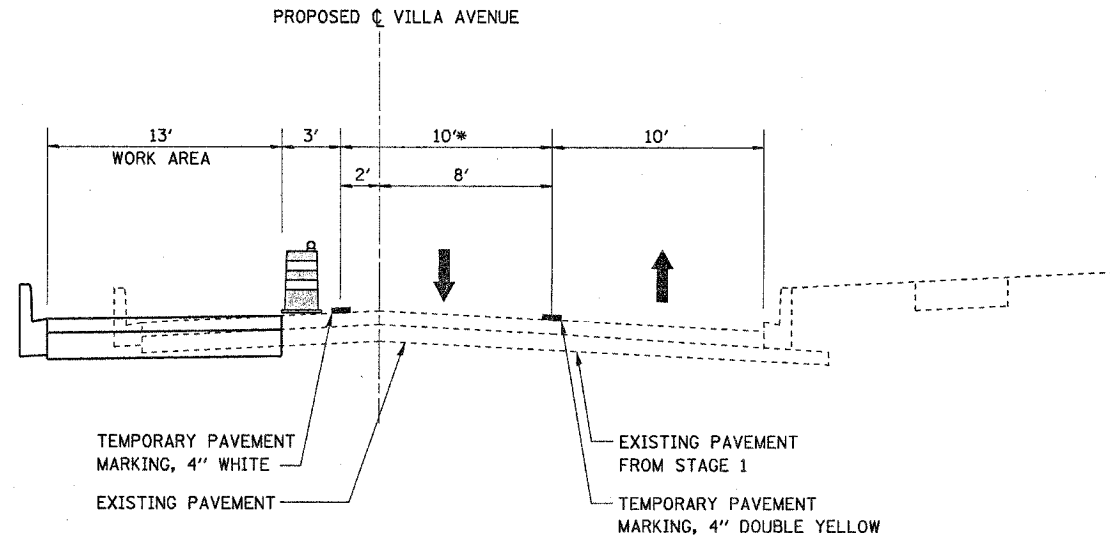

STAGE 2: MADISON STREET TO NORTH OF MADISON STREET

STA 63+00.00 TO STA 66+16.00

NOTE:

* CENTER PAVEMENT TO BE CONSTRUCTED IN SUBSTAGES.

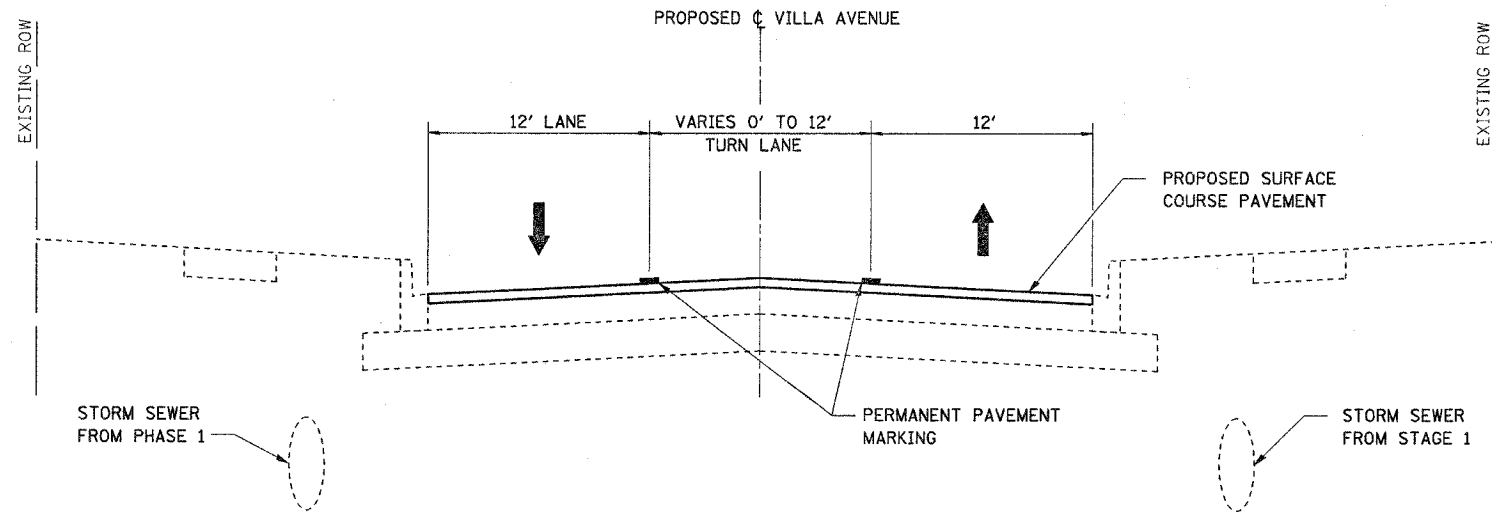

STAGE 3: ROOSEVELT ROAD TO NORTH OF MADISON STREET

STA 10+70.70 TO STA 66+16.00

1. COMPLETE PERMANENT LANDSCAPING AND REMOVE TEMPORARY EROSION CONTROL DEVICES.
2. PLACE SURFACE COURSE AND MAINTAIN TRAFFIC IN BOTH DIRECTIONS.
3. PLACE PERMANENT PAVEMENT MARKING AND SIGNING.



REVISIONS	
NAME	DATE

VILLAGE OF VILLA PARK, ILLINOIS
SUGGESTED MAINTENANCE OF TRAFFIC TYPICAL SECTIONS
SOUTH VILLA AVENUE
SHEET 3 OF 10

SCALE: NONE
DATE: 11-NOV-2004
DRAWN BY: E.D.
CHECKED BY: J.T.G.

DATE	
BY	
REVISIONS	
PLANNED	
ALIGNED	
CHECKED	
DATE	
FILE NAME	
NO.	

DATE	
BY	
REVISIONS	
PROFILE	
PLANNED	
CHECKED	
DATE	
FILE NAME	
NO.	