

F.A.U. RTE.	SECTION	COUNTY	TOTAL SHEETS	SHEET NO.
2652	00-00069-00-PV	DUPAGE	146	73
STA. 10+70.70		TO STA. 66+16.00		
FED. ROAD DIST. NO.	ILLINOIS	FED. AID PROJECT		
CONTRACT NO. 83781				

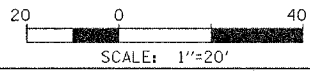

LEGEND:

- | | |
|--|---|
| ① 4" WHITE, POLYUREA PAVEMENT MARKING LINE | ⑤ WHITE, LETTERS, PREFORMED POLYUREA PAVEMENT MARKING |
| ② 4" DOUBLE YELLOW, POLYUREA PAVEMENT MARKING LINE | ⑥ 24" WHITE, POLYUREA PAVEMENT MARKING LINE |
| ③ 12" YELLOW @ 45° SKEW, 30 FT C-C, POLYUREA PAVEMENT MARKING LINE | ⑦ 6" WHITE, POLYUREA PAVEMENT MARKING LINE |
| ④ WHITE, TURN ARROW SYMBOL, PREFORMED POLYUREA PAVEMENT MARKING | ⑧ 4" SINGLE YELLOW, POLYUREA PAVEMENT MARKING LINE |

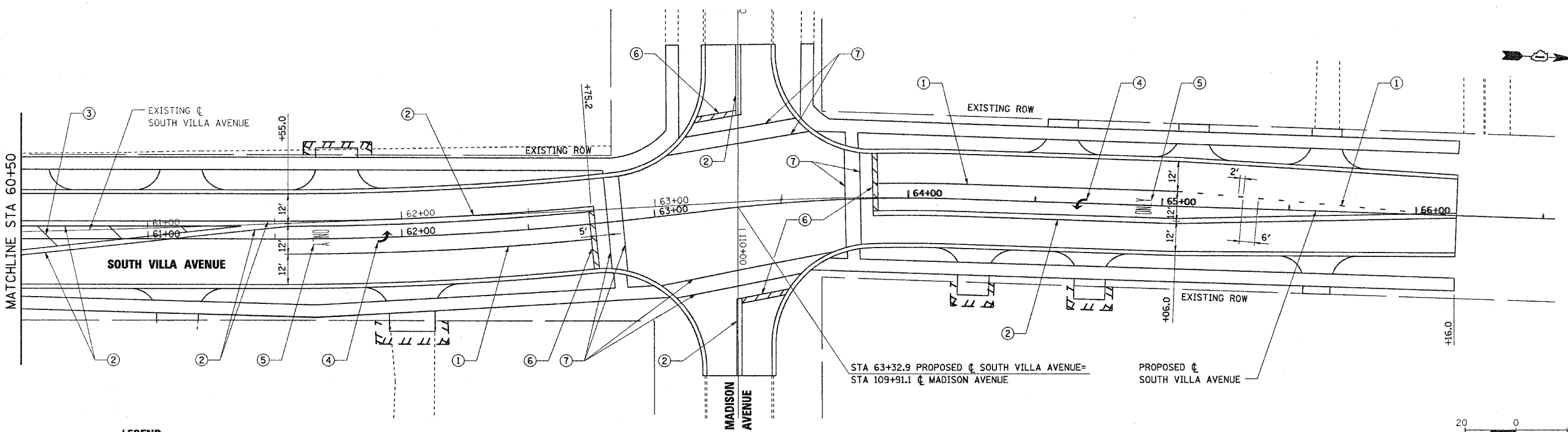
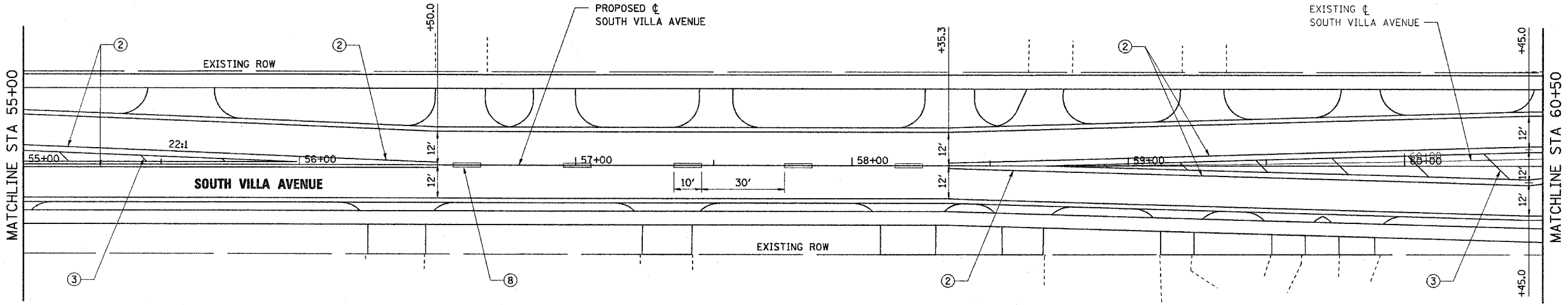

REVISIONS	
NAME	DATE

VILLAGE OF VILLA PARK, ILLINOIS

**PAVEMENT MARKING
SOUTH VILLA AVENUE
SHEET 5 OF 5**

STA 55+00 TO STA 66+16

SCALE: 1"=20'

DATE: 11-NOV-2004

DRAWN BY: E.D.
CHECKED BY: J.T.G.

DATE	
BY	
PLAN	
NO. OF SHEETS	
NO. OF SHEETS CHECKED	
NO. OF SHEETS NOT CHECKED	
NO. OF SHEETS PAID FOR	
NO. OF SHEETS PAID FOR	

DATE	
BY	
PROFILE	
NO. OF SHEETS	
NO. OF SHEETS CHECKED	
NO. OF SHEETS NOT CHECKED	
NO. OF SHEETS PAID FOR	
NO. OF SHEETS PAID FOR	