

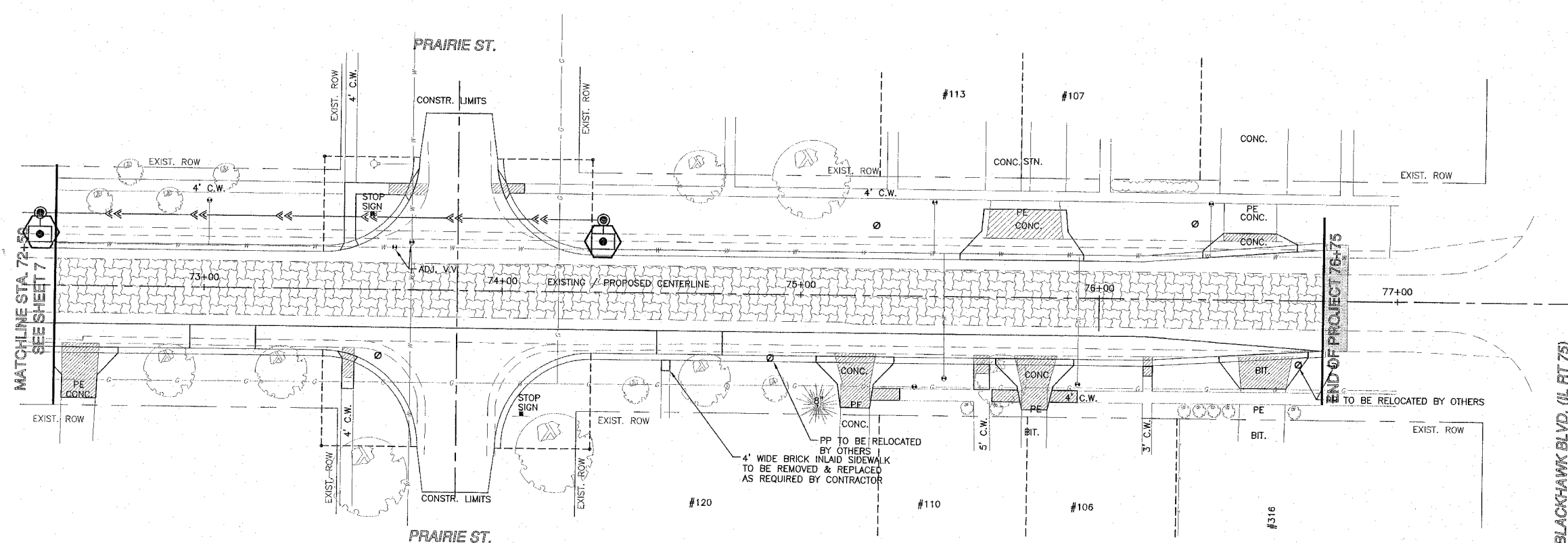

RTE.	SECTION	COUNTY	TOTAL SHEETS	SHEET NO.
FAU 9878	93-00027-00-FP	WINNEBAGO	22	22
F.H.W.A. REG	ILLINOIS	PROJECT:	M-5291	(8)

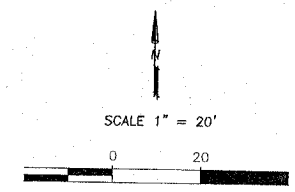



BENCH MARK:  
TBM #5 - FIRE HYDRANT--  
LETTER "R" IN CORY  
STA. 73+57, 42' LT  
ELEV: 741.59

BENCH MARK:  
TBM #6 - FIRE HYDRANT--  
LETTER "O" IN OPEN  
STA. 77+11, 29' LT  
ELEV: 744.84

NOTE:  
ALL COMB. CURB & GUTTER  
WILL BE TYPE B6.18.  
ALL PROPOSED RADII ARE 30'  
FLAG OF CURB.

-  BITUMINOUS SURFACE REMOVAL
-  BITUMINOUS MATERIAL REMOVAL (BUIT JOINT)

**LEGEND**

-  INLET / PIPE PROTECTION
-  PERIMETER EROSION BARRIER - SILT FILTER FENCE
-  EXCELSIOR LOS DITCH CHECK



<b>CES INC.</b> CIVIL ENGINEERING SERVICES 700 WEST LOCUST ST., BELLEVILLE, IL 61008 (815)-547-8433 FAX: (815)-544-0421	
<b>UNION STREET</b>	
DRAWN BY PC	DATE 10/26/04
CHECKED BY KCB	DATE 10/26/04
<b>SHEET 22</b>	
FILE: SHEET22.DWG	