

RT#	SECTION	COUNTY	TOTAL SHEETS	SHEET NO.
F.A.I. 80	(50-2)HBR	LA SALLE	460	106
STA. 0+00		TO STA. 11+68.78		
FED. ROAD DIST. NO.		ILLINOIS FED. AID PROJECT		

CONTRACT NO. 86603

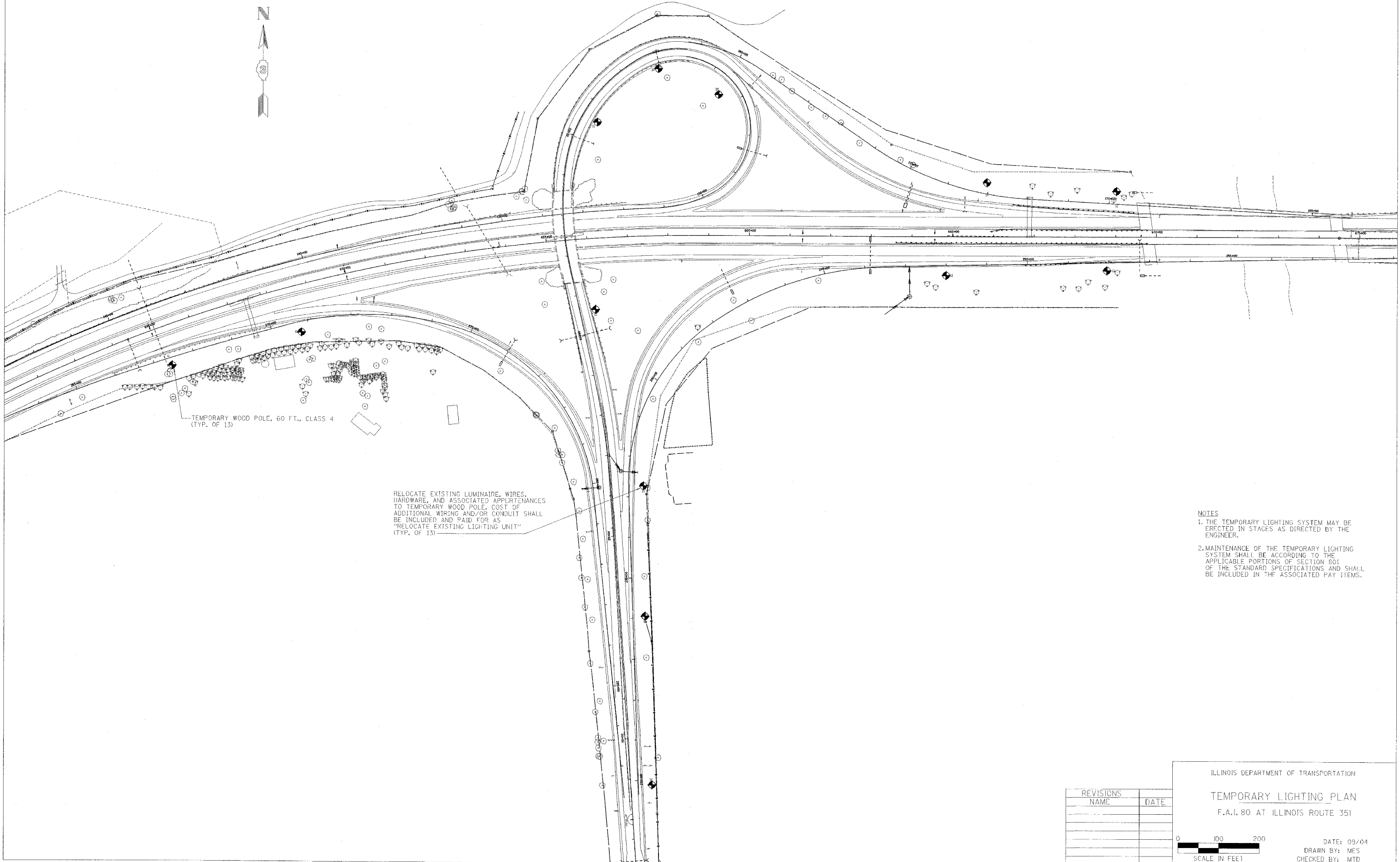

TEMPORARY WOOD POLE, 60 FT., CLASS 4
(TYP. OF 13)

RELOCATE EXISTING LUMINAIRE, WIRES,
HARDWARE, AND ASSOCIATED APPURTENANCES
TO TEMPORARY WOOD POLE. COST OF
ADDITIONAL WIRING AND/OR CONDUIT SHALL
BE INCLUDED AND PAID FOR AS
"RELOCATE EXISTING LIGHTING UNIT"
(TYP. OF 13)

- NOTES**
1. THE TEMPORARY LIGHTING SYSTEM MAY BE ERECTED IN STAGES AS DIRECTED BY THE ENGINEER.
 2. MAINTENANCE OF THE TEMPORARY LIGHTING SYSTEM SHALL BE ACCORDING TO THE APPLICABLE PORTIONS OF SECTION 801 OF THE STANDARD SPECIFICATIONS AND SHALL BE INCLUDED IN THE ASSOCIATED PAY ITEMS.

REVISIONS	NAME	DATE

ILLINOIS DEPARTMENT OF TRANSPORTATION

TEMPORARY LIGHTING PLAN

F.A.I. 80 AT ILLINOIS ROUTE 351

DATE: 09/04
DRAWN BY: MES
CHECKED BY: MTD

0 100 200
SCALE IN FEET