

ROUTE NO.	SECTION	COUNTY	DATE	SHEET
F.A.S. 1464	03-00028-03-BR	TAZEWELL	15	3
FED. ROAD DIST. NO.	ILLINOIS	FED. AID PROJECT		

CONTRACT NO. 89346

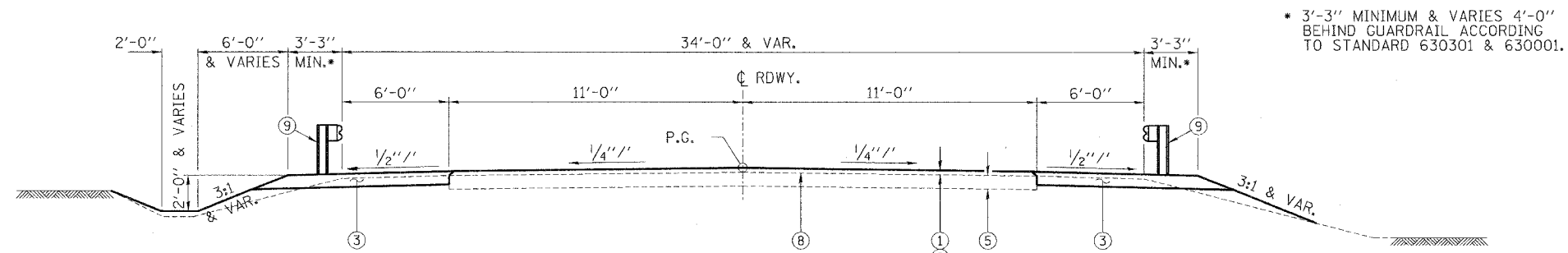

\* 3'-3" MINIMUM & VARIES 4'-0" BEHIND GUARDRAIL ACCORDING TO STANDARD 630301 & 630001.

SUGGESTED CUT SECTION CONSTRUCT AS SHOWN IN STATION CROSS SECTIONS

**TYPICAL CROSS SECTION**

STA. 8+00.00 TO STA. 9+23.75  
 STA. 10+76.25 TO STA. 12+00  
 TRANSITION FROM EXISTING SHOULDERS TO PROPOSED SHOULDERS IS TO BE CONSTRUCTED FROM STA. 8+00 TO STA. 8+50 AND FROM STA. 11+50 TO STA. 12+00.

SUGGESTED FILL SECTION CONSTRUCT AS SHOWN IN STATION CROSS SECTIONS

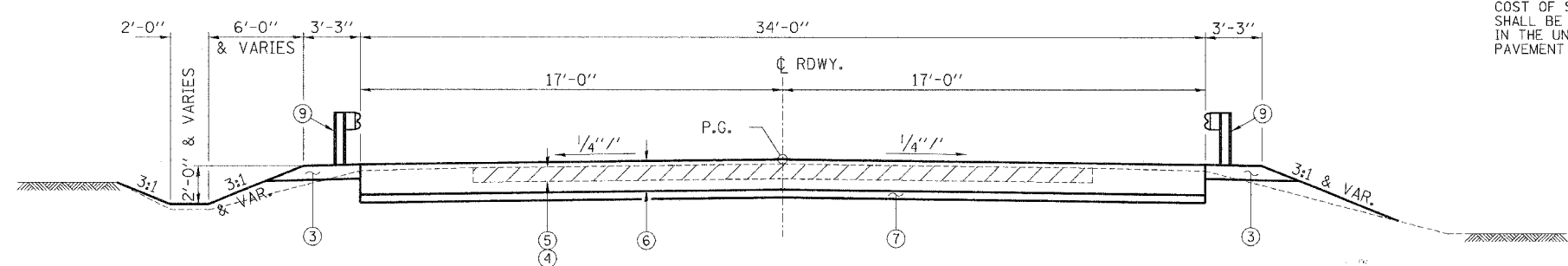

SUGGESTED CUT SECTION CONSTRUCT AS SHOWN IN STATION CROSS SECTIONS

**TYPICAL CROSS SECTION AT BRIDGE APPROACH PAVEMENT**

STA. 9+23.75 TO STA. 9+53.75  
 STA. 10+46.25 TO STA. 10+76.25

SUGGESTED FILL SECTION CONSTRUCT AS SHOWN IN STATION CROSS SECTIONS

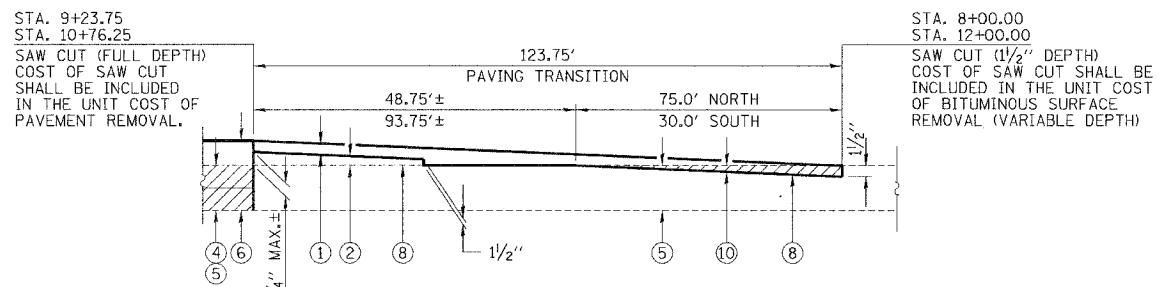

STA. 9+23.75  
 STA. 10+76.25  
 SAW CUT (FULL DEPTH) COST OF SAW CUT SHALL BE INCLUDED IN THE UNIT COST OF PAVEMENT REMOVAL.

STA. 8+00.00  
 STA. 12+00.00  
 SAW CUT (1 1/2" DEPTH) COST OF SAW CUT SHALL BE INCLUDED IN THE UNIT COST OF BITUMINOUS SURFACE REMOVAL (VARIABLE DEPTH)

**PAVEMENT TRANSITION DETAIL**

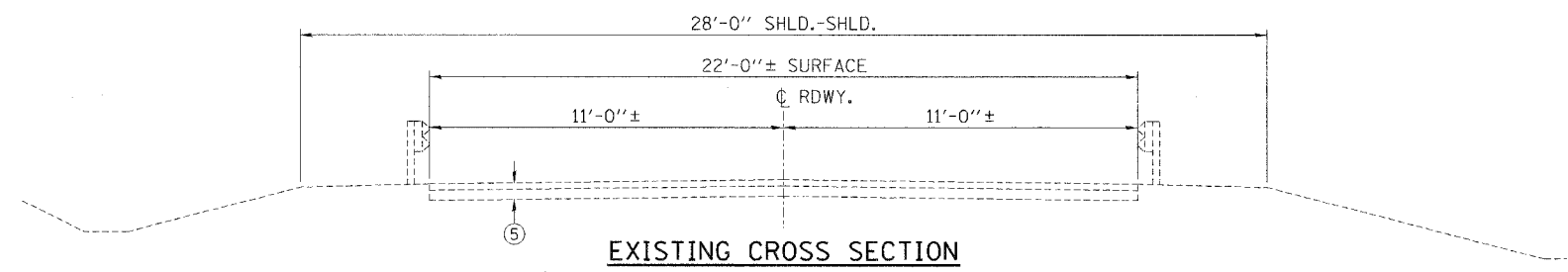

**EXISTING CROSS SECTION**

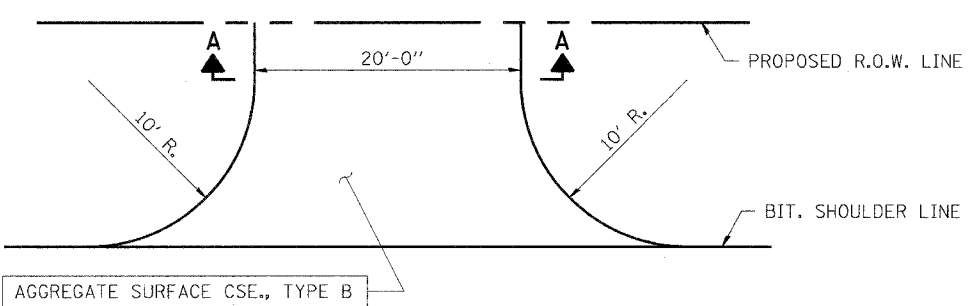

**FIELD ENTRANCE DETAIL**

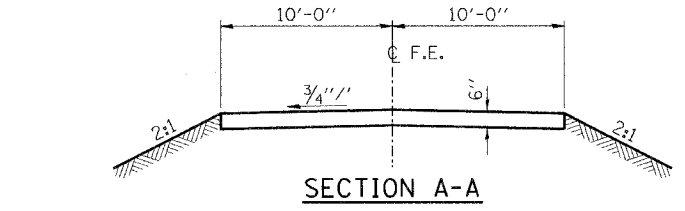

**SECTION A-A**

**LEGEND**

- ① POLYMERIZED BITUMINOUS CONCRETE, SURFACE COURSE, SUPERPAVE, MIX "D" N50 (1 1/2" THICKNESS)
- ② BITUMINOUS CONCRETE BINDER COURSE, SUPERPAVE, IL-19.0, N50 (3/4" & VARIES)
- ③ AGGREGATE SHOULDERS, TYPE B, (6" THICKNESS)
- ④ PAVEMENT REMOVAL
- ⑤ EXISTING BITUMINOUS PAVEMENT ON AGGREGATE BASE (12" BIT., 19" AGG.)
- ⑥ BRIDGE APPROACH PAVEMENT
- ⑦ SUB-BASE GRANULAR MATERIAL (SEE STANDARD 420401. (INCIDENTAL TO BRIDGE APPROACH PAVEMENT.))
- ⑧ BITUMINOUS MATERIALS (PRIME COAT)
- ⑨ STEEL PLATE BEAM GUARD RAIL / TRAF. BAR. TERM.
- ⑩ BITUMINOUS SURFACE REMOVAL (VARIABLE DEPTH)

**HLR**  
 Rice, Berry and Associates  
 A Division of Hampton, Lenzini and Renwick, Inc.  
 Civil & Structural Engineers  
 801 S. Durkin Drive  
 Springfield, Illinois 62704  
 217-546-3400  
 P.O. Box 1036  
 DuQuoin, Illinois 62832  
 618-790-4637  
 Account Number 12-91-0012-1  
 Date: 08/04/04  
 DESIGNED: T.P.L. CHECKED: S.W.M. DRAWN: D.B.

**TYPICAL CROSS SECTIONS**  
 F.A.S. 1464 / C.H. 2 / DELAVAN ROAD  
 SECTION 03-00028-03-BR  
 TAZEWELL COUNTY