

F.A.P. RTE.	SECTION	COUNTY	TOTAL SHEETS	SHEET NO.
828	12BR-2	CUMBERLAND	32	22
STA. 11+724.930		TO STA.		
FED. ROAD DIST. NO. 5		ILLINOIS FED. AID PROJECT		

90920

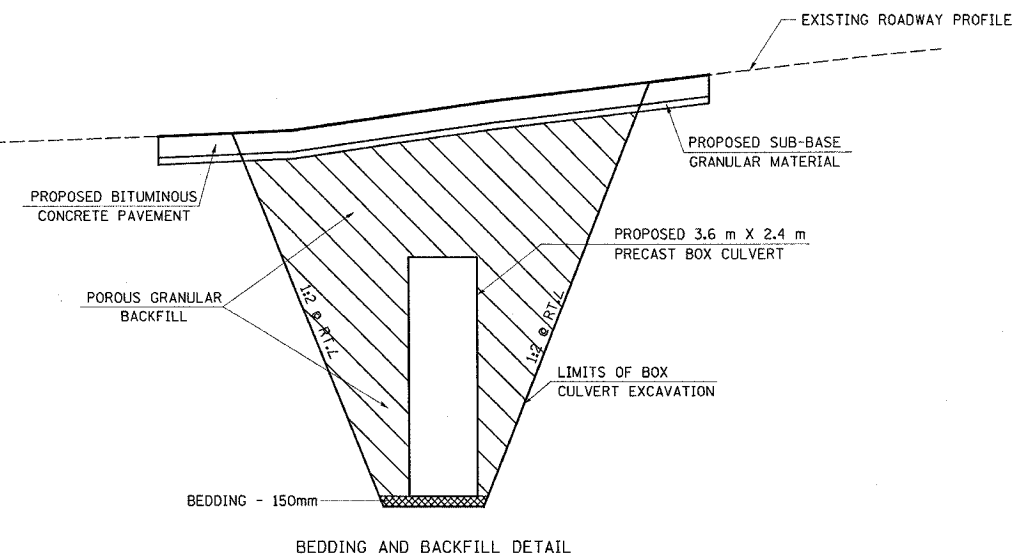
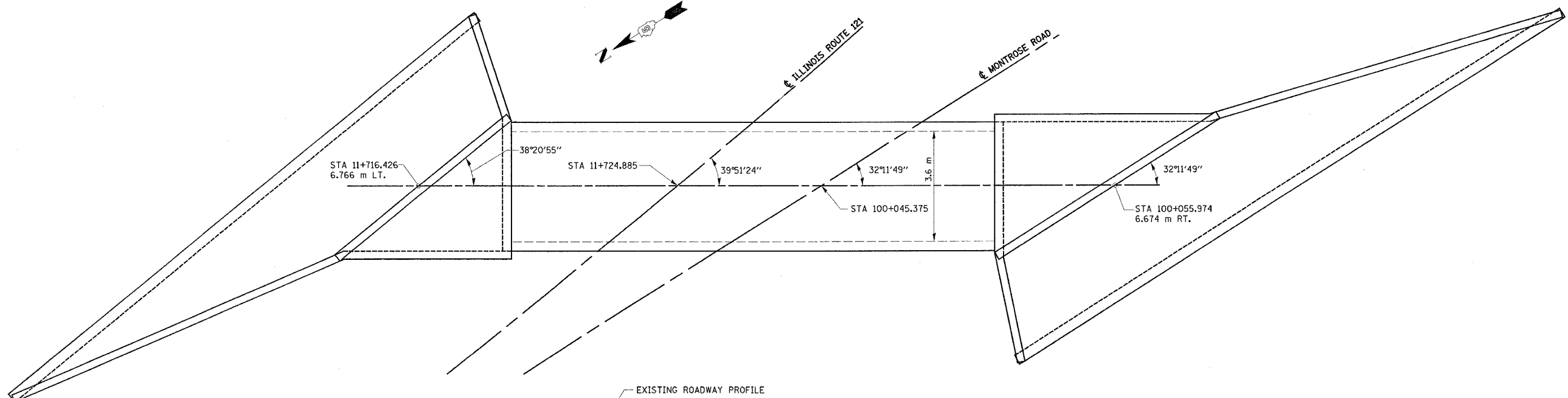
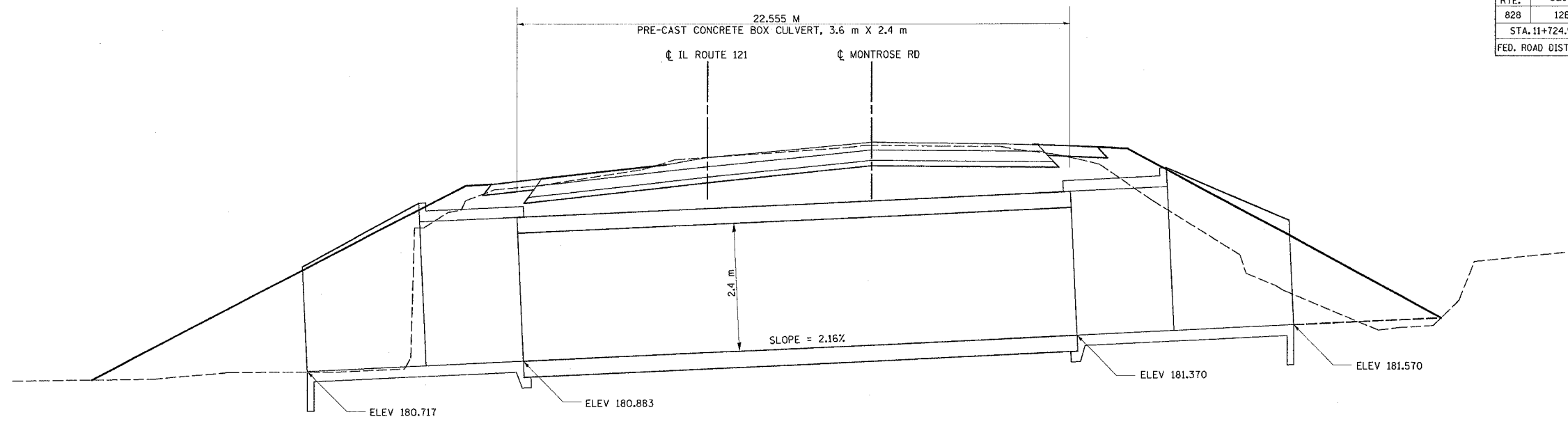

REVISIONS	
NAME	DATE

ILLINOIS DEPARTMENT OF TRANSPORTATION  
**BOX CULVERT DETAIL**  
 FAP 828 (MONTROSE RD.)  
 CUMBERLAND COUNTY  
 STATION 11+724.930  
 DRAWN BY BANDY  
 CHECKED BY STEUART  
 DATE