

SECTION	COUNTY	TOTAL SHEETS	SHEET NO.
99-00352-00-BT	CHAMPAIGN	38	31
STA.	TO STA.		
F.H.W.A. REG.	ILLINOIS PROJECT	TE-0005(76)	

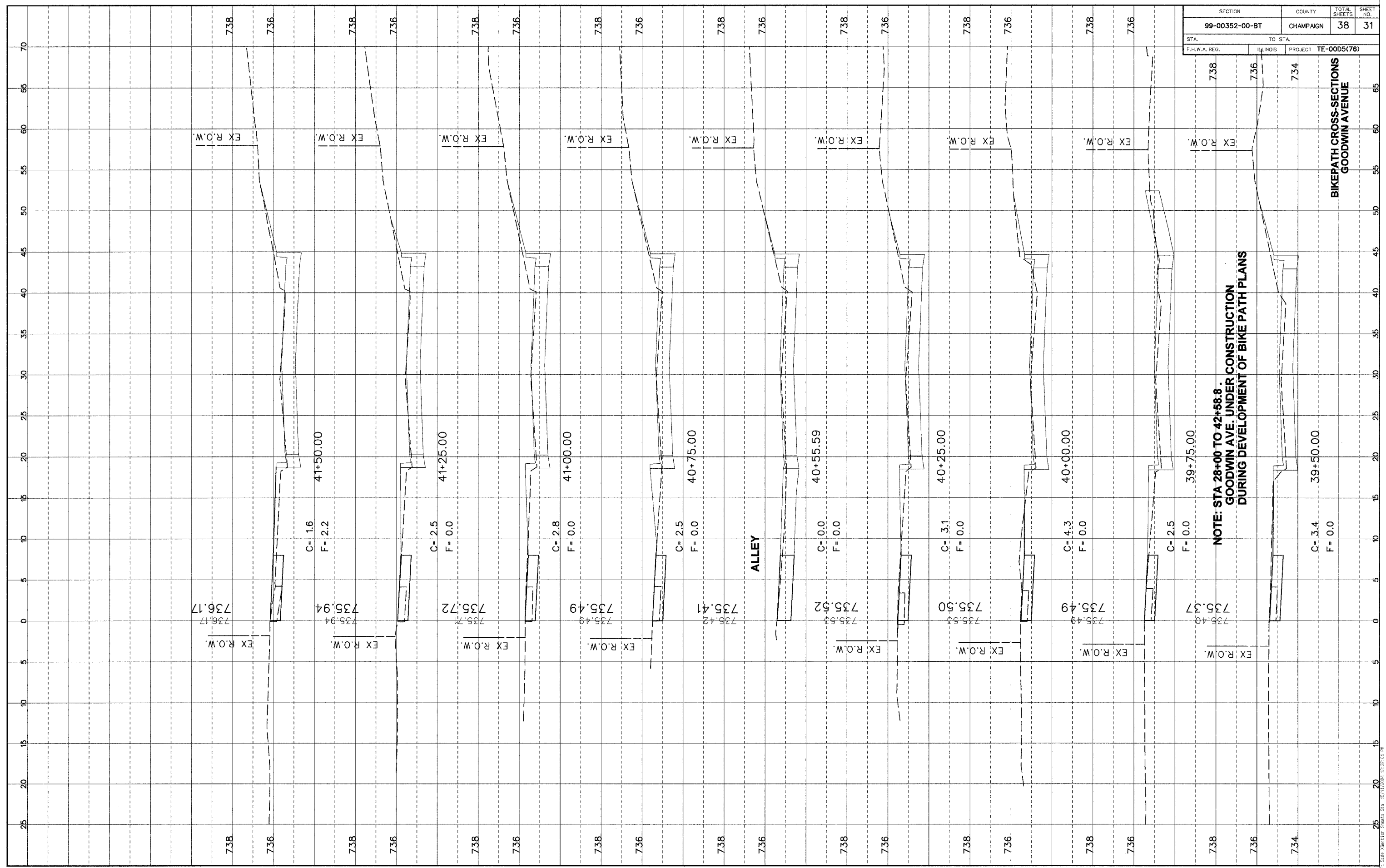

**NOTE: STA 28+00 TO 42+58.8.
GOODWIN AVE. UNDER CONSTRUCTION
DURING DEVELOPMENT OF BIKE PATH PLANS**

**BIKEPATH CROSS-SECTIONS
GOODWIN AVENUE**